

Date Thursday, 7 June 2018

Venue Royal Hall, RIHGA Royal Hotel Hiroshima

2018 Japan-Taiwan University Presidents' Forum in HIROSHIMA

Enhancement of Educational and Research Collaboration
Corresponding to the Globalization of Society

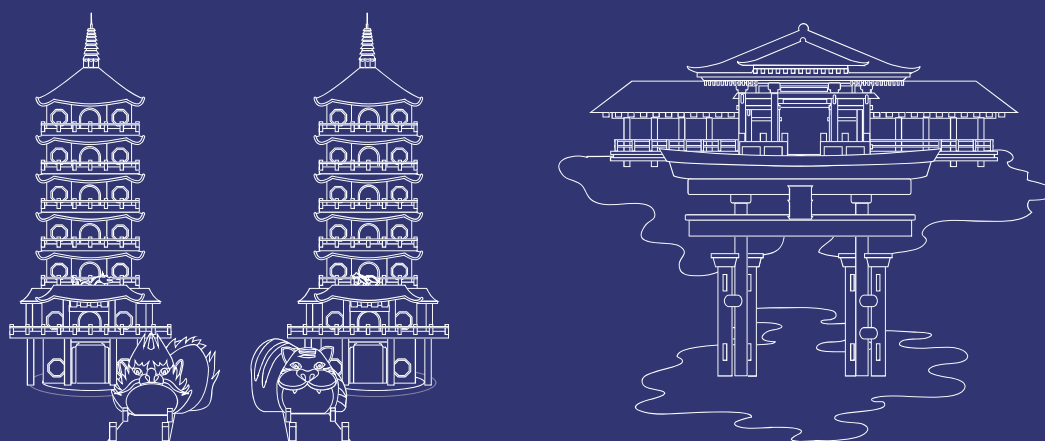

Organizer

The Japan Committee of Universities for International Exchange (JACUIE)

Joint Organizer

Foundation for International Cooperation in Higher Education of Taiwan (FICHET)

Host University

Hiroshima University

Support Organizations

Japan-Taiwan Exchange Association

Taipei Economic and Cultural Representative Office in Japan



HIROSHIMA UNIVERSITY



CONTENTS

Program	3
 Opening Remarks	7
Dr. Kyosuke Nagata.....	9
Dr. Huey-Jen Jenny Su	10
Dr. Mitsuo Ochi	11
Dr. Leeh- Ter Yao.....	12
Mr. Michi Kakizawa	13
Mr. Jen-Joe Chang	14
 Session 1	15
Chair (Moderator):	
Dr. Edward H. Chow	17
1-1 Presenters:	
Prof. Yuichi Hasebe	18
Dr. Tei-Wei Kuo	19
1-2 Presenters:	
Mr. Andy Cheu-An Bi	20
Mr. Hideki Yonekawa	21
 Session 2	23
Chair (Moderator):	
Dr. Atsushi Hamana.....	25
2-1 Presenters:	
Dr. Mariko Kobayashi.....	26
Dr. Lu-Sheng Hong	27
2-2 Presenters:	
Dr. Yoshizane Maeda	28
Dr. Bing-Jean Lee	29

Session 3	31
Chair (Moderator):	
Dr. Fuh-Sheng Shieu	33
Presenters:	
Dr. Flora Chia-I Chang	34
Dr. Yasunao Hattori	35
 Session 4	 37
Chair (Moderator):	
Dr. Tetsuo Asano	39
Presenters:	
Dr. Yoshiyuki Kakehi	40
Dr. Chieh-Hsi Wu	41
 Closing Remarks	 43
Dr. Yuh-Long Oliver Su.....	45
Rev. Noriaki Nagao	46
 Participating Organization	 47
Taiwan Side	47
Japan Side.....	48
 University Introduction	 51
Taiwan Side	51
Japan Side / National Universities.....	69
Public Universities	87
Private Universities.....	90
 Organizers	 103

2018 Japan-Taiwan University Presidents' Forum

Date: 7 June 2018 (Thursday)

Venue: Royal Hall, RIHGA Royal Hotel Hiroshima

6-78 Motomachi, Naka-ku, Hiroshima 730-0011, Japan

<http://www.rihga.com/hiroshima>

Theme: Enhancement of Education and Research Collaboration Corresponding to the Globalization of Society

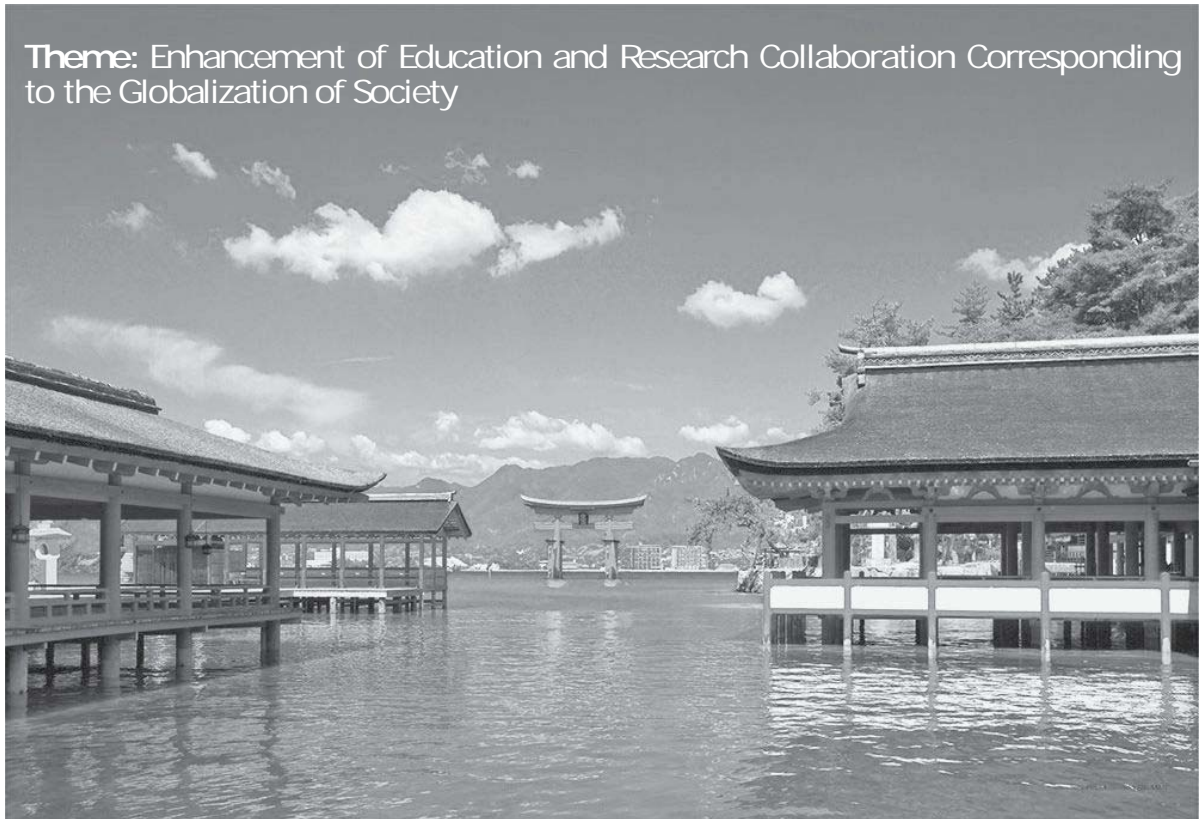

Organizer: The Japan Committee of Universities for International Exchange (JACUIE)

Joint Organizer: Foundation for International Cooperation in Higher Education of Taiwan (FICHET)

Host University: Hiroshima University

Support Organizations: Japan-Taiwan Exchange Association

Taipei Economic and Cultural Representative Office in Japan

MC of the Forum: Dr. Taiji Hotta, Vice-Executive (Deputy Vice-President) of International Planning, Hiroshima University

Language: English

Program

Time	Duration	Agenda
9:00-9:30	30 min.	Registration
9:30-9:50	20 min.	Opening Remarks 1. Dr. Kyosuke Nagata , Chairperson of JACUIE and President of University of Tsukuba 2. Dr. Huey-Jen Jenny Su , Chairperson of FICHET and President of National Cheng Kung University 3. Dr. Mitsuo Ochi , President of Hiroshima University (Host University) 4. Dr. Leeh-Ter Yao , Political Deputy Minister, Ministry of Education 5. Mr. Michi Kakizawa , Director-General, General Affairs Department, Japan - Taiwan Exchange Association 6. Mr. Jen-Joe Chang , Deputy Representative, Taipei Economic and Cultural Representative Office in Japan
Session 1: Introductory Session - Educational Aspects: Enhancement of International Education and International Student Mobility in Response to the Globalization		
9:50-10:20	30 min.	1-1 Enhancement of Double Degree Programs or Joint Degree Programs between Universities in Japan and Taiwan Introductory Presentations <i>Chair (Moderator):</i> Dr. Edward H. Chow , President, National Chengchi University <i>Presenters:</i> 1. Prof. Yuichi Hasebe , President, Yokohama National University 2. Dr. Tei-Wei Kuo , Interim President, National Taiwan University
10:20-10:50	30 min.	1-2 Enhancement of International Student Exchange Programs between Universities in Japan and Taiwan Introductory Presentations <i>Chair (Moderator):</i> Dr. Edward H. Chow , President, National Chengchi University <i>Presenters:</i> 1. Mr. Andy Cheu-An Bi , Director General, Department of International and Cross-Strait Education, Ministry of Education 2. Mr. Hideki Yonekawa , Vice President, Japan Student Services Organization (JASSO)
10:50-11:00	10 min.	Group Photography
11:00-11:20	20 min.	Networking Coffee Break

Session 2: Introductory Session - Research Aspects: Enhancement of International Research Exchange and Industry-University Collaboration for Innovation		
11:20-11:50	30 min.	<p>2-1 Enhancement of Young Researcher Exchanges between Universities in Japan and Taiwan</p> <p>Introductory Presentations</p> <p><i>Chair (Moderator):</i></p> <p>Dr. Atsushi Hamana, President, Kansai University of International Studies</p> <p><i>Presenters:</i></p> <ol style="list-style-type: none"> Dr. Mariko Kobayashi, Governing Director, Headquarters for International Affairs, Japan Society for the Promotion of Science (JSPS) Dr. Lu-Sheng Hong, Director, Science and Technology Division, Taipei Economic and Cultural Representative Office in Japan
11:50-12:20	30 min.	<p>2-2 Enhancement of Industry-University Collaboration Research Projects for Universities in Japan and Taiwan</p> <p>Introductory Presentations</p> <p><i>Chair (Moderator):</i></p> <p>Dr. Atsushi Hamana, President, Kansai University of International Studies</p> <p><i>Presenters:</i></p> <ol style="list-style-type: none"> Dr. Yoshizane Maeda, President, Kagoshima University Dr. Bing-Jean Lee, President, Feng Chia University
12:20-13:30	70 min.	Lunch
Session 3: Plenary Session (Educational Aspects)		
13:30-14:40	70 min.	<p>Presentations</p> <p><i>Chair (Moderator):</i></p> <p>Dr. Fuh-Sheng Shieu, President, National Chung Hsing University</p> <p><i>Presenters:</i></p> <ol style="list-style-type: none"> Dr. Flora Chia-I Chang, President, Tamkang University Dr. Yasunao Hattori, President, Shimane University <p>Discussion</p>
14:40-15:00	20 min.	Networking Coffee Break

Session 4: Plenary Session (Research Aspects)		
15:00-16:10	70 min.	Presentations <i>Chair (Moderator):</i> Dr. Tetsuo Asano , President, Japan Advanced Institute of Science and Technology <i>Presenters:</i> 1. Dr. Yoshiyuki Kakehi , President, Kagawa University 2. Dr. Chieh-Hsi Wu , Vice President, Taipei Medical University Discussion
Session 5: Joint Statement between JACUIE and FICHET and Closing		
16:10-16:30	20 min.	Joint Statement Adoption Dr. Kyosuke Nagata , Chairperson of JACUIE and President of University of Tsukuba Dr. Huey-Jen Jenny Su , Chairperson of FICHET and President of National Cheng Kung University
16:30-16:40	10 min.	Closing Remarks 1. Dr. Yuh-Long Oliver Su , President, National Chi Nan University 2. Rev. Noriaki Nagao , President, Tenri University
18:00-20:00	120 min.	Dinner Banquet

Dinner Banquet

Date: Thursday, 7 June 2018, 18:00-20:00

Venue: Royal Hall 1, RIHGA Royal Hotel Hiroshima

Participants: All participants

Culture Tour (Optional)

Date: Friday, 8 June 2018

*Only for Taiwan participants

	Route A (One-Day)	Route B (Half-Day)
9:00	Departure (Meeting Point: Lobby, RIHGA Royal Hotel Hiroshima)	
	Hiroshima Peace Memorial Museum Hiroshima Peace Memorial Park Atomic Bomb Dome	Hiroshima Peace Memorial Museum Hiroshima Peace Memorial Park Atomic Bomb Dome
	Lunch(on-island) Itsukushima Shrine Shopping	Back to the RIHGA Royal Hotel Hiroshima around 10h40AM
16:40	Back to the RIHGA Royal Hotel Hiroshima	

Floor map for 2018 Japan-Taiwan University Presidents' Forum

Date: 7 June 2018 (Thursday)

Venue: 4F RIHGA Royal Hotel Hiroshima

6-78 Motomachi, Naka-ku, Hiroshima 730-0011, Japan

<http://www.rihga.com/hiroshima>

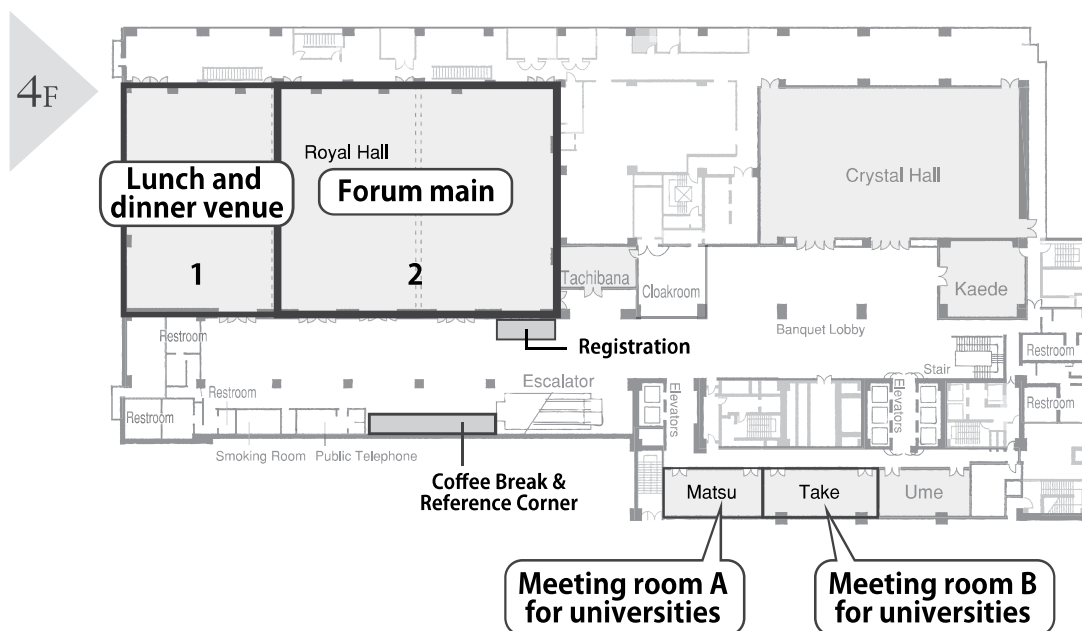

Universities are available these rooms by booking the room in advance.

Wi-Fi Point

ID: RIHGARoyal-Hiroshima-BR

PASS: rihgaroyal

Access Information

From Hiroshima Airport

Limousine bus to "Hiroshima Bus Center", about 55 minutes, then a brief walk to the hotel

From Hiroshima Station

By Streetcar: Board the streetcar bound for Hiroshima Port/Miyajima/Eba

Get off at "Kamiya-cho Higashi (East)" or "Kamiya-cho Nishi (West)"

It's a short walking distance to the hotel

By Bus: Take Hiroshima Bus Route No. 21, 22, 24, or 25, or Koden Bus Route No. 2 or 3 for about 8 minutes. Get off at "Kamiya-cho". It is a short walking distance to the hotel

Opening Remarks

Dr. Kyosuke Nagata

Chairperson of JACUIE and President of University of Tsukuba

Dr. Huey-Jen Jenny Su

Chairperson of FICHET and President of National Cheng Kung University

Dr. Mitsuo Ochi

President of Hiroshima University (Host University)

Dr. Leeh-Ter Yao

Political Deputy Minister, Ministry of Education

Mr. Michi Kakizawa

Director-General, General Affairs Department, Japan - Taiwan Exchange Association

Mr. Jen-Joe Chang

Deputy Representative, Taipei Economic and Cultural Representative Office in Japan

Opening Remarks

Dr. Kyosuke Nagata

Chairperson

Japan Committee of University for International Exchange
(JACUIE)



Biography

Dr. Nagata, current JACUIE Chairperson, has been serving as the President of the University of Tsukuba since April 2013. He earned his Ph.D. in Pharmaceutical Sciences at the University of Tokyo in 1981. He is a fellow of the Japanese Society for Virology, Japanese Cancer Association (JCA), the Japanese Biochemical Society (JBS), the Molecular Biology Society of Japan (MBSJ), the Pharmaceutical Society of Japan, and the American Society for Microbiology. He belongs to the Central Council for Education under the Japanese Ministry of Education, Culture, Sports, Science and Technology (MEXT). He is also the Vice President of the Japan Association of National Universities (JANU) and he serves as the Chairperson of the International Exchange Committee under this association.

Opening Remarks

Dr. Huey-Jen Jenny Su

Chairperson

Foundation for International Cooperation in
Higher Education of Taiwan
(FICHET)



Biography

Dr. Huey-Jen Jenny Su is currently a Distinguished Professor of Environmental Health of the National Cheng Kung University in Taiwan. Trained at the Harvard School of Public Health, Dr. Su has engaged most of her research efforts on the topic of air pollution related health effects, with particular emphasis on the rising global concerns on airborne microbial hazards. She was an expert committee member for preparing the report of “WHO Guidance for Biological Agents in the Indoor Environment”.

Having served as the Vice President for International Affairs of National Cheng Kung University from 2007 to 2011, Dr. Su began to direct her efforts and interests to the subject matter of higher education development and advancement. During the term, she was also appointed as the Executive Secretary for SATU (Southeast and South Asian and Taiwan Universities) Presidents’ Forum, which provides a venue for academics to share their valuable experiences to improve higher education and international cooperation in the region. Starting February 1, 2011, Dr. Su was appointed the Executive Vice President of National Cheng Kung University with primary responsibility of overseeing the strategic development of student affairs, international affairs, university advancement project and coordinating the collaborative projects among universities of TCUS (Taiwan Comprehensive University System). As of February 2015, Dr. Su took the mantle of NCKU President. In July 2015, she was elected as a chairperson of Foundation for International Cooperation in Higher Education of Taiwan. In July 2017, she was elected as chairperson of Association of National Universities of Taiwan.

Introduction to the university/institution

The Foundation for International Cooperation in Higher Education of Taiwan (FICHET) is a non-profit organization founded in 2005. Currently, representing 115 member universities, FICHET has been given the responsibility by the government to function as a platform for international cooperation between Taiwanese and foreign universities. Current operations of the foundation include the planning of international educator assemblies (in Europe, America, and Asia) and fostering human resources in the field of international education administration to enhance communication efficiency between various agents working on these platforms.

Opening Remarks

Dr. Mitsuo Ochi

President

Hiroshima University



Biography

Dr. Mitsuo Ochi assumed a position of the 12th president of Hiroshima University on April 1, 2015. His area of expertise is Orthopedics, Regenerative Medicine, and Sports Medicine.

He was appointed to the Professor and Chairman of the Department of Orthopaedic Surgery at Shimane Medical University in 1995 and at Hiroshima University in 2002. He has received numerous awards and honors in the past including: John J. Joyce Award by The International Arthroscopy Association and the International Society of the Knee, in 1993; the President's Prize of the Science Council of Japan, awarded by the Cabinet Office for contributions to industry-academia-government collaboration, in 2004; the Commendation for Science and Technology by the Minister of Education, Culture, Sports, Science and Technology in 2010; and the Minister of Health, Labour and Welfare award for contributions to industry-academia-government collaboration in 2014. In addition, he was awarded Shiju Hosho (Medal with Purple Ribbon) in 2015.

Opening Remarks

Dr. Leeh-Te Yao

Political Deputy Minister

Ministry of Education, Taiwan, R.O.C.



Education

- ◆ PhD, Department of Electrical and Computer Engineering, University of Wisconsin-Madison, USA – 1992
- ◆ MS, Department of Electrical Engineering, University of Missouri-Rolla, USA - 1987
- ◆ Diploma, Department of Electrical Engineering, National Taipei Institute of Technology, Taiwan - 1982

Current Position

- ◆ Political Deputy Minister, Ministry of Education – 2017
- ◆ Executive Trustee, the Chinese Institute of Electrical Engineering - 2017
- ◆ Member, Ministry of Economic Affairs Industry Professional Development Committee - 2015
- ◆ Trustee, Chinese Institute of Engineers – 2014
- ◆ Board Member, Automotive Research & Testing Center - 2013
- ◆ Trustee, Institute of Engineering Education Taiwan (IEET) - 2011
- ◆ Board Member, FICHET - Foundation for International Cooperation In Board Higher Education of Taiwan - 2011
- ◆ Member, Ministry of Economic Affairs Bureau of Standards, Metrology and Inspection, Electrical Engineering National Standards Technical Committee - 2009
- ◆ Professor, Department of Electrical Engineering, National Taipei University of Technology – 1997

Related Experience

- ◆ Member, Executive Yuan Technical & Vocational Education Council - 2015
- ◆ President, ANUST - Association of National Universities of Science and Technology of Taiwan - 2013
- ◆ Trustee, Association of National Universities of Taiwan - 2012
- ◆ President, National Taipei University of Technology - 2011
- ◆ Director, Ministry of Education Technological & Vocational College Admission Committee Joint Commission - 2011
- ◆ Chairperson, Ministry of Education Technological Colleges & Universities Recruitment Policy Advancement Committee - 2011
- ◆ Board Member, Testing Center for Technological & Vocational Education - 2011
- ◆ Trustee, Institute of Engineering Education Taiwan (IEET) - 2011

Introduction to the institution

The Ministry of Education is part of the Executive Yuan and is responsible for national academic and educational administration, including education policy planning and legislation and supervision of educational matters.

Opening Remarks

Mr. Michi Kakizawa

Director-General
General Affairs Department

Japan-Taiwan Exchange Association



Biography

Mr. Kakizawa have been working for the Ministry of Foreign Affairs of Japan since receiving Master of Law degree from Keio University in 1999. He is currently in charge of handling substantial exchanges between Japan and Taiwan on behalf of the Japanese Government.

2005-2008	Intelligence and Analysis Service, MOFA
2008-2011	Political Section, Embassy of Japan in People's Republic of China
2011-2013	The First China and Mongolia Division, MOFA
2013-2015	Public Policy School, Hokkaido University (as an associate professor)
2015-	Tokyo Headquarter, Japan-Taiwan Exchange Association

Opening Remarks

Mr. Jen-Joe Chang

Deputy Representative

Taipei Economic and Cultural Representative Office in Japan



Biography

Mr. Jen-Joe Chang is the current Deputy Representative of Taipei Economic and Cultural Representative Office (TECRO) in Japan. Mr. Chang received his bachelor's degree in Political Science from National Taiwan University in 1984. In the same year, he passed the Special Civil Service Examination for Consular and Diplomatic Personnel and entered the Ministry of Foreign Affairs in Taiwan. As a professional diplomat, he has been posted to Tokyo, Osaka, and Washington D.C for several years since 1991. He was appointed as the Director of Deputy Secretary-General Office, National Security-General Office in Taiwan from 2013, before his post as the Secretary General of the Association of East Asia Relations (AEAR) in 2015. He then relocated to Osaka to take the office as the Director General of Taipei Economic and Cultural Office (TECO) in Osaka in January, 2016, before his current position at TECRO in Japan from September, 2016.

Session 1

Introductory Session - Educational Aspects: Enhancement of International Education and International Student Mobility in Response to the Globalization

1-1 Enhancement of Double Degree Programs or Joint Degree Programs between Universities in Japan and Taiwan

Chair (Moderator):

Dr. Edward H. Chow

President, National Chengchi University

Presenters:

Prof. Yuichi Hasebe

President, Yokohama National University

Dr. Tei-Wei Kuo

Interim President, National Taiwan University

1-2 Enhancement of International Student Exchange Programs between Universities in Japan and Taiwan

Chair (Moderator):

Dr. Edward H. Chow

President, National Chengchi University

Presenters:

Mr. Andy Cheu-An Bi

Director General, Department of International and Cross-Strait Education, Ministry of Education

Mr. Hideki Yonekawa

Vice President, Japan Student Services Organization (JASSO)

Session 1 Chair (Moderator)

Dr. Edward H. Chow

President

National Chengchi University



Biography

Education

- Ph.D. in Business, Indiana University-Bloomington, US (1991, Feb.)
- M.B.A. in Finance, Indiana University-Bloomington, US. (1988)
- B.A. in Business Administration, National Chengchi University, Taiwan, ROC. (1981)

Personal History

- Distinguished Professor, Department of Finance, National Chengchi University (Since Aug., 2010)
- Director of Investor Research Center of the College of Commerce of National Chengchi University (Since Aug. 2003 to Oct. 2014)
- Chairman of the Editorial Board of Harvard Business Review- Complex Chinese Edition (Jan. 2009 to Nov. 2014)
- Chief Editor of Journal of Financial Studies (Jan. 2009 to Jul. 2013)
- Dean, College of Commerce, National Chengchi University (Aug. 2005 to Jul. 2008)
- Associate Dean, College of Commerce, National Chengchi University (Aug. 2004 to Jul. 2005)
- Chairman, Department of Finance, National Chengchi University (Aug. 2000 to Jul. 2002)

Introduction to the university/institution

National Chengchi University(NCCU)

- ◆ Founded in 1927, a premier humanities and social sciences university in Taiwan and an acknowledged leader in Business, Humanities, Social Sciences, International Affairs, Communications, Foreign Languages and Literatures, Law, Education, and Sciences.
- ◆ Member of the 'MoE Top-University Project' Consortium
- ◆ 9 colleges, 38 doctoral programs, 10 university-level research centers
- ◆ The first AACSB- & EQUIS-accredited business school in Taiwan
- ◆ 5 international MA programs, 2 international PhD programs, and 1 international summer school
- ◆ 700+ partners from 68 countries
- ◆ 600+ English-Taught courses

Session 1-1 Presenters

Prof. Yuichi Hasebe

President

Yokohama National University



Biography

Prof. Hasebe was elected 15th president of YNU in April 2015. His research interests include comparative economic systems, input-output analysis, and environmental economics. He has served YNU for 12 years as Associate Professor and 22 years as Professor of College of Economics. During the 34 years, he was Dean of College of Economics (2004 - 2006), Dean of Graduate School of International Social Sciences (2011 - 2013), and so on. From 1990 to 1991, he studied at Berkeley, University of California as a Visiting Research Fellow. Then he was a visiting Economist of Economic Research Institute, Economic Planning Agency (Actual Economic and Social Research Institute) (1991 - 1993). He was the chairman of the Pan Pacific Input-Output Association (2012 - 2014), and also the advisor to the Chinese Input-Output Association (2011 - 2014). His Master's Degree in Economics, Hitotsubashi University (March 1981) Completed. Doctoral Degree Coursework in Economics, Hitotsubashi University (March 1984).

Abstract

Yokohama National University (YNU) has double degree programs with 7 universities. One among them, the College of Economics, YNU has an undergraduate double degree program with the School of Business, East China Normal University. This program is expected not only to develop highly-educated students at both universities, but also to foster professional global elites with outstanding language skill. Moreover, double degree programs for undergraduate students are rare within international cooperation agreements, so it is significant to conduct such a program as one of national universities.

Although YNU does not currently have a double degree program with a university in Taiwan, YNU does have many active collaborations in regard to education and research. For example, the YNU Japanese Language and Culture Program is a half-year/one-year program for students of partner universities in Taiwan. Students take Japanese language classes and lectures provided through the International Education Center and may transfer the credits earned back to their home universities. These courses are targeted chiefly at Taiwanese students who study Japanese language; thus, this enables them to learn about comparative study of culture and language between Japan and Taiwan through many lectures. Japanese students who have attended lectures on Taiwan are to act as tutors, and this seeks to foster mutual understanding. YNU also has an exchange opportunity related to sports education and research with partner universities in Taiwan.

Through these activities, YNU aims to promote deeper cooperation with universities in Taiwan.

Session 1-1 Presenters

Dr. Tei-Wei Kuo

Interim President

National Taiwan University



Biography

Tei-Wei Kuo is the Interim President and the Executive Vice President for Academics and Research, National Taiwan University. Prof. Kuo served as a Distinguished Research Fellow and the Director of the Research Center for Information Technology Innovation, Academia Sinica, between January 20, 2015, and July 31, 2016. Prof. Kuo was the Program Director of the Computer Science Division of the Ministry of Science and Technology (2013-2015) and is an executive committee member of both the IEEE Technical Committee on Real-Time Systems and IEEE Technical Committee on Cyber-Physical Systems and the Vice Chair of ACM SIGAPP. His expertise is embedded systems, non-volatile memory system and software, and real-time systems.

He received the Distinguished Leadership Award from the IEEE Technical Committee on Cyber-Physical Systems in 2017, the TECO Award in 2015, the ROC Ten Young Outstanding Persons Award in 2004, the Distinguished Research Award from the ROC National Science Council/Ministry of Science and Technology for three times, and the Young Scholar Research Award from Academia Sinica, Taiwan, ROC, in 2001, and received teaching awards from the National Taiwan University for eight times.

Abstract

Title: Enhancement of Double/Joint Degree Programs between Universities in Japan and Taiwan

- Implementation Status of Double/Joint Degree Programs in Taiwan
- Implementation Status and Best Practices of Double/Joint Degree Programs in NTU
- Looking into the Future: Analysis and Suggestions

Introduction to the university/institution

National Taiwan University (NTU) is Taiwan's flagship research institution. Committed to excellence for nine decades, the University has played a constructive role in Taiwan's remarkable transformation into a highly competitive economy and modern society. NTU offers a stimulating, intellectually rigorous environment in which to develop innovative research with strong impact. NTU is placed 1st in Taiwan and 40th in the world for academic reputation (QS World University Rankings 2018).

Session 1-2 Presenters

Mr. Andy Cheu-An Bi

Director General
Department of International and Cross-strait Education

Ministry of Education, Taiwan, R.O.C.



Education

- ◆ M.A., International Law and Diplomacy, National Chengchi University, Taiwan – 1988
- ◆ B.A., Political Science, Chinese Cultural University, Taipei, Taiwan – 1984

Current Position

- ◆ Director General, Department of International and Cross-strait Education, Ministry of Education – 2017
- ◆ Executive Director, Education Division, Taipei Economic and Cultural Office in Australia – 2014
- ◆ Deputy Education Counselor, Department of International and Cross-strait Education, Ministry of Education – 2012
- ◆ Director, Cultural Division, Taipei Representative Office in the EU and Belgium – 2009
- ◆ First Secretary, Bureau of International Cultural and Educational Relations Ministry of Education – 2006
- ◆ Senior Executive Cultural Officer, Taipei Economic and Cultural Representative Office in Washington D.C. – 2006
- ◆ Chief, First Section, Bureau of International Cultural and Educational Relations, Ministry of Education – 2004
- ◆ Second Secretary, Taipei Economic and Cultural Office in San Francisco – 2001

Abstract

Title: Enhancement of International Student Exchange Programs between Universities in Japan and Taiwan

- ◆ Introduction of the study abroad and study in Taiwan programs provided by the Ministry of Education
- ◆ Current student exchanges between Japan and Taiwan
- ◆ Future cooperation policies and opportunities

Introduction to the institution

The Ministry of Education is part of the Executive Yuan and is responsible for national academic and educational administration, including education policy planning and legislation and supervision of educational matters.

Session 1-2 Presenters

Mr. Hideki Yonekawa

Vice President

Japan Student Services Organization
(JASSO)



Biography

Professor Hideki YONEKAWA has served as Vice President, Japan Student Services Organization (JASSO) since April 2012. He is in charge of International Student Support, Japanese Language Education Support and Research Coordinator in JASSO.

Professor YONEKAWA got MA at Osaka University in 1976. Prior to be a Vice President of JASSO, he had worked in Osaka University and Osaka University of Education. His research interest includes youth culture, comparative study of initial teacher education, school administration, comparative study of achievement gap of children and research method. He is also a Professor Emeritus of Osaka University of Education in the field of Sociology of Education.

Abstract

In rapid expansion of International Student Mobility in the World, Japan has a goal of receiving 300,000 inbound and sending 120,000 outbound students by year 2020.

A series of national projects were launched based on the "300,000 International Students Plan" by MEXT, Japanese education ministry, which sets framework for internationalization of universities nationwide. For those projects a lot of scholarships are provided to help international students to study in Japan and Japanese students to study abroad.

Japan has a long history of student exchange with Taiwan. In this session, the Japanese government policies and the role of JASSO with the recent data of Taiwanese students in Japan will be analyzed and discussed.

Furthermore the challenges to overcome obstacles in Japan-Taiwan student mobility will be made clear.

Session 2

Introductory Session – Research Aspects: Enhancement of International Research Exchange and Industry-University Collaboration for Innovation

2-1 Enhancement of Young Researcher Exchanges between Universities in Japan and Taiwan

Chair (Moderator):

Dr. Atsushi Hamana

President, Kansai University of International Studies

Presenters:

Dr. Mariko Kobayashi

Governing Director, Headquarters for International Affairs, Japan Society for the Promotion of Science (JSPS)

Dr. Lu-Sheng Hong

Director, Science and Technology Division, Taipei Economic and Cultural Representative Office in Japan

2-2 Enhancement of Industry-University Collaboration Research Projects for Universities in Japan and Taiwan

Chair (Moderator):

Dr. Atsushi Hamana

President, Kansai University of International Studies

Presenters:

Dr. Yoshizane Maeda

President, Kagoshima University

Dr. Bing-Jean Lee

President, Feng Chia University

Session 2 Chair (Moderator)

Dr. Atsushi Hamana

President

Kansai University of International Studies



Biography

Dr.HAMANA, current President of Kansai University of International Studies (KUIS) and Chairman of the Board of Trustees, HAMANA Gakuin Educational Foundation.

His major field of study and research is sociology of education, especially higher education studies. He received Bachelor, Master of Arts, and Ph.D degree in sociology from Sophia University in Tokyo. He has worked as a special commissioner of the Central Council for Education in Ministry of Education Science and Technology, managing director of Japan Association of College and University Education (JACUE), director of Japanese Association for Higher Education Research (JAHER), and Chair Director of JHEDS (Japan Higher Education Data Sharing Consortium) etc. He won a Blue Ribbon Medal from prime minister.

Session 2-1 Presenters

Dr. Mariko Kobayashi

Governing Director
Headquarters for International Affairs

Japan Society for the Promotion of Science
(JSPS)



Biography

Mariko KOBAYASHI, Governing Director, Japan Society for the Promotion of Science (JSPS), is responsible for the international programmes of JSPS, such as the promotion of international joint research and seminar programmes (bilateral, multi-lateral), invitation fellowships for research in Japan, as well as collaboration with funding agencies abroad. She is also responsible for JSPS's overseas offices. Before joining JSPS in July 2016, she held various positions within the Ministry of Education, Culture, Sports, Science and Technology (MEXT) in the fields of primary and secondary education, higher education, international planning and coordination. She served as a Director of the International Education Division, MEXT from 2015 to 2016. She also worked at OECD/CERI (1999-2001), and as a First Secretary for Education and Science at the Permanent Delegation of Japan to UNESCO in Paris (2004-2006). She has a bachelor's degree in economics (Keio University) and a doctor's degree in policy studies (GRIPS).

Abstract

My presentation will be about international exchange programmes of Japan Society for the Promotion of Science (JSPS) which could be used for the enhancement of young researcher exchanges between universities in Japan and Taiwan.

First, I will briefly introduce what we do at JSPS as a funding agency and then briefly explain about the funding programmes of JSPS to promote international research collaboration; to strengthen the networking between universities as core research institutions; as well as fellowship programmes for young researchers from abroad and for Japanese young researchers to go abroad.

Session 2-1 Presenters

Dr. Lu-Sheng Hong

Director
Science and Technology Division

Taipei Economic and Cultural Representative Office in Japan



Biography

Dr. Lu-Sheng Hong is currently the Director of Science and Technology Division, Taipei Economic and Cultural Representative Office in Japan. He received his Ph.D. from the Department of Chemical Engineering, the University of Tokyo in 1992. Then, he served as a special researcher of science in Electrotechnical Laboratory (ETL), Agency of Industrial Science and Technology, Japan (1992-1993), later an associate professor in National Taiwan University of Science and Technology (1993-2000) and a full professor from 2000. In 2001, he joined the Atom Technology Project in "Joint Research Center for Atom Technology", AIST. In 2009, he visited U.S. as a research scholar in National Renewable Energy Laboratory (NREL). Dr. Hong's research focuses on the process modeling of chemical vapor deposition technique and its application in solid-state devices fabrication.

Abstract

Title: Enhancement of Young Researcher Exchanges between Universities in Japan and Taiwan

- Background of researcher exchanges between Taiwan and Japan
- The role of funding agency
- Recent trend in research personnel exchanges between Taiwan and Japan
- Future aspects

Introduction to the university/institution

Taipei Economic and Cultural Representative Office in Japan (TECO) is the diplomatic window organization of Taiwan in Japan. It is operated by the Taiwan-Japan Relations Association and Its Japanese counterpart is the Japan-Taiwan Exchange Association in Taipei. TECO promotes economic and trade cooperation between the two sides, academics, science and technology, culture, and sports exchanges, etc. The Science and Technology Division of TECO, with its personnel stationed by the Ministry of Science and Technology of Taiwan, is responsible for promoting the exchanges of scientific and technology between Taiwan and Japan.

Session 2-2 Presenters

Dr. Yoshizane Maeda

President

Kagoshima University



Biography

Dr. Yoshizane Maeda became Kagoshima University's twelfth president on 1st April 2013. His major subject areas are animal breeding, animal sciences and genetics. He received his Bachelor's and Master's Degree in Animal Sciences from Kagoshima University, and earned his Ph.D. in Agriculture at Kyushu University. He has held faculty positions at the university since 1981, and most recently was its executive director for research and community from 2009-2013. While at Kagoshima University, he also worked as a research associate at the University of Georgia from 1978-1979, and as a visiting professor at Michigan State University in 1998. He received awards from the Japanese Poultry Science Association in 1994 and the World's Poultry Science Association in 1996.

Abstract

With the recent intensification of international competition involving industry, universities and national research and development institutes brought on by the changing industrial structure and globalization, we are required to further promote the creation of innovation through joint industry-academia-government research.

With this situation in mind, my presentation will explain the Japanese government's policies for industry-academia collaboration based on the Guidelines for Enhancing Industry-Academia-Government Collaboration Activities, formulated by METI and MEXT on 30th November 2016, and the expected role of Japanese universities. Additionally, I will also introduce the educational and research collaboration between universities in Taiwan and Kagoshima University, and our efforts for social and community development based on our geographical characteristics as part of the Asia-Pacific region, specifically our educational and research project for TAD pathogens, epidemics and their control in the university's Transboundary Animal Diseases Research Center and our joint project with Kagoshima-Osumi Food Technology Development Center, which promotes research and development for processing and distribution techniques in the food industry. We will explore the future possibility of enhancing and deepening industry-university collaboration research projects for universities in Taiwan and Japan.

Session 2-2 Presenters

Dr. Bing-Jean Lee

President

Feng Chia University



Biography

Bing-Jean Lee received his B.S. degree in Civil Engineering from National Cheng Kung University in 1982, M.S. degree in Civil Engineering from National Taiwan University in 1984, and Ph.D. degree in Engineering Mechanics from The University of Texas at Austin in 1991. Before he joined the faculty of the Department of Civil Engineering, Feng Chia University, Taichung, Taiwan, in 1994, he worked as a post doctoral researcher in Massachusetts Institute of Technology and University of California, San Diego. Currently, he is a professor and the president of Feng Chia University. His research interests include mechanics of materials, earthquake engineering and disaster monitoring system. He is the principle investigator of debris flow monitoring system project of Soil Water Conservation Bureau, Taiwan.

Abstract

Title: Academics-Industrials-Innovates Integrated Education in Feng-Chia University

- Vision and Focuses
- Strategy and Plans
- Successful Working Models
- Summary

Introduction to the university/institution

Feng Chia University has a history of more than half a century. It is comprised of eight schools and colleges. Over 20,000 students are currently enrolled in undergraduate, Master's degree, and doctoral degree. There are 2,200 faculty and administrative staff and over 180,000 alumni. Surveys of executives from Taiwan's top 1,000 enterprises have consistently ranked FCU in the top 10 for the quality of its graduates. FCU was ranked among the top 100 global "emerging" universities in a survey published in the UK's The Times Higher Education Supplement. This survey was based on 13 performance indicators, including academic prestige, educational quality, research projects, internationalization efforts and industry-academia collaborations. FCU was listed among Asia's top 100 universities by the same publication in its inaugural Asia University Rankings.

Session 3

Plenary Session (Educational Aspects)

Chair (Moderator):

Dr. Fuh-Sheng Shieu

President, National Chung Hsing University

Presenters:

Dr. Flora Chia-I Chang

President, Tamkang University

Dr. Yasunao Hattori

President, Shimane University

Session 3 Chair (Moderator)

Dr. Fuh-Sheng Shieu

President

National Chung Hsing University



Biography

Dr. Fuh-Sheng, Shieu was born in Penghu County, Taiwan in 1959. He earned a Ph.D. in Materials Science & Engineering from Cornell University, USA in 1990. He serves as the President of National Chung Hsing University, the Chairman of the Foundation of College Entrance Examination Center, a member of the Board of Directors for the Aerospace Industrial Development Corporation, a member of the Board of Directors for the Industrial Technology Research Institute, and the President of the Academia-Industry Consortium for Central Taiwan Science Park.

He has published 148 papers in SCI journals, written 7 books, and patented 6 inventions. He has been recognized as a fellow at the Institute of Engineering and Technology (IET), the Institute of Materials, Minerals and Mining (IOM3), as well as the Australian Institute of Energy (AIE). He has also won the Distinguished Alumni Award of MS&E, Cornell University.

Introduction to the university/institution

National Chung Hsing University (NCHU) traces its origin to 1919 with the establishment of the Advanced Academy of Agronomy and Forestry, making NCHU the oldest research university, with the second largest campus, in Taiwan's higher education.

NCHU is the only top research university in central Taiwan. It has 8 colleges: Agriculture and Natural Resources, Science, Life Sciences, Liberal Arts, Law and Politics, Engineering, Veterinary Medicine, and Management.

Since its establishment, NCHU has been very strong in agricultural sciences, plant & animal science and life sciences. A number of faculties are unique in Taiwan, such as the country's first college of veterinary medicine. Research facilities or institutes belonging to the university are scattered throughout Taiwan, including two experimental farms and three forest stations. It also has two affiliated high schools.

NCHU is the only one university in Asia that has signed the Dual-degree Veterinary Medicine Program with two universities, Iowa State University and Kansas State University, in USA.

Session 3 Presenters

Dr. Flora Chia-I Chang

President

Tamkang University



Biography

Dr. Flora Chang is the president of Tamkang University (TKU) since 2004, and currently a professor of Graduate Institute of Educational Policy and Leadership of TKU. Dr. Chang earned a master's degree in economics from San Francisco State University in 1982, another master's degree in education from Stanford University in 1983, and doctoral degree on higher education from Stanford University in 1995.

Under her leadership, in 2009, TKU was awarded the 19th National Quality Award from the Taiwan Ministry of Economic Affairs for the excellent achievement in implementing the system of Total Quality Management. She had been elected as the Chairperson of the Foundation for International Cooperation in Higher Education of Taiwan (FICHET) from 2009 to 2015. In addition, she serves as the Chairperson of Taiwan Higher Education Society which focuses on issues related to higher education, such as research, policy suggestion, and academic publication since 2014.

Abstract

Title: Rising International Student Mobility at Tamkang University: The Interaction with Japan

- Factors and trends of international student mobility
- Academic cooperation by Tamkang University with partner universities in Japan
- Outward student mobility at Tamkang University and the distribution of Tamkang students in Japan
- Inward student mobility at Tamkang University and the distribution of Japanese students at Tamkang
- Prospects and Conclusion

Introduction to the university/institution

Founded in 1950, Tamkang University now has 4 campuses, 8 colleges with a total of over 26,600 students, providing more than 400 English-taught courses and 12 English-taught degree programs. Tamkang distinguished itself by earning the 19th National Quality Award, received the Outstanding Internationalization Award and the Excellence in International Student Guidance and Counseling Award from the Ministry of Education. Additionally, Tamkang has been listed in the top private university nurturing the "Most Desired University Graduates for Enterprises" in the survey conducted by Cheers Magazine for 20 consecutive years. Tamkang seeks to become a world-renowned comprehensive university by providing students with the most modern learning resources and the global outlook.

Session 3 Presenters

Dr. Yasunao Hattori

President

Shimane University



Biography

I am the president of Shimane University since April 1, 2015. Before I became the president, I was working at Shimane University since 1993 as an associate professor and professor at the Department of Mathematics and Computer Science. I was also the Dean of the Interdisciplinary Faculty of Science and Engineering from October 1, 2011 to March 31, 2015.

My major is Mathematics, especially Topology- a part of Geometry. Topology is the study of properties preserving by continuous transformations, and it has a big progress in the last one hundred years. I was awarded the Doctor of Science from Tsukuba University in 1992. I am a member of The Mathematical Society of Japan and American Mathematical Society.

Abstract

In Shimane University's Charter it states that we aim to foster "autonomous students who can learn by themselves with rich human nature and advanced expertise" and devote our energy to practical activities that create opportunities for self-initiated learning in the classroom as well as in the region and overseas. We provide a wide range of active learning through field learning, problem-based learning, overseas internships, and various minor programs specifically designed to widen students' horizons. In addition, utilizing teaching IR data, we constructed a predictive learning support system which enables students to check their current learning situation, discover for themselves what they want to be in the future, and imagine their own future more specifically at the time of graduation. As part of our continued drive to internationalize, we give foreign students scholarships for internship programs at local companies and develop outstanding leaders by improving mutual understanding and problem-solving skills through student exchanges in collaboration with universities in the Tokyo area. As these examples demonstrate, we are actively promoting exchanges between and among international students and Japanese students.

Session 4

Plenary Session (Research Aspects)

Chair (Moderator):

Dr. Tetsuo Asano

President, Japan Advanced Institute of Science and Technology

Presenters:

Dr. Yoshiyuki Kakehi

President, Kagawa University

Dr. Chieh-Hsi Wu

Vice President, Taipei Medical University

Session 4 Chair (Moderator)

Dr. Tetsuo Asano

President

Japan Advanced Institute of Science and Technology



Biography

Dr. Asano is President of Japan Advanced Institute of Science and Technology (JAIST), where he has been since 2014. He received his Bachelor's and Master's degrees in engineering in 1972 and 1974, respectively, and Ph.D. degree in 1977 from Osaka University.

His research interests include algorithms, especially computational geometry and memory-constrained algorithms. In 1977 he joined Osaka Electro-Communication University as a lecturer and then moved to JAIST as a professor in 1997. In JAIST he served an Assistant to the president and Director of Center for Graduate Education Initiative before becoming Dean of School of Information Science. He served as editors of many international journals such as Discrete and Computational Geometry, Int. J. on Computational Geometry and Applications, and Computational Geometry: Theory and Application. He is a Fellow of the ACM.

Session 4 Presenters

Dr. Yoshiyuki Kakehi

President

Kagawa University



Biography

Dr. Kakehi, President of Kagawa University, was graduated from Kyoto University Faculty of Medicine in 1981. He received Ph.D. in 1989 from the Graduate School of Medicine, Kyoto University. He became a chairman of Department of Urology, Kagawa University Faculty of Medicine in 2001 and became a president of Kagawa University in October 2017. His major subjects are urology, robotic surgery and urologic oncology. During the period when he served as a Trustee and Vice-President (2015.10-2017.9), he simultaneously worked as a chairman of two newly established institutes of Kagawa University; 1) Institute of Education, Research and Regional Cooperation for Crisis Management, Shikoku, 2) International Institute of Rare Sugar Research and Education. He also played a pivotal role in establishing the Faculty of Engineering and Design (launched since April 2018) which is fostering engineering personnel capable of creating human-centered innovations.

Abstract

‘Candidate collaborative research fields between Taiwan and Japan’

Kagawa University has established partnership agreement with 3 universities in Taiwan, National Chiayi University (2013.4-), Chinese Culture University (2017.8-), National Chung Cheng University (2017.8-). In addition, we established research partnership with Central Weather Bureau in 2017. To now we have accepted about 80 students/teaching staffs from Taiwan while we sent more than 35 students/teaching staffs. There are geographical similarities between Taiwan and Japan and both are confronted with the same risks caused by typhoons and earthquakes. Therefore mitigation science against natural disaster, particularly making use of big data extracted from the ocean and artificial intelligence, is a promising research fields for collaboration. The Setouchi Triennale was successfully held in 2010, 2013, and 2016 in Kagawa Prefecture and the many islands on the (Seto) Inland Sea. Many foreign artists including Taiwanese artists came to Kagawa and greatly contributed to it. Its great success suggests possibilities of activating rural area through excavating hidden cultural and artistic resources that attract tourists. Eco-tourism, rural tourism and art-tourism therefore are candidate research fields. On the other, aging population is rapidly increasing in both Taiwan and Japan. It is imperative to investigate how to re-design our community where elderly people of both countries can enjoy physically and mentally healthy daily life.

Session 4 Presenters

Dr. Chieh-Hsi Wu

Vice President

Taipei Medical University



Biography

Professor Jackson Jei-Hsin Wu joined Taipei Medical University as Dean of Pharmacy in 2013 and Vice President in Aug 2017. With a bachelor's degree in Pharmacy and a Ph.D. in Pharmacology, Professor Wu has a strong academic background and diverse professional experience in Taiwan and the United States.

Professor Wu received his Ph.D. degree in 1994 from Ohio State University, where he also worked as a Pharmacology research assistant and as an Internal Medicine postdoctoral fellow. He co-authored a conference paper on gene expression published in Society for Neuroscience. At the University of California in San Diego, he spent two years as a postdoctoral fellow in the Department of Bioengineering.

Professor Wu returned to Taiwan to join China Medical College (now China Medical University) in 1997. Before moving to Taipei Medical University, he held various academic and managerial positions including chairing the School of Pharmacy for six years. He still serves as the medical consultant at that institute.

After joining TMU, Professor Wu led the College to reach a number of milestones, including the development of a six-year Pharm.D. program – a pilot arrangement in private HEIs in Taiwan. The College has also enhanced teaching and research performance by working with a diverse group of international partners. The number of student mobility programs has steadily increased, and the College also plans to expand its international joint degree programs.

Abstract

As a research-intensive university, Taipei Medical University (TMU) has been committed to supporting its teams of researchers with their efforts in finding effective solutions to the challenges in the area of medicine and health care that our world is facing. To ensure that research findings get translated into real application, having resources and procedures that enables the prevalence of research application becomes a key to success.

In this session, the speaker will share the experience of TMU in building systematic support covering early-stage development of research collaboration projects, financial and administrative aids, and exploration of commercial potential of research findings. TMU's achievement in managing research with a business mind has landed itself to the privileged position to project manage GloRIA (Global Research & Industry Alliance) sponsored by Taiwan Ministry of Science and Technology, bringing the innovation of Taiwan's biotechnology and biomedicine centres to players around the world.

Introduction to the university/institution

Established in 1960, Taipei Medical University (TMU) is one of the most reputable universities in Taiwan. Today, TMU has expanded into a world-class university with 10 colleges, 1 General Education Center, 6,000 students per year, 9,000 staff/faculty member, six hospitals, and more than 40,000 alumni around the world.

Closing Remarks

Dr. Yuh-Long Oliver Su

President, National Chi Nan University

Rev. Noriaki Nagao

President, Tenri University

Closing Remarks

Dr. Yuh-Long Oliver Su

President

National Chi Nan University



Biography

Dr. Yuhlong Oliver Su is the President of National Chi Nan University and a professor of applied chemistry. His previous tenure was Vice President at National Chung Hsing University from 2009 to 2011.

He received a bachelor's degree in Chemistry from National Taiwan University, holds a master's degree in Chemistry from National Taiwan Normal University, and completed his Ph.D. from Ohio State University before working as a research associate at Princeton University.

He specializes in electroanalytical chemistry and porphyrin chemistry. From 2009 to 2018, he published 28 articles in reputed journals, garnering accolades such as the Research Award by the National Science Council, Special Outstanding Talent Award by the Ministry of Science and Technology, and Special Outstanding Talent Award by the Ministry of Education.

University/Institution

Located in a hilly region of central Taiwan, NCNU enjoys a scenic mountain view and sits next to a neighborhood rich with tourist attractions and cultural resources. The delightfully green, spacious, and lively campus spanning 150 hectares provides for 276 teachers and researchers and 6,540 students in 2018.

This environment is cherished by the school, which champions sustainability through the reduction of carbon emissions and other green measures. As a school recognized as 62nd worldwide by the UI Green Metric World University rankings, NCNU is an inviting place for learning and teaching.

These advantages serve as inspiration for NCNU's pursuit in delivering innovative teaching and participative learning while serving the local community. Recent programs and partnerships have extended into areas such as engaging migrant workers and immigrants from Southeast Asia, improving air quality, boosting the economic livelihood of indigenous villages, and refining agriculture through applied technology. This stands witness to NCNU's conscious embracement of the social responsibility borne by universities.

Positioned as an intimate, exquisite, and inclusive university and with a history of 23 years, NCNU endeavors to provide a colorful and diversified experience to all our students. Athletes competing in international canoeing and kayaking, softball, and archery competitions also enhance the university's reputation. The collaborative opportunities created from NCNU's local and international engagement also endow students with additional workplace and life skills.

Closing Remarks

Rev. Noriaki NAGAO

President

Tenri University



Biography

After graduation from Tenri University, Rev. Nagao started to work for Tenrikyo Church Headquarters. In 1984, he was sent to Paris in France where he worked for Tenrikyo Europe Centre as a staff minister. Appointed as the head minister of the Centre in 1995, he worked hard to contribute towards the betterment of society in France. Especially, representing Tenrikyo, he had many chances to participate in Interreligious Meetings held in the different places in Europe and prayed for world peace where he met many representatives of the world major faiths including the Pope of Rome.

Returning to Japan in 2009 after 25 years in France, Rev. Nagao held prominent positions such as the vice-head of Tenrikyo Overseas Department and the president of Tenrikyo Doyusha Publishing Company. He then took up a post of the president of Tenri University in April, 2016. His specialty is French language and religion.

Participating Organization

Taiwan Side	
Universities	
No.	
1	Chang Jung Christian University
2	Chihlee University of Technology
3	Chung Shan Medical University
4	Feng Chia University
5	Fu Jen Catholic University
6	Hungkuang University
7	Kaohsiung Medical University
8	Minghsin University of Science and Technology
9	National Changhua University of Education
10	National Cheng Kung University
11	National Chengchi University
12	National Chi Nan University
13	National Chiayi University
14	National Chin-Yi University of Technology
15	National Chung Hsing University
16	National Dong Hwa University
17	National Kaohsiung University of Science and Technology (NKUST)
18	National Pingtung University of Science and Technology
19	National Taichung University of Education
20	National Taipei University of Business
21	National Taiwan University
22	National Taiwan University of Arts
23	National Taiwan University of Science and Technology
24	National Tsing Hua University
25	National Yunlin University of Science and Technology
26	Providence University
27	Shih Hsin University
28	Soochow University
29	Southern Taiwan University of Science and Technology
30	Tainan University of Technology
31	Taipei Medical University
32	Tamkang University
33	Tatung University
34	Wenzao Ursuline University of Languages
35	Yuan Ze University
Other Institutions	
No.	
36	Ministry of Education
37	Taipei Economic and Cultural Representative Office in Japan
38	FICHET
39	Taiwan Education Center Japan

Participating Organization

Japan Side	
National Universities	
No.	
40	Hokkaido University
41	Muroran Institute of Technology
42	Iwate University
43	Akita University
44	The University of Tokyo
45	Tokyo University of Foreign Studies
46	Tokyo Institute of Technology
47	Hitotsubashi University
48	University of Tsukuba
49	Utsunomiya University
50	Saitama University
51	Chiba University
52	Yokohama National University
53	Niigata University
54	University of Yamanashi
55	Shinsyu University
56	Kanazawa University
57	Japan Advanced Institute of Science and Technology
58	Shizuoka University
59	Nagoya University
60	Toyohashi University of Technology
61	Kyoto University
62	Kyoto Institute of Technology
63	Osaka University
64	Hyogo University of Teacher Education
65	Kobe University
66	Tottori University
67	Shimane University
68	Okayama University
69	Hiroshima University
70	Yamaguchi University
71	Kagawa University
72	Ehime University
73	Kochi University
74	Kumamoto University
75	Kagoshima University
76	University of the Ryukyus

Public Universities	
No.	
77	Future University Hakodate
78	Akita University of Art
79	Saitama Prefectural University
80	Advanced Institute of Industrial Technology
81	University of Shizuoka
82	Osaka Prefecture University
Private Universities	
No.	
83	Aoyama Gakuin University
84	Asia University
85	Bunri University of Hospitality
86	Chiba Institute of Technology
87	Chuo University
88	Doshisha University
89	Hiroshima Shudo University
90	J. F. Oberlin University
91	Kanagawa University
92	Kansai University
93	Kansai University of International Studies
94	Kansai University of Welfare Sciences
95	Kinjo University
96	Kobe International University
97	Meijigakuin University
98	Nanzan University
99	Osaka University of Commerce
100	Shibaura Institute of Technology
101	Sophia University
102	Tenri University
103	Tokai University
104	Toyo University
105	Tsuda University
106	Waseda University
Other Institutions	
No.	
107	Japan - Taiwan Exchange Association
108	Japan Student Services Organization
109	Japan Society for the Promotion of Science
110	Federation of Japanese Private Colleges and Universities Associations
111	Association of Private Universities of Japan
112	The Japan Association of National Universities
113	Japan Committee of Universities for International Exchange

University Introduction

Taiwan Side

1	Chang Jung Christian University
Introduction	Chang Jung Christian University, founded in 1992 and affiliated with the Presbyterian Church in Taiwan, is a private university located in southern Taiwan. There are currently forty-nine bachelors programs, nineteen masters programs, and one doctoral program, covering the fields of Management, Health Sciences, Humanities and Social Sciences, Information and design, Sustainable Development, and Theology. The College of Information and Design has passed the IEET Engineering and Technology Education certification by the Institute of Engineering Education Taiwan (IEET). The College of Management is also processing the AACSB International certification.
Statistics	No. of Students: 10,139 / No. of International Students: 381
Field of Interest for Collaboration with Universities in Japan	Exchange Students, Culture Program, Faculty Exchange

2	Chihlee University of Technology
Introduction	Chihlee University of Technology was established in 1965, as an innovative, practical, business-oriented full university. Chihlee aims to develop global perspective and professional competence in international commerce, foreign language, business management, innovation and design. Chihlee University of Technology is located in the heart of Taipei, easily accessible with the most convenient public transportation system in its neighborhood. Chihlee students have had the highest rate of certificate holding for 9 years; therefore, they performed the third highest rate of enrollment in 2016, which enables Chihlee to become a significant manpower resource for major enterprises and government agencies. As one of the finest educational institutions in Taiwan, Chihlee has 87 partnership schools worldwide, with countries such as America, Japan, Australia, and Mainland China, and ASEAN countries like Vietnam and Thailand, in an effort to foster international and Cross-Strait cooperation together with inter-collegiate exchange.
Statistics	No. of Students: 11,000 / No. of International Students: 96
Field of Interest for Collaboration with Universities in Japan	Student Exchange Program Student Internship Program Staff Development Program Faculty Mobility Program Research Collaboration

3	Chung Shan Medical University
Introduction	A private university established in 1960 emphasized in med/allied-health/science/humanity education and research with 21 strong undergrad majors and 28 grad programs. Active in international collaborations for student/faculty exchanges and researches including dental science, cancer, biomed and rehabilitation. A state-of-the-art hospital provides well-designed trainings for every specialty.
Statistics	No. of Students: 7,000 / No. of International Students: 320
Field of Interest for Collaboration with Universities in Japan	<ol style="list-style-type: none"> 1. Clinical medicine (student/faculty exchange/internships) including medical doctoral, dental, nursing programs. 2. Rehabilitation (physical therapy, occupational therapy, speech therapy, audiology, and clinical psychology) 3. Allied-health programs (clinical laboratory, medical imaging and radiology, optometry) 4. Science programs (nutrition, public health, biomedical) 5. Humanity and language programs

4	Feng Chia University
Introduction	<p>#1 private comprehensive university in Taiwan according to the 2016 QS Asia University Rankings; Finance and Accounting in the top-150 in the QS World University Rankings by Faculty; All Engineering programs are accredited by IEET (equivalent to ABET); All Business programs are accredited by AACSB; Engineering, Material I science, and Computer science are listed top 1% in the world's essential science indicators (ESI), APEC founded green energy laboratory, Taiwan's #1 geographic information system research center; #1 overall performance university in 2015 & 2016 and #2 in 2017 & 2018, which were voted by 150 Taiwan's university presidents.</p> <p>Feng Chia University has over 20,000 enrolled students among top 5 in Taiwan, 10 schools and colleges (Engineering, Business, Sciences, Finance, Construction and Development, School of Architecture, Information and Electrical Engineering, Humanities and Social Sciences, School of Management Development, and International School of Technology and Management), 1600 international students among 34 departments. FCU has organized a fully English taught school, International School of Technology and Management in 2014. Except Chinese Literature, all other 13 PhD programs provide English-taught courses.</p>
Statistics	No. of Students: 21,000 / No. of International Students: 2,500
Field of Interest for Collaboration with Universities in Japan	<p>Exchange faculty / student</p> <p>Dual degree cooperation</p> <p>Joint research</p> <p>Short term program</p>

5	Fu Jen Catholic University
Introduction	Fu Jen Catholic University, founded in 1925, is a comprehensive university in Taipei, Taiwan and comprises 12 colleges and 50 departments, offering 49 master, 24 in-service master and 12 Ph.D. programs. Our university actively promotes cooperation, including student exchange, dual-degree programs, visiting professors, joint conferences and academic visits with over 380 universities worldwide. We have 45 partner universities in Japan, including Momoyama Gakuin, Sophia, Saga, Nanzan, Tohoku, Doshisha, Akita International, Tsukuba, Hosei, Hiroshima and Ritsumeikan University.
Statistics	No. of Students: 27,000 / No. of International Students: 1,822
Field of Interest for Collaboration with Universities in Japan	<ul style="list-style-type: none"> • Cross-Cultural Studies • Japanese Language and Culture • Mandarin Courses • Business and Management

6	Hungkuang University
Introduction	Hungkuang University was founded in 1967 by Dr. Yu-Lin Wang with the mission of "Caring for Humanity, Cherishing Life." Currently there are 5 colleges: the College of Nursing, the College of Medical and Health Care, the College of Human Science and Social Innovation, the College of Intelligent Technology, and the College of General Education. These five colleges support 22 departments, 10 graduate institutes, and 1 doctoral program.
Statistics	No. of Students: 13,000 / No. of International Students: 700
Field of Interest for Collaboration with Universities in Japan	<p>Health: Nursing, Physical Therapy, Nutrition, Biotechnology, Animal Healthcare, Speech Language Pathology & Audiology. Senior Citizen Welfare & Business, Health Business Administration.</p> <p>Human Science: Food Science, Culinary Arts & Hotel Management, Applied Cosmetology, Hair Styling & Design, Child Care & Education, Cultural and Creative Industries, Sports & Leisure, Applied English.</p> <p>Intelligent Technology: Safety, Environmental Engineering, Computer Science & Information Engineering, Biomedical Engineering.</p>

7	Kaohsiung Medical University
Introduction	<p>Established in 1954, Kaohsiung Medical University (KMU) is the first private university in Taiwan and has become a leading medical university with our highly-skilled medical related specialists and professionals.</p> <p>A broad spectrum of specialized degrees for health care professionals are offered respectively in 7 Colleges--Medicine, Dental Medicine, Pharmacy, Nursing, Health Sciences, Life Sciences, and Humanities & Social Sciences. KMU is the only university that provides post baccalaureate program in medicine in Taiwan. In addition, KMU is currently running Dual Ph.D. programs with partner universities in Australia, France, Hungary, Sweden, and the U.S.A..</p> <p>Moreover, KMU has five affiliated hospitals, which become KMU Health System to serve the communities in southern Taiwan. We prepare our students to better understand our life and meet the demands of the 21st Century job market.</p>
Statistics	No. of Students: 6,881 / No. of International Students: 505
Field of Interest for Collaboration with Universities in Japan	<p>Medicine Dental Medicine Pharmacy and Pharmacology Nursing Health Sciences Life Sciences Humanities and Social Sciences</p>

8	Minghsin University of Science and Technology
Introduction	<p>Founded in 1966, MUST now has 4 colleges-Engineering, Management, Service Industries, and Humanities and Social Sciences, with 22 departments and 10 graduate programs.</p> <p>Very close to Hsinchu Industrial Park (3 mins) and the renowned Hsinchu Science Park (10 mins), maintaining strong relationship with local industries and businesses on academic research, practical training, community services, and offering numerous career opportunities.</p> <p>Top 1 of Taiwan Most Favored New Recruits by Enterprises surveyed by Cheers magazine in 2016, 2017, and 2018. (Among private technical and vocational universities of northern Taiwan)</p> <p>The University is accredited by Comprehensive Accreditation (2015) and Higher Education Evaluation and Accreditation Council of Taiwan (2016) of the Ministry of Education.</p> <p>Introduction of MUST on Youtube : </p>
Statistics	No. of Students: 12,088 / No. of International Students: 510
Field of Interest for Collaboration with Universities in Japan	<ol style="list-style-type: none"> 1. Exchange of faculty, scholars, and graduate students for lecturing, advanced studies and research between two institutions. 2. Research Cooperation in the fields of Engineering, Management, Service Industries, Humanities and Social Sciences. 3. Organization of bilateral joint symposia, workshops and conferences. 4. Conducting short-term camp, joint and integrated programs for students.

9	National Changhua University of Education (NCUE)
Introduction	NCUE is one of three normal universities in Taiwan and the only national university in Changhua County. With rich experience and resources, we have the advantage of teacher training. We make a great effort to develop and strengthen the international cooperation. So far, we have had over 140 overseas sisterhood universities covering 17 countries on four continents. We have also established the Dual-degree Program with California State University, Fresno, and have been involving in the program establishment with more partner universities.
Statistics	No. of Students: About 8,500 / No. of International Students: About 300
Field of Interest for Collaboration with Universities in Japan	<ol style="list-style-type: none"> 1. Exchange students 2. Exchange faculty 3. Short-term programs 4. Chinese programs 5. Summer School 6. Dual degree program 7. Other possibilities

10	National Cheng Kung University
Introduction	<p>Location: Tainan, Taiwan</p> <p>No. of Colleges: 9 colleges including Liberal Arts, Sciences, Engineering, Electrical Engineering & Computer Science, Planning & Design, Management, Social Sciences, Medicine, and Bioscience & Biotechnology.</p> <p>No. of Programs: 44 undergraduate programs, 78 master's degree programs, 56 doctoral programs and 24 master's degree programs for working professionals. Moreover, there are 28 degree programs are taught via English-mediated instruction (EMI).</p> <p>Strong Fields of Study: Engineering, Science, Medicine, Management, Planning and design</p> <p>Rankings: 2018 QS World University Rankings: 222nd in the world with 35th in Asia. 51st -100th worldwide in the field of Engineering.</p>
Statistics	No. of Students: 21,252 / No. of International Students: 1,624
Field of Interest for Collaboration with Universities in Japan	<ol style="list-style-type: none"> 1. MoU for general collaboration 2. Exchange student/faculty 3. Joint/dual degree programs 4. Short-term programs 5. Mandarin learning programs

11	National Chengchi University
Introduction	<ul style="list-style-type: none"> ◆ Founded in 1927, a premier humanities and social sciences university in Taiwan and an acknowledged leader in Business, Humanities, Social Sciences, International Affairs, Communications, Foreign Languages and Literatures, Law, Education, and Sciences. ◆ Member of the 'MoE Top-University Project' Consortium ◆ 9 colleges, 38 doctoral programs, 10 university-level research centers ◆ The first AACSB- & EQUIS-accredited business school in Taiwan ◆ 5 international MA programs, 2 international PhD programs, and 1 international summer school ◆ 700+ partners from 68 countries ◆ 600+ English-Taught courses
Statistics	No. of Students: 16,353 / No. of International Students: 3,000+
Field of Interest for Collaboration with Universities in Japan	<ul style="list-style-type: none"> ■ MoU for general collaboration: ■ Industry-academic collaboration ■ Joint research ■ Exchange student ■ Exchange faculty ■ Joint degree programs ■ Dual degree programs ■ Short-term programs

12	National Chi Nan University
Introduction	<p>Founded in 1995 in Puli, Nantou, National Chi Nan University (NCNU) thrives as a green, young and dynamic academic sanctuary in the geographical heart of Taiwan. NCNU provides a wide range of programs facilitated by four colleges: Science and Technology, Education, Humanities and Management. The department of International Comparative Education, which can only be found at NCNU, is the University's uniqueness along with the fact that we house the best Southeast Asia Studies Department in Taiwan. Today, NCNU has a student population of over 6000, and a faculty and staff strength of 550. Moreover, there are more than 700 international students (including overseas Chinese students) from 22 different countries. International students comprise a whopping 12% of NCNU students. The University offers a wide array of opportunities for a meaningful international experience. NCNU is a place of captivating attractions and also a place refined for academic pursuits.</p>
Statistics	No. of Students: 6,156 / No. of International Students: 783
Field of Interest for Collaboration with Universities in Japan	MoU, Exchange Student Agreement, Dual Degree Agreement

13	National Chiayi University
Introduction	<p>National Chiayi University (NCYU) was formed in February 2000 by merging National Chiayi Institute of Technology (NCIT), firstly established in 1919 as "Chiayi Agriculture and Forestry Public School", and National Chiayi Teachers College (NCTC), founded in 1957 as "Taiwan Provincial Chiayi Normal School" in the first place. The University, with seven colleges covering a wide range of fields including Life Science, Agriculture, Management, Science and Engineering, Humanities and Arts, Education, and Veterinary Medicine, has been actively engaged in various global affairs. At present, we are cooperating with 73 partner universities from Australia, Canada, China, France, Germany, Indonesia, Japan, Korea, Mongolia, Malaysia, New Zealand, Paraguay, Philippine, Russia, Spain, Republic of Slovenia, Thailand, the United Kingdom, the United States of America, and Vietnam.</p> <p>NCYU offers abundant opportunities for the faculties and students to develop intercultural and academic competence as well as to broaden their global perspectives through participating in different national and international exchange and collaborative programs. Please refer to the University homepage http://www.ncyu.edu.tw/eng/index.aspx for further information.</p>
Statistics	No. of Students: 12,643 / No. of International Students: 469
Field of Interest for Collaboration with Universities in Japan	<ul style="list-style-type: none"> ■ MoU for general collaboration ■ Joint research in the fields of humanity, management, agriculture, engineering, life sciences, and veterinary. ■ Exchange student/faculty in the fields of humanity, management, agriculture, engineering, life sciences, and veterinary. ■ Joint/dual degree programs in the fields of humanity, management, agriculture, engineering, life sciences, and veterinary. ■ Short-term programs in the fields of humanity, management, agriculture, engineering, life sciences, and veterinary.

14	National Chin-Yi University of Technology
Introduction	<p>NCUT is committed to offering the highest quality of education and vocational training. In order to achieve this goal, we endeavor to improve the quality of courses and promote industry-academy collaboration. Furthermore, with technology transfer as ultimate goals, our Incubation Center has served as a platform for the faculty members and the industries to conduct joint research project. By participating in these projects, students are allowed to undertake an internship at NCUT's industry partners to increase their competitiveness in the job market.</p>
Statistics	No. of Students: 11,128 / No. of International Students: 120
Field of Interest for Collaboration with Universities in Japan	<ol style="list-style-type: none"> 1. Electrical Engineering / Electronic Engineering / Computer Science and Information Engineering 2. Chemical and Materials Engineering / Refrigeration, Air Conditioning and Energy Engineering / Mechanical Engineering 3. Business Administration / Distribution Management / Information Management / Industrial Engineering & Management / Leisure Industry Management 4. Cultural and Creative Industries / Landscape Architecture / Applied English / College of Humanities and Creativity

15	National Chung Hsing University
Introduction	<p>National Chung Hsing University (NCHU) traces its origin to 1919 with the establishment of the Advanced Academy of Agronomy and Forestry, making NCHU the oldest research university, with the second largest campus, in Taiwan's higher education.</p> <p>NCHU is the only top research university in central Taiwan. It has 8 colleges: Agriculture and Natural Resources, Science, Life Sciences, Liberal Arts, Law and Politics, Engineering, Veterinary Medicine, and Management.</p> <p>Since its establishment, NCHU has been very strong in agricultural sciences, plant & animal science and life sciences. A number of faculties are unique in Taiwan, such as the country's first college of veterinary medicine. Research facilities or institutes belonging to the university are scattered throughout Taiwan, including two experimental farms and three forest stations. It also has two affiliated high schools.</p> <p>NCHU is the only one university in Asia that has signed the Dual-degree Veterinary Medicine Program with two universities, Iowa State University and Kansas State University, in USA.</p>
Statistics	No. of Students: 14,252 / No. of International Students: 710
Field of Interest for Collaboration with Universities in Japan	<ol style="list-style-type: none"> 1. MoU for general collaboration 2. Exchange Student Program 3. Exchange Professor/ Faculty 4. Joint/dual degree programs 5. Short-term programs 6. Academic Collaboration

16	National Dong Hwa University
Introduction	<p>National Dong Hwa University was founded in 1994, for the eastern part of the first comprehensive public university. The school, bounded to the east by the Pacific Ocean and to the west by a prodigious mountain range, is also known as the most beautiful campus in Taiwan.</p> <p>NDHU has 8 colleges offering 39 Bachelor, 42 Master and 18 PhD programs in various academic fields. So far, NDHU houses more than 10,000 students and has successfully established hundreds of sister universities around the world.</p>
Statistics	No. of Students: 10,154 / No. of International Students: 842
Field of Interest for Collaboration with Universities in Japan	Humanities and Social Science, Management, Science and Engineering, Indigenous Studies, Education, Arts, Environment Studies, Marine Sciences, and Chinese Language Program.

17	National Kaohsiung University of Science and Technology
Introduction	The National Kaohsiung University of Science and Technology was created as the result of a merger of three technological universities in Taiwan, namely the National Kaohsiung University of Applied Sciences, the National Kaohsiung First University of Science and Technology, and the National Kaohsiung Marine University. NKUST is now the largest national university of science and technology and the second largest national university in Taiwan. NKUST strives to offer globalized education featuring innovation and entrepreneurship, academia-industry collaboration, and marine technologies. Currently, NKUST has 5 campuses and 14 colleges, serving more than 27,568 students and 170,000 alumni.
Statistics	No. of Students: 271 / No. of International Students: 27,568
Field of Interest for Collaboration with Universities in Japan	Engineering 、Electrical Engineering and Computer Science 、 Management, Humanities and Social Sciences 、Finance and Banking, Language, Ocean Engineering, Maritime Affairs, Hydrosphere Science

18	National Pingtung University of Science and Technology
Introduction	NPUST has received distinction in teaching, research, and building human capacity. In order to take advantage of NPUST's strength in tropical agriculture and to make greater contribution to the society, the university promote "product oriented research (POR)". Therefore, NPUST has established links with more than 154 world-renowned universities through various academic exchanges, distance education, faculty and student exchanges, resources sharing, and joint research. There are about 700 international students currently enrolled at NPUST.
Statistics	No. of Students: 10,800 (Local Taiwanese) / No. of International Students: 700
Field of Interest for Collaboration with Universities in Japan	<ul style="list-style-type: none"> ✓ MoU for general collaboration ✓ Industry-academic collaboration ✓ Joint research ✓ Exchange student/faculty ✓ Short-term programs ✓ Mandarin learning programs

19	National Taichung University of Education
Introduction	<p>National Taichung University of Education (NTCU) is a university with proud legacy. Founded in 1899 at the Confucian Temple in Changhwa and relocated to the current site in 1923, the university has prepared not only excellent teachers but also talents in diversified fields, such as court judges, lawyers entrepreneurs, politicians, and engineers.</p> <p>NTCU is an excellent comprehensive university with four colleges. College of Education, College of Management, College of Science, and College of Humanities.</p> <p>The university pursues its mission through erudition and excellence in education and fosters the enrichment and fulfillment of the whole person. Its guiding principles have been "refinement, creativity, and new prospect." It emphasizes on student-centered teaching encompassing scientific and humanistic education and advocates professionalism with critical thinking. Pursuing the goal as the local's best, the nation's leading, and the world's famous university of education, NTCU expects to be excellent because of its students and anticipates its students to be proud of NTCU.</p>
Statistics	No. of Students: About 5,000 / No. of International Students: About 100
Field of Interest for Collaboration with Universities in Japan	<ol style="list-style-type: none"> 1. Joint research 2. Exchange student/faculty 3. Joint/dual degree programs 4. Short-term programs

20	National Taipei University of Business
Introduction	<p>National Taipei University of Business was founded in 1917, located at the central political-academic district of Taipei City, the capital of Taiwan. This prestigious century-old college is an excellent vocational business school that cultivates numberless business leaders in Taiwan. The university specializes in business studies, emphasizes commercial innovative design and practical education. It also actively cooperates with the industry and facilitates students' internships and international exposure.</p>
Statistics	No. of Students: 7,500 / No. of International Students: 282
Field of Interest for Collaboration with Universities in Japan	<p>Exchange student/faculty</p> <p>Summer program</p>

21	National Taiwan University
Introduction	National Taiwan University (NTU) is Taiwan's flagship research institution. Committed to excellence for nine decades, the University has played a constructive role in Taiwan's remarkable transformation into a highly competitive economy and modern society. NTU offers a stimulating, intellectually rigorous environment in which to develop innovative research with strong impact. NTU is placed 1st in Taiwan and 40th in the world for academic reputation (QS World University Rankings 2018).
Statistics	No. of Students: 32,500 / No. of International Students: 4,686
Field of Interest for Collaboration with Universities in Japan	<ul style="list-style-type: none"> • Double/Joint Degree Programs • Graduate Student Co-Supervisions • Academic and Research Collaborations • Student Exchange Activities

22	National Taiwan University of Arts
Introduction	<p>About NTUA:</p> <ul style="list-style-type: none"> • Found in 1955 • Five Colleges: College of Fine Arts, College of Design, College of Communications, College of Performing Arts, College of Humanities • World-Famous alumni: 78th and 85th Oscar-winning director Ang Lee, Golden Lion-winning director Hou Hsiao-Hsien, and other noted musicians, artists and designers such as Wang Tung, Ma Shui-lung, Chu Tzung-ching. <p>Why NTUA?</p> <ul style="list-style-type: none"> • First and oldest arts university in Taiwan • Most comprehensive arts university in Taiwan • Best choice for arts education in Taiwan • Scholarships available for international students • On-campus housing for international students
Statistics	No. of Students: 5,300 / No. of International Students: 300
Field of Interest for Collaboration with Universities in Japan	<ul style="list-style-type: none"> • Partnership Establishment • Student Exchange Program • Joint Exhibition and Performance • Seminar / Workshop / Forum

23	National Taiwan University of Science and Technology
Introduction	The National Taiwan University of Science and Technology, also known as NTUST or Taiwan Tech, was the first higher education institution of its kind within our nation's technical and vocational education system. Taiwan Tech has 6 colleges, including Engineering, Electrical Engineering and Computer Science, Management, Design, Liberal Arts and Social Sciences, and Applied Science. Taiwan Tech has been recognized as one of Taiwan's top universities and is ranked 264th in the QS World University Rankings 2018, 5th in Taiwan; ranked 42nd in 2018 Times Higher Education Asia University Rankings; and 63 Global Employability in the world, the only on University listed at the top 100.
Statistics	No. of Students: 11,019 / No. of International Students: 1,243
Field of Interest for Collaboration with Universities in Japan	<ul style="list-style-type: none"> • MoU for general collaboration • Industry-academic collaboration • Joint research • Exchange student/faculty • Joint/dual degree programs • Short-term programs

24	National Tsing Hua University
Introduction	<p>National Tsing Hua University was established in Beijing in 1911 as "Tsing Hua Academy." In 1956, National Tsing Hua University was re-established at its present location in Hsinchu, Taiwan.</p> <ol style="list-style-type: none"> 1. Ranked 3rd in 2017 Top Universities in Greater China 2. Notable Alumni-3 Nobel Laureates and 1 Wolf Prize Winner 3. The Best Research University in Taiwan 4. 21 Papers Published in SCIENCE (1994-2016), 12 Papers Published in NATURE (1994-2016) 5. Ranked 15th in the world in 2015 Number of U.S. Patents Received 6. 20%of graduates with double major.
Statistics	No. of Students: 16,009 / No. of International Students: 1,207
Field of Interest for Collaboration with Universities in Japan	<p>MoU for general collaboration Industry-academic collaboration Joint research Exchange student/faculty Joint/dual degree programs Short-term programs Mandarin learning programs</p>

25	National Yunlin University of Science and Technology
Introduction	<p>Founded in 1991, National Yunlin University of Science and Technology (YunTech) is a flagship technological university with four colleges, the College of Engineering, College of Management, College of Design, and College of Humanities and Applied Sciences. These four colleges account for 20 undergraduates, 26 master's and 12 doctoral programs. The student population is approximately 10,000, 65 percent of whom are undergraduates and 35 percent post-graduates. Among the distinguished faculty of the university, over 87 percent hold doctoral degrees and 95 percent have reached the position of assistant professor or above. More than 62 percent of the faculty has significant experience in industrial sectors and 50 percent received their doctoral degrees from renowned universities in Europe, the United States and elsewhere.</p>
Statistics	No. of Students: 9,894 / No. of International Students: 457
Field of Interest for Collaboration with Universities in Japan	<ol style="list-style-type: none"> 1. Cross cultural camp 2. Student Exchange Program 3. Faculty Exchange Program 4. Special Short-term Academic Programs 5. Staff Development Projects 6. Joint Research and Activities

26	Providence University
Introduction	<p>Providence University is a Catholic co-educational institution that was founded in 1956 by an American congregation: the Sisters of Providence of Saint Mary-of-the-Woods, Indiana, USA. It is currently sponsored by the Catholic Diocese of Taichung. Providence University is one of the prominent educational institutions in Taiwan, with 23 departments, 19 graduate programs, two Ph.D. programs, 5 EMBA programs, and one Chinese Language Education Center. We have 12,000 undergraduate students, 1,200 graduate students and 400 full-time faculties (all approximate figures). PU offers fully taught English program in International Business Administration, Global Foreign Language Education Program (BBA) and also Graduate International Program (MBA). Students are required to study abroad for one year in IBA program.</p> <p>Currently, we have about 300 partner universities around the world. Meanwhile, we are the only member of ISEP in Taiwan. We now have more than 300 students from Mainland China studying for degree at our university. Those students are highly motivated to study in a reputable university like Vietnam National University. We hope to have the chance to work on fee-paying double degree programs in both undergraduate and graduate levels.</p>
Statistics	No. of Students: approx. 12,000 / No. of International Students: 10%1,200
Field of Interest for Collaboration with Universities in Japan	Business, Japanese Language and Literature, Cosmetic Science, Food Science, Mass Communication, Social Welfare, Tourism, Information Science.

27	Shih Hsin University
Introduction	<p>Shih Hsin is a comprehensive, private, liberal arts university in northern Taiwan that consists of 4 colleges offering 3 doctoral, 24 master's and 22 bachelor's programs.</p> <p>The curriculum of Shin Hsin emphasizes both theoretical knowledge and practical skills, adhering to founder Cheng She-wo's motto "Integrating Theory with Practice." Most of the departments have their own practical training programs which provide internship opportunities on and off campus.</p> <p>The College of Journalism and Communications is long recognized by many as providing the most comprehensive and best quality professional education for journalists in Taiwan. In the past 13 consecutive years, Shih Hsin has also been awarded a Teaching Excellence University by the ROC Ministry of Education.</p>
Statistics	No. of Students: 10,573 / No. of International Students: 628
Field of Interest for Collaboration with Universities in Japan	<p>Journalism and Communications Public Relations & Advertising Study of Radio, Television and Film Information Management Public Policy and Management Tourism Study Study of Japanese Language and Literature</p>

28	Soochow University
Introduction	<p>Soochow University (SU), founded in 1900, is one of the most prestigious private universities in Taiwan. SU has two campuses: the Waishuanghsi campus and the Downtown campus. Both campuses have their own unique cultural and academic resources and distinctive learning environments. The Waishuanghsi campus is located at the cultural axis of Taipei City. Near the National Palace Museum, and the Downtown Campus is located in the administrative and commercial center of Taipei.</p> <p>SU has six schools, 23 departments, and 54 full-time degree programs. The first and only School of Big Data Management in Taiwan was established at SU in 2015. In February 2017, the School of Business acquired AACSB accreditation. SU has also gained recognition as a "Teaching Excellence Program" by the Ministry of Education for 12 consecutive years and was ranked among the top five for private comprehensive universities in Taiwan by the 2018 QS Asia Rankings.</p>
Statistics	No. of Students: 13,566 / No. of International Students: 1,136 (Degree seeking students: 815, Short-term exchange program students: 321)
Field of Interest for Collaboration with Universities in Japan	student exchange, tuition-based, dual degree, Chinese Language learning program and short term program, etc.

29	Southern Taiwan University of Science and Technology
Introduction	<p>STUST was founded in 1969 and located in the beautiful, historic Tainan City. Profoundly emphasizing on practice and application, STUST, a private technical university, currently has more than 17,500 students (the 6th place in Taiwan). STUST has 4 colleges (Engineering, Business, Humanities and Social Sciences, Digital Design). For more information please visit our website: http://www.stust.edu.tw/en/node/Academics</p> <p>International Cooperation</p> <p>STUST has established formal academic relationships with 233 universities in 33 countries. The four colleges at STUST collaborate to invite distinguished scholars from our partner universities to participate in our annual international conferences. In addition, it regularly host scholars from abroad for academic lectures and classroom presentations on our campus.</p>
Statistics	No. of Students: 17,500 / No. of International Students: 800
Field of Interest for Collaboration with Universities in Japan	Engineering/ Information Management/ Business Administration/ Marketing and Logistic Management/ Finance/ International Business/ Accounting Information/ Visual Communication Design/ Multimedia and Entertainment Science/ Creative Product Design/ Popular Music Industry/ Applied English/Applied Japanese

30	Tainan University of Technology
Introduction	<p>Tainan University of Technology was established in 1964. At the beginning of its establishment, it was once named as " Private Tainan Junior College of Home Economics " and was renamed "Tainan University of Technology" on October 1, 2010 after several restructurings.</p> <p>Tainan University of Technology is positioned to develop "a culturally creative technical university" with five colleges such as Living Technology, Management, Design, Arts and Tourism. Our campus, located near the highway interchange, is convenient, beautiful and elegant with harmonious atmosphere. At present, the university has become Taiwan's top cultural and creative university. The university also includes graduate programs, four-year college programs, two-year college programs, seven-year coherent college programs, containing five colleges, six graduate programs, twenty-one departments, and four bachelor's degree programs.</p>
Statistics	No. of Students: 12,304 / No. of International Students: about 100~200
Field of Interest for Collaboration with Universities in Japan	Design 、 Hotel Management 、 Management Related Field 、 Food and Beverage Services 、 Arts 、 Fashion Design

31	Taipei Medical University
Introduction	Established in 1960, Taipei Medical University (TMU) is one of the most reputable universities in Taiwan. Today, TMU has expanded into a world-class university with 11 colleges, 1 General Education Center, 6,000 students per year, 9,000 staff/faculty member, six hospitals, and more than 40,000 alumni around the world. The aims of the educational focus is to train students with humanity, innovation ability and global vision.
Statistics	No. of Students: 6,112 / No. of International Students: 616
Field of Interest for Collaboration with Universities in Japan	Neurosciences Pulmonary medicine Clinical & Translational Cancer Research Artificial Intelligence in Medicine

32	Tamkang University
Introduction	Founded in 1950, Tamkang University now has 4 campuses, 8 colleges with a total of over 26,600 students, providing more than 400 English-taught courses and 12 English-taught degree programs. Tamkang distinguished itself by earning the 19th National Quality Award, received the Outstanding Internationalization Award and the Excellence in International Student Guidance and Counseling Award from the Ministry of Education. Additionally, Tamkang has been listed in the top private university nurturing the "Most Desired University Graduates for Enterprises" in the survey conducted by Cheers Magazine for 20 consecutive years. Tamkang seeks to become a world-renowned comprehensive university by providing students with the most modern learning resources and the global outlook.
Statistics	No. of Students: 26,619 / No. of International Students: 2,054
Field of Interest for Collaboration with Universities in Japan	MoU for general collaboration Industry-academic collaboration Joint research Exchange student/faculty Joint/dual degree programs Short-term programs Mandarin learning programs Summer engineering programs(English-taught and mainly for Japanese students)

33	Tatung University
Introduction	<p>Tatung University (TTU) is a teaching-and research-oriented private university highly recognized for its engineering and management programs. Having developed side by side with Tatung Company, a leading multinational company with annual sales of 10 billion US dollars and 40,000 employees worldwide, TTU has placed a special emphasis on practical and professional learning. Over the years, it has a proven track of success in educating and training talented engineers, business professionals, and industrial leaders.</p> <p>TTU is ranked top 10 Asia-Pacific Univ. in the Red Dot Design Ranking, accredited by IEET and HEEACT, awarded for teaching excellence and excellent in industrial-Academic cooperation.</p>
Statistics	No. of Students: 4,036 / No. of International Students: 120
Field of Interest for Collaboration with Universities in Japan	<ol style="list-style-type: none"> 1. Student and Faculty exchange Program. 2. Work shop 、 Summer camp and Winter camp. 3. Dual degrees -Master program. 4. Joint research

34	Wenzao Ursuline University of Languages
Introduction	<p>REVERE THE DIVINE, LOVE THE HUMAN</p> <p>Wenzao Ursuline University of Languages was founded by Ursuline sisters of the Roman Union of the Order of St. Ursula in 1966. It is a catholic university named in honor of Wenzao Lo, the first Chinese Bishop. Wenzao is the first and the only university of languages in Taiwan.</p> <p>The University has established and maintains collaborative relations with over 250 universities and higher education institutions from 35 countries in Asia, Europe, Oceania and Africa. Collaboration between Wenzao and foreign universities and institutions covers various areas such as exchange of Students and faculty, study visits and research and teaching collaboration.</p>
Statistics	No. of Students: 9,419 / No. of International Students: 428
Field of Interest for Collaboration with Universities in Japan	MOU for general collaboration, Industry-academic collaboration, Joint research, Exchange student/faculty, Joint/dual degree programs, Short-term programs and Mandarin learning programs.

35	Yuan Ze University
Introduction	<p>Yuan Ze University (YZU), was founded in 1989 by the Far Eastern Group and soon became one of the top quality institutions in Taiwan through the utilization of competitive advantages: "Innovation," "Quality," and "Flexibility". These years, YZU was internationally recognized by the Times Higher Education, QS University Ranking, Center for World University Rankings and the AACSB accreditation.</p> <p>YZU offers leading programs in the Colleges of Engineering, Informatics, Management, Humanities and Social Sciences, and Electrical and Communication Engineering. With a high ratio of English-instructed courses in Taiwan, we attract over 1,000 international students pursuing degrees and joining exchange programs.</p>
Statistics	No. of Students: 9,425 / No. of International Students: 1,027
Field of Interest for Collaboration with Universities in Japan	Student exchange, dual degree program, faculty exchange, research collaboration in the fields such as big data and digital convergence, fuel cell, gerontechnology, IoT, environmental technology, Innovation and entrepreneurship.

Japan Side / National Universities

40	Hokkaido University
Introduction	<p>Hokkaido University (HU) was founded in 1876 as Sapporo Agricultural College. In 2014, the Hokkaido Universal Campus Initiative (HUCI) was selected as one of the 13 first-tier Top Global University Projects. A new organization, the Global Institute for Collaborative Research and Education was formed as part of HUCI to strengthen research collaboration between distinguished research groups at HU and world-leading institutions around the world.</p> <p>Under this framework, HU has been promoting cutting-edge research in fields such as quantum medical science and engineering; zoonosis control; food, land and water resources; soft matter; big data and cybersecurity; and arctic research.</p>
Statistics	No. of Students: 18,397 / No. of International Students: 2,172
Field of interest for Collaboration with Universities in Taiwan	<p>Hokkaido University strongly promote educational exchanges with Universities in Taiwan through two international programs, "Learning Satellites(LS)" and "Hokkaido Summer Institute(HSI)" under Top Global University Project. We established LS across the globe from where Hokkaido University's courses can be accessed. Researchers from Hokkaido University are dispatched around the world to partner universities or to locations directly involved with global issues. HSI is a program that brings together leading researchers from around the world, and provides courses in collaboration with HU faculty members.</p>

41	Muroran Institute of Technology
Introduction	<p>Making Dreams Come True Through Creative Science and Technology</p> <p>Taking advantage of the rich natural environment of Hokkaido, Muroran Institute of Technology (MuroranIT) offers a comprehensive science and technology education and engages in creative scientific and technological research in consideration of the balance between humanity, society, and nature. In addition, MuroranIT strives to contribute to developing a knowledge hub linking between regional and international societies in order to create a harmonious society in the future.</p>
Statistics	No. of Students: 3,301 / No. of International Students: 163
Field of interest for Collaboration with Universities in Taiwan	<p>MuroranIT encourages the following two ongoing collaborative research with Taiwanese Universities which the Japanese science and technology policy presses forward as innovative infrastructure solutions in accordance with global needs.</p> <p>1: Society 5.0 (Industry 4.0 in Taiwan) Software-hardware co-design will become more important to tackle problems in the coming Society 5.0 (Industry 4.0 in Taiwan) era.</p> <p>2: Mobile service for Super-aging society Japan and Taiwan both face Super-aging society. IT is important to develop a service platform which can be used by aged person with safety and security.</p>

42	Iwate University
Introduction	Established in 1949 as a national university and inaugurated into an incorporated national university in 2005. Under the slogan of "together with Iwate and its people", the university engages in education, research and social activities centered around local revitalization. The faculties and graduate schools include Humanities and Social Sciences, Education, Science and Engineering, and Agriculture. There are over 5500 students including over 200 international students from over 20 countries, and 750 administration and teaching staff.
Statistics	No. of Students: 5,520 / No. of International Students: 5,564
Field of interest for Collaboration with Universities in Taiwan	<ol style="list-style-type: none"> 1. Exchange of faculty members and research staff 2. Exchange of both undergraduate and graduate students 3. Accepting Master's degree program and Ph.D. students 4. Conducting joint research program in the field of Humanities and Social Sciences, Education, Science and Engineering, and Agriculture, and organizing symposia 5. Exchange of academic materials and publications

43	Akita University
Introduction	At Akita University, we aim to develop human resources who are capable of playing a leading role in 21st century Japan and the international community. To this end, the university's ultimate goal, which applies to all its educational programs, is to cultivate students with rich personal qualities that are underpinned by a wide-ranging education, in-depth expertise and a high level of ethics.
Statistics	No. of Students: 5,025 / No. of International Students: 5,064
Field of interest for Collaboration with Universities in Taiwan	<p>I would like to encourage academic exchanges and student exchange at the four departments of Akita University.</p> <ol style="list-style-type: none"> 1. School of International Resources This is the only department of international resource science in Japan. 2. Education and humanities department School Education Section Area Studies Department 3. Faculty of Medicine Tell tomorrow's knowledge and compassion, and train medical professionals and researchers. Medical school Health Science School 4. Faculty of Engineering Department of Life Sciences Material science Mathematical Science and Electrical and Electronic Engineering Department of System Design

44	The University of Tokyo
Introduction	The University of Tokyo (UTokyo) was established in 1877 as the first national university in Japan. As a leading research university, UTokyo offers courses in essentially all academic disciplines at both undergraduate and graduate levels and conducts research across the full spectrum of academic activity. The University aims to provide its students with a rich and varied academic environment that ensures opportunities for both intellectual development and the acquisition of professional knowledge and skills. UTokyo is known for the excellence of its faculty and students, and ever since its foundation many of its graduates have gone on to become leaders in government, business, and the academic world.
Statistics	No. of Students: 28,523 / No. of International Students: 3,472
Field of interest for Collaboration with Universities in Taiwan	All fields.

45	Tokyo University of Foreign Studies
Introduction	Tokyo University of Foreign Studies (TUFS) is the oldest institution in Japan that is devoted to international studies. It was established in 1873 as Tokyo Gaikokugo Gakko (Tokyo School of Foreign Languages) with 5 language departments. Today, TUFS is an institution taking pride in a comprehensive educational system with 27 language majors grouped into 14 areas.
Statistics	No. of Students: 5,116 / No. of International Students: 729
Field of interest for Collaboration with Universities in Taiwan	The areas in which Tokyo University of Foreign Studies is interested in collaborating with universities in Taiwan are Japan Studies, Japanese-Language Education, Chinese-Language Education, and China Studies.

46	Tokyo Institute of Technology
Introduction	Tokyo Tech is the top national university for science and technology in Japan with a history spanning more than 135 years. In the 21st century, the role of science and technology universities has become increasingly important. Tokyo Tech continues to develop global leaders in the fields of science and technology, and contributes to the betterment of society through its research, focusing on solutions to global issues. The Institute's long-term goal is to become the world's leading science and technology university.
Statistics	No. of Students: 10,000 / No. of International Students: 1,400
Field of interest for Collaboration with Universities in Taiwan	Chemistry, Materials, Electrical and Electronic Engineering, Computer Science, Mechanical Engineering, Civil Engineering, Architecture, Mathematics, Physics, Earth and Planetary Sciences, Transdisciplinary Science and Engineering, Humanities and Social Science, and Life Science and Technology

47	Hitotsubashi University
Introduction	Hitotsubashi University is a national university corporation, and is the only university in Japan to specialize exclusively in the humanities and social sciences. Since its foundation, Hitotsubashi has been at the forefront of Japan's innovation. It has been a powerhouse for generations of Japan's globally active business leaders as well as a research hub producing cutting-edge research in the global academic network of the social sciences.
Statistics	No. of Students: 6,283 / No. of International Students: 858
Field of interest for Collaboration with Universities in Taiwan	We have six strong graduate schools of economics, business administration, law, social sciences, language and society, and international public policy, which equally have interest for collaboration. Recently we concluded several double-degree program agreements in business administration, law, international public policy with the universities including ones in Taiwan. Other graduate schools potentially have interest in DD agreements. Faculty collaboration in such topics as EBPM, Big Data, Health Economy, Global Health, Ageing and Pension will greatly be appreciated.

48	University of Tsukuba
Introduction	<p>The University of Tsukuba (UT) dates back to 1872, making it one of the longest standing institutions of higher education in Japan. UT began as Japan's first normal school. In 1973, it was relocated to Tsukuba Science City and reborn as a comprehensive university. UT has nine schools and seven graduate schools which cover Humanities, Social Sciences, Education, Pure and Applied Sciences, Engineering, Life and Environmental Sciences, Medical Sciences, Library and Information Sciences, Arts and Sports.</p> <p>For detailed information please check the website; https://www.tsukuba.ac.jp/</p>
Statistics	No. of Students: 16,778 / No. of International Students: 2,732
Field of interest for Collaboration with Universities in Taiwan	<ol style="list-style-type: none"> 1. Faculty/ student exchange 2. Joint research program

49	Utsunomiya University
Introduction	<p>Website : http://www.utsunomiya-u.ac.jp/</p> <p>Utsunomiya University's Mission and Vision Utsunomiya University's fundamental mission is to improve the welfare of mankind and contribute to world peace through distinctive high-quality education and research as an institution open to society. To achieve this goal, we have established the following three fundamental policies.</p> <ol style="list-style-type: none"> 1. Utsunomiya University will offer its students a broad, in-depth education, along with practical expertise, so that they can develop the abilities and skills necessary to open new doors to the future. 2. Utsunomiya University will promote top-level research focused on the development of a sustainable society. 3. Utsunomiya University will aggressively expand activities that learn from and contribute to both the local community and the international community. <p>Based on this mission and vision, we have the following educational objectives.</p>
Statistics	No. of Students: 4,979 / No. of International Students: 5,063
Field of interest for Collaboration with Universities in Taiwan	<ol style="list-style-type: none"> 1. MoU 2. Faculty / student exchange 3. Joint research program <p>【Our Partnership Universities as of the end of March, 2018】 National Taiwan Normal University, National Chengchi University, National Taipei University, National Chi Nan University , Lunghwa University of Science and Technology, Feng-Chia University</p>

50	Saitama University
Introduction	<p>"Saitama University, All in One Campus at Metropolitan Area Saitama ? Embodiment of Diversity, Synergy and Integration"</p> <p>Over the past 65 years since its establishment in 1949, SU has grown into a middle-sized national university with 5 undergraduate and 3 graduate schools in the academic fields of Liberal Arts, Economics, Education, Science and Engineering. SU is distinctive by the fact that all the schools are located together on the lush green campus in the city of Saitama, just north of Tokyo. There are many honorable alumni such as Dr. Takaaki. KAJITA, the 2015 Nobel Physics Prize Winner.</p>
Statistics	No. of Students: 8,639 / No. of International Students: 580
Field of interest for Collaboration with Universities in Taiwan	<p>Saitama University has an interest for collaboration in all the academic fields of Liberal Arts, Economics, Education, Science and Engineering, which SU covers, with the following scheme:</p> <ol style="list-style-type: none"> 1. Exchange of faculty and other staff members, 2. Student exchange, especially on the laboratory base, 3. Development of double degree and joint degree programs, 4. Joint research and joint grant application.

51	Chiba University
Introduction	<p>With a proud history of around 150 years, Chiba University is one of Japan's leading national universities. It has 4 campuses, 10 undergraduate schools, 13 graduate schools, and 20 academic centers, as well as one of the largest university hospitals in Japan. Chiba University's primary goal is to contribute to society by developing talented human resources through education and research. As a university that is richly international in character, it has partnership agreements with about 480 top-ranked universities and research centers in 50 countries.</p> <p>Website: www.chiba-u.jp</p>
Statistics	No. of Students: 14,657 / No. of International Students: 973
Field of interest for Collaboration with Universities in Taiwan	<ol style="list-style-type: none"> 1. Faculty exchange (faculty members and researchers) 2. Student exchange based on MoU (Short-term study programs, Double degree programs, etc.) 3. Short program (Various summer/winter programs including "Cool Japan Program") http://www.chiba-u.ac.jp/e/course-program/short-program/summer_program.html 4. Joint research programs including conferences and meeting 5. Center of Community (COC/COC+) Program (This program mainly focusing on regional revitalization by universities.)

52	Yokohama National University
Introduction	Yokohama National University (YNU), located in the historically international city of Yokohama, was established in 1949. Today, it comprises 5 Undergraduate Colleges (Education, Economics, Business Administration, Engineering, and Urban Sciences) and 5 Graduate Schools (Education, International Social Sciences, Engineering Science, Environment and Information Sciences, and Urban Innovation). It has developed into a university with about 1,000 staff and faculty and 10,000 students. YNU has 4 academic agreements with universities and 6 academic agreements with faculties in Taiwan.
Statistics	No. of Students: 9,742 / No. of International Students: 1,011
Field of interest for Collaboration with Universities in Taiwan	<ol style="list-style-type: none"> 1. MoU 2. Student exchange and research collaboration in the field of Economics, Business Administration and Engineering Science 3. Cooperation in Japanese Language and Culture Program 4. Possibility of conducting Double Degree Program

53	Niigata University
Introduction	Niigata University (NU) is a large-scale, comprehensive university blessed with an abundance of nature offering ideal environment for research and education. NU has an enrollment of approximately 12,500 students including about 490 international students, and 3,000 academic and administrative staff members. Areas of excellence range from humanities and social sciences to natural sciences, medical and dental sciences, with 10 faculties, 5 graduate schools, some specialized research institutions, and the University hospital.
Statistics	No. of Students: 12,414 / No. of International Students: 486
Field of interest for Collaboration with Universities in Taiwan	NU already has strong collaborative links with universities in Taiwan in the areas of research and student exchange for programs including Double Degree Program headed by Natural Science and Technology, especially the Faculty of Science and the Faculty of Engineering. Furthermore, NU has been devoted to research and student exchange in the field of Japanese culture and language education offering a semester or a year program, and developed the program for Chinese language and Taiwanese culture learning with the hope for closer collaboration.

54	University of Yamanashi
Introduction	University of Yamanashi plays a key role in formulating solutions to energy and environmental problems on both local and global scale. The Clean Energy Research Center and International Research Centre for River Basin Environment have established the University of Yamanashi as a global center for research in their respective fields. The Institute of Enology and Viticulture, meanwhile, is the only research institution in Japan to specialize in fruit wine?a distinctive local product. The university is also working to promote world-class interdisciplinary researches and developments in areas like developmental engineering, progressive brain science, and medical device development through strong, institution-wide bonds among the medical, engineering, and agricultural fields.
Statistics	No. of Students: 4,728 / No. of International Students: 178
Field of interest for Collaboration with Universities in Taiwan	<ol style="list-style-type: none"> 1. Faculty exchange 2. Student exchange program 3. Short-term academic and culture exchange programs 4. Cooperative master's and doctor's degree programs 5. Joint research 6. Joint workshops

55	Shinshu University
Introduction	Shinshu University is a comprehensive university located in Nagano Prefecture. It is in the middle of Japanese country, a region blessed with abundant natural resources such as natural beauty of Japan Alps mountain range-the Roof of Japan. We have eight faculties (Arts, Education, Economics and Law, Science, Medicine, Engineering, Agriculture, Textile Science and Technology) and besides six graduate schools. We were ranked top overall for 4 years running from 2012 to 2015 in the Nationwide University Local Contribution Survey conducted by Research Institute of Industry and Regional Economy, Nikkei Newspaper.
Statistics	No. of Students: 11,030 / No. of International Students: 317
Field of interest for Collaboration with Universities in Taiwan	Shinshu University has 2 university-level MOU with Taiwan universities, specifically Feng Chia University and Fu Jen Catholic University. We would like to further extend its international collaboration with Taiwan universities. Especially, promote to student exchange with 1 or 2 semesters and recruit to graduate student such as fields of agriculture, engineering and textile science, etc.

56	Kanazawa University
Introduction	Kanazawa University originated in 1862, and became a university in 1949. It aims to be “a research university dedicated to education, while opening up its doors to both local and global society,” and strives to contribute to 1) opening up a new 21st century era, and 2) promoting world peace and the continuous development of mankind. We offer a highly versatile undergraduate program in 16 Schools, in which students are given time to select their specialty while completing general education. Also, we offer seven graduate schools and one united graduate school.
Statistics	No. of Students: 10,222 / No. of International Students: 638
Field of interest for Collaboration with Universities in Taiwan	Kanazawa University aims to expand exchanges with Taiwan, especially student exchanges regardless of the field of study.

57	Japan Advanced Institute of Science and Technology
Introduction	JAIST was founded in October 1990 as the first independent national graduate school, to carry out graduate education based on research at the highest level in advanced science and technology. JAIST aims at developing students with “intellectual toughness” by a world top-level education and research. JAIST, to contribute to societies with research outcomes, creates a center of excellence for advancement of researches for solving problems of our world and society and develops new fields through a variety of basic researches.
Statistics	No. of Students: 1,202 / No. of International Students: 550
Field of interest for Collaboration with Universities in Taiwan	<ul style="list-style-type: none"> - Enhancement of obtaining excellent international students from Taiwan including establishment of double degree program in cooperation with universities in Taiwan - Possible approaches to the issues to be solved for building a double degree program with universities in Taiwan such as difference in credit systems when considering credit transfer between universities in Japan and Taiwan - Enhancement of research collaboration between faculty staff of universities in Japan and Taiwan

58	Shizuoka University
Introduction	<p>One of the leading national universities, at the foot of Mount Fuji:</p> <ul style="list-style-type: none"> - 6 Faculties (Humanities and Social Sciences, Education, Engineering, Agriculture, Science, Informatics), Graduate Schools and 2 Research Institutes (Electronics, Green Science and Technology) with 9,000 UG & 1,600 graduates including 400 students from 30 countries - performing impactful researches and contributing to local communities and industries to actively wrestle with solutions to global problems - in 2018 established a new cooperative major "Medical Photonics", Doctoral course, with Hamamatsu Univ. School of Medicine
Statistics	No. of Students: 10,187 / No. of International Students: 439
Field of interest for Collaboration with Universities in Taiwan	<p>Engineering: Mechanical Engineering, Electrical and Electronic Engineering, Electronics and Materials Science, Applied Chemistry and Biochemical Engineering, and Mathematical and Systems Engineering</p> <p>- Humanities and Social Sciences: Social and Human Studies, Language and Literature, Law and Economic</p>

59	Nagoya University
Introduction	<p>Founded in 1871, Nagoya University (NU) is today one of Japan's leading institutions for high-level research. It is a comprehensive university that includes 13 graduate schools, nine undergraduate schools, three research institutes and 18 research centers. NU is proud to be associated with six of Japan's 14 Nobel laureates since 2001.</p> <p>Nagoya University has offered a select number of full-degree programs taught in English since October 2011. In 2014, it was selected for the Top Global University Project by the Ministry of Education, Culture, Sports, Science and Technology (MEXT). Although its aims are global, NU cooperates closely with regional institutions as an "Asian hub university".</p> <p>In recognition of its potential to engage in world-leading education and research activities, NU was selected as a Designated National University by MEXT in 2018. We therefore are expected to play a leading role in the reform of national Japanese universities, and will continue to make efforts to internationalize alongside other universities and Japanese society.</p>
Statistics	No. of Students: 16,537 / No. of International Students: 2,052
Field of interest for Collaboration with Universities in Taiwan	<p>Nagoya University currently maintains 15 academic exchange agreements with universities and research institutions across Taiwan. The university received 80 Taiwanese academic staff and 123 academic and administrative staff from Nagoya University visited Taiwan during the 2016 fiscal year. There were also 58 international students from Taiwan in 2016 enrolled at NU making them the fifth largest international student community. Similarly, six NU students studied abroad at Taiwanese universities that year. In such ways, Nagoya University aims to continue its fruitful friendships with universities in Taiwan.</p>

60	Toyohashi University of Technology
Introduction	Founded in 1976, Toyohashi University of Technology (TUT) is a vibrant and modern national university with research activities reflecting the modern era of advanced engineering in which it was established. TUT is distinct among national science engineering-orientated universities in a number of ways. Notably, about 80% of our 2,200 students are from 5-year technical colleges, with the majority continuing onto graduate school.
Statistics	No. of Students: 2,100 / No. of International Students: 217
Field of interest for Collaboration with Universities in Taiwan	<ul style="list-style-type: none"> • Collaborative Research • Exchange of teaching staff, researchers and students • Overseas Internship

61	Kyoto University
Introduction	Established in 1897, Kyoto University is the second oldest research-oriented national university in Japan. For over a century, it has advanced cutting-edge education and research in diverse fields. Inspired by its location in the global city of Kyoto, where a unique balance is maintained between tradition and innovation, the university's academic style is characterized by free-thinking, independence, and open-minded dialogue. Its mission is to sustain and develop its historical commitment to academic freedom, and pursue harmonious coexistence within the world's human and ecological community.
Statistics	No. of Students: 22,698 / No. of International Students: 2,214
Field of interest for Collaboration with Universities in Taiwan	Kyoto University has concluded agreements for academic cooperation and student exchange with National Taiwan University (NTU) and National Tsing Hua University, which facilitate an annual exchange of students. The university has also implemented a faculty exchange program with NTU since 2015. Individual faculties and departments of the university are also engaged in research collaboration with many universities and institutions in Taiwan. The collaborations span a wide range of fields, from the humanities and social sciences to physics and engineering/disaster prevention.

62	Kyoto Institute of Technology
Introduction	Kyoto Institute of Technology (KIT) was established about 120 years ago. Located in Kyoto, Japan's former 1000-year capital and now bastion of traditional culture, KIT has established a unique academic environment where wisdom, aesthetic awareness and technological skill are fostered. KIT has been selected for the Top Global University Project funding, with the aim of promoting and expanding globalization. In addition, focused approaches in KYOTO Design Lab, Future Textile Initiative, and Green Innovation programs, bring world-renowned researchers to KIT, opening new horizons for our students.
Statistics	No. of Students: 3,937 / No. of International Students: 238
Field of interest for Collaboration with Universities in Taiwan	KIT accepts students from all over the world in a wide range of engineering and science fields. With Taiwanese universities, exchange has been taking place especially in the fields of Semiconductor, Electronics, Mechanical Engineering, Design and Architecture. In these fields, KIT intends to more actively promote student exchange and lab internships as well as faculty exchange and joint research.

63	Osaka University
Introduction	Osaka University was founded in 1931 as the sixth imperial university of Japan and now has expanded to one of Japan's leading comprehensive universities, composed of 11 schools and faculties, 16 graduate schools and many research institutes and centers. Aware of our social responsibility and by building on our inherited historical legacy, Osaka University has recently presented its "Osaka University Vision 2021." While affirming our fundamental commitment to outstanding research and education, the vision also calls for openness ? internally among departments in the university, and externally through open dialogue and interaction with society. This openness will be the unifying principle of our improvements in the next three years, leading to our 90th anniversary in 2021.
Statistics	No. of Students: 23,288 / No. of International Students: 2,273
Field of interest for Collaboration with Universities in Taiwan	<ul style="list-style-type: none"> • 4 inter-university agreements with National Cheng Kung University, National Taiwan University, National Tsing Hua University and National Chiao Tung University. • 28 inter-faculty agreements with Universities in Taiwan in a wide range of fields • 74 international students from Taiwan in 2015 • 40 students studied in Taiwan in 2014 • 29 Taiwanese scholars in 2014 • 2 Double Degree Programs with Universities in Taiwan; National Taiwan University (College of Law) and National Tsing Hua University (College of Life Science) • More than 20 Joint Research Projects between Osaka University and Universities in Taiwan in Human Sciences, Engineering and other wide ranges of fields

64	Hyogo University of Teacher Education
Introduction	Hyogo University of Teacher Education was established in order to make a contribution to the development of education, academia and culture. The intention was to promote comprehensive research into the theory and application of a wide range of scientific matter related to school education, as well as foster future teachers, with creativity, intelligence and humanity, who can play an important role in culture and society.
Statistics	No. of Students: 1,500 / No. of International Students: 28
Field of interest for Collaboration with Universities in Taiwan	Hyogo University of Teacher Education (HUTE) is one of the excellent national universities in the field of recurrent education of in-service teachers in local schools. So far, several thousand of in-service teachers from various areas in Japan had obtained master degree or professional degree of education in HUTE. In addition to the educational program for new teachers, HUTE also prepare programs to train prospective school principals, vice-principals and educational administration professions to achieve advanced school management abilities. In this context, HUTE already has an international exchange with National Pingtung University, National Taichung University of Education, National Taipei University of Education and National Kaohsiung Normal University. HUTE would like to have further exchange or connection with a university in Taiwan in the field of recurrent education above mentioned.

65	Kobe University
Introduction	<p>Since its foundation in 1902, Kobe University has been dedicated to academic excellence in a broad range of fields from human and social sciences to natural and medical sciences, in the spirit of "integrity, freedom and cooperation".</p> <p>Taking advantage of traditional strengths in both social and natural sciences, we promote interdisciplinary research and education, endeavoring to become an outstanding research university. Through academic exchange with major overseas universities, Kobe University will expand its role as a "hub campus" that attracts researchers and students from across the globe.</p>
Statistics	No. of Students: 15,907 / No. of International Students: 1,296
Field of interest for Collaboration with Universities in Taiwan	As for the academic agreements between universities in Taiwan and us, Kobe University has conducted in the fields of Law, Intercultural Studies, Economics, Business Administration, Medicine, Engineering, Marital Sciences, as well as inter-varsity level, so far. We hope that we expand the fields of cooperation with universities in Taiwan. Therefore, we are interested in considering the following activities in academic and educational fields: 1. Memorandum of Understanding, 2. Faculty/ student exchange, 3. Joint research program, and 4. Short time program, Joint educational program.

66	Tottori University
Introduction	<p>Tottori University is one of the 86 National Universities in Japan. It is a middle-size university with a capacity of about 5,700 students and 2,200 academic and administration staff.</p> <p>Under its motto of "Fusion of knowledge and Practice", the university endeavors to build knowledge that can solve regional as well as global problems through education, research and community service.</p> <p>The University is comprised of four faculties; Faculty of Regional Sciences, Medicine, Engineering and Agriculture. In scientific research, the university excels in dry land science, fungus/mushroom studies and chromosome engineering as applied to medicine and medical treatment.</p> <p>In education, the university puts strong emphasis on developing human resources who can play active roles in a global society and therefore strives to spend more students for studying abroad and to accept more and more international students. We have currently different graduate level programs whereby foreign students can earn degrees by studying in English.</p>
Statistics	No. of Students: 5,728 / No. of International Students: 172
Field of interest for Collaboration with Universities in Taiwan	<ol style="list-style-type: none"> 1. Faculty/Student Exchange 2. Joint Research Program 3. Mou

67	Shimane University
Introduction	<p>Shimane University was established as a national university in 1949 and consists of the Matsue campus and the Izumo campus. On the Matsue campus, we have the Faculty of Law and Literature, the Faculty of Education, the Interdisciplinary Faculty of Science and Engineering, and the Faculty of Life and Environmental Science along with specialized Graduate Courses. On the Izumo campus, we have the Faculty of Medicine and its graduate courses. Shimane University aims to foster students who enjoy international perspectives and can play major roles as leaders in each region of the world by taking advantage of accumulated knowledge, culture, and technologies. Thanks to a high-level curriculum, students are equipped with the ability to cope with diverse problems in modern society. Currently, we have 187 foreign students from various countries, who are working hard to master their specialized fields with Japanese friends and other foreign students, as well as learning Japanese traditions and culture.</p>
Statistics	No. of Students: 6,045 / No. of International Students: 6,134
Field of interest for Collaboration with Universities in Taiwan	<p>Shimane University has collaborated with National Taiwan University in the field of Raman spectroscopy since 2008. We also launched on UNESCO CHAIR in 2017 on Geoenvironmental Disaster Reduction for Improving the Relationship between Geoenvironment and Society, in which a Professor at National Taiwan University is Adjunct Professor. In addition to continuing and expanding the collaboration with Taiwanese Universities in these field, the followings may be the possible fields of collaboration to contribute to solving local problems: studies of tourism and zymology. Shimane is one of the remote areas from metropolitan cities and have serious problems of depopulation. To revive and vitalize the local communities is Shimane University's urgent task. Shimane is the area in which many traditional cultures still remain, such as Shinto shrines, archaeological ruins and traditional rituals. These could become cultural sources for tourism, especially for foreign tourists. The number of Taiwanese tourists who visit Matsue (capital of Shimane) has increased past three years. In order to revitalize local communities by increasing the number of Taiwanese and other foreign tourists, we would like to collaborate with Taiwanese universities in the field of tourism studies. Matsue, capital of Shimane, is the old city with many Japanese sake factories. To develop a new sake that would suit Taiwanese taste and export it could also contribute to local economies. The collaboration in the field of zymology would also be a promising.</p>

68	Okayama University
Introduction	Okayama University is a top-class national university with over 140 years of history. We have 11 faculties, 8 graduate schools and various programs. You can gain a unique learning experience which will positively impact the future success of your academic and professional career.
Statistics	No. of Students: 13,177 / No. of International Students: 685
Field of interest for Collaboration with Universities in Taiwan	<p>Okayama University has agreements of cooperation with universities in Taiwan as follows.</p> <ul style="list-style-type: none"> • Fu Jen Catholic University • National University of Kaohsiung <p>The Graduate School of Humanities and Social Sciences also has agreements of cooperation with:</p> <ul style="list-style-type: none"> • National Chengchi University • Graduate Institute of Japanese Political and Economic Studies, Tamkang University • National Chiayi University, College of Humanities and Arts • National Chung Cheng University, College of Social Sciences, College of Law <p>The Graduate School is engaged in lively faculty and researchers exchange activities with these universities.</p>

69	Hiroshima University
Introduction	Since its establishment, Hiroshima University has always maintained the founding principle of "a single unified university, free and pursuing peace," and with its 12 faculties and 11 graduate schools, it has developed into one of the most distinguished research universities in Japan. Recently, it has been selected as one of the 13 Type A (Top Type) universities (including the University of Tokyo and Waseda University) under the FY2014 Top Global University Project. The university aims "to cultivate peace-pursuing, cultured individuals with an international mindset and a challenging spirit."
Statistics	No. of Students: 15,997 / No. of International Students: 1,745
Field of interest for Collaboration with Universities in Taiwan	<ol style="list-style-type: none"> (1) Exchange of undergraduate and graduate students by educational exchange programs (2) Exchange of faculty members and administrative staff (3) Promotion of joint research (4) Exchange of research outcomes, academic publications, and other academic information

70	Yamaguchi University
Introduction	Yamaguchi University is a national comprehensive university with over 10,000 students in 9 faculties and 9 graduate schools and the third oldest national university in Japan. The local area still holds the spirit of the Meiji Restoration, and the university challenges itself to stand up in the world. The university administration works to adapt to the requirements of the times, constantly pursuing innovation as it works to develop human resources and provide education and research that will contribute to the local community and international society.
Statistics	No. of Students: 10,135 / No. of International Students: 420
Field of interest for Collaboration with Universities in Taiwan	<ol style="list-style-type: none"> 1. Long-term student exchange 2. MOU 3. Joint research in any research field 4. Internship program at companies, etc. in Taiwan

71	Kagawa University
Introduction	<p>Kagawa University, located in Kagawa Prefecture, Western Japan, was established as a national university in 1949. There are currently six faculties that offer courses in Education, Law, Economics, Medicine, Engineering and Design, and Agriculture. In addition, all of these faculties offer opportunities for further studies at the graduate level.</p> <p>We aim to educate students to creative professionals and researchers with a deep sense of humanity through high quality educational activities, and to serve as leaders in the local community in building a symbiotic society.</p>
Statistics	No. of Students: 6,317 / No. of International Students: 188
Field of interest for Collaboration with Universities in Taiwan	<p>[1] Disaster mitigation There are geographical similarities between Taiwan and Japan and both are confronted with the same risks caused by typhoons and earthquakes. Therefore, followings are strong candidates for collaboration,</p> <ol style="list-style-type: none"> 1) Earthquake risk mitigation 2) Typhoon risk mitigation 3) Business continuity and recovery of infrastructure <p>[2] Tourism The Setouchi Triennale was successfully held in 2010, 2013, and 2016. Many foreign artists including Taiwanese artists participated and greatly contributed to it. Great success of the Setouchi Triennale suggests possibilities of activating rural area through excavating hidden cultural and artistic resources that attract tourists. Therefore, followings are strong candidates for collaboration,</p> <ol style="list-style-type: none"> 1) Eco-tourism 2) Rural tourism 3) Art-tourism <p>[3] Community design with IoT in ultra-aging society Aging population is rapidly increasing in both Taiwan and Japan. It is imperative to find a way to re-design our community by integrating internet and artificial intelligence (AI).</p>

72	Ehime University
Introduction	Ehime University is a national university with 10,000 students. There are 7 faculties and six graduate schools covering humanities, education, agriculture, engineering, science, regional innovation and medicine. It prides itself on leading research centers in the areas of geodynamics, environmental pollution, malaria vaccine, the paper industry and aquaculture. It is forming closer relations with local industry in creating new products and new models for urban and rural development. As a student-centered university it provides many activities for students to learn leadership and other skills.
Statistics	No. of Students: 9,534 / No. of International Students: 330
Field of interest for Collaboration with Universities in Taiwan	Ehime University has partnerships with 10 universities in Taiwan with student exchanges in the areas of engineering, global studies, and tourism. We hope to further develop exchange and research in these areas. We also accept more than 20 students from our partners each year as exchange students.

73	Kochi University
Introduction	"University for the Communities" has been one of the top priority missions of Kochi University. Surrounded by communities with rich history, tradition and natural environment, KU enriches its education by learning from communities and benefiting them by returning research results. One of the most outstanding features of KU education is the close interaction between teachers and students with a student-teacher ratio of less than 9:1. Under this circumstance, students can receive practical education from economics to marine science.
Statistics	No. of Students: 5,377 / No. of International Students: 135
Field of interest for Collaboration with Universities in Taiwan	<p>Kuroshio Science; Kochi University has Kuroshio Science Program in the Doctoral Course to research the problems of integrated arts and sciences in the Kuroshio Current regions, the Black Tide. We would like to promote collaboration in this field of Kuroshio Waters Science.</p> <p>Humanities and Medical Sciences; Kochi University has seven sister schools of Taiwan such as National Taiwan University to promote the academic and student exchanges in the fields of history, literature, language and medical science. We hope to promote these exchanges with the universities in Taiwan.</p>

74	Kumamoto University
Introduction	<p>About Kumamoto University Inheriting the Fifth High School founded in 1887, Kumamoto University was established in 1949 under the new National School System.</p> <p>It comprises 7 faculties and 8 graduate schools, as well as 23 research centers and facilities. The university is home to 8,000 undergraduates, 2,000 graduate students and 2,600 faculty members.</p> <p>Kumamoto University is an outstanding research institutes, accepting many international students and contributing to local and international communities.</p>
Statistics	No. of Students: 10,334 / No. of International Students: 1,152
Field of interest for Collaboration with Universities in Taiwan	All fields

75	Kagoshima University
Introduction	<p>Kagoshima University (KU) was established as a national university in 1949. Over the years, KU has developed into one of the leading comprehensive universities in Japan, comprised of 9 faculties and 10 graduate schools, with approximately 9,000 undergraduates, 1,600 graduate students and 300 international students. KU aims to contribute the development of the society and the community with a spirit of the self-sufficiency and enterprise, based on the geographical characteristics of Kagoshima as a part of the Asia-Pacific and according to the principles of academic freedom and diversity.</p>
Statistics	No. of Students: 10,539 / No. of International Students: 300
Field of interest for Collaboration with Universities in Taiwan	<p>Kagoshima University promotes academic research about regional society problems in the fields of islands studies, the environment, food & health, water, energy and disaster prevention research, in addition to international-standard advanced research for infection control and experimental animal models. Kagoshima University will cultivate better relationships with Universities in Taiwan to provide international exchange programs for fostering human resources with global perspectives.</p>

76	University of the Ryukyus
Introduction	<p>The University of the Ryukyus is the only national university located in Okinawa, subtropical area of Japan, and consists of seven faculties and eight graduate schools. Taking advantage of historical background and geographical characteristics of Okinawa, the University of the Ryukyus emphasizes education and research rooted in regional characteristics.</p> <p>The University of the Ryukyus continues to uphold its vision of its future as "an institution with both local and global features that function as an outstanding education and research hub in the Asia-Pacific region."</p>
Statistics	No. of Students: 8,146 / No. of International Students: 306
Field of interest for Collaboration with Universities in Taiwan	<ul style="list-style-type: none"> - Faculty/ student exchange - Educational and research collaboration <p>Distinctive education and research conducted by our university includes:</p> <ol style="list-style-type: none"> 1. Coral reef production and biotechnological resources; 2. Tropical agriculture and biotechnology; 3. Advanced m

Public Universities

77	Future University Hakodate
Introduction	<p>Future University Hakodate fosters innovative learning opportunities in Systems Information Science, which aims, through the integration of multiple disciplines and approaches, to conceptualize, model and design the "systems" based on interpretation of diverse phenomena and processes in real-world in terms of "information."</p>
Statistics	No. of Students: 1,188 / No. of International Students: 13
Field of interest for Collaboration with Universities in Taiwan	<p>Future University Hakodate seeks collaboration opportunities with Universities in Taiwan in both research and education for mutual benefit. Specific interest lies in the field of Computer Science, Artificial Intelligence, Robotics, Design, Active learning and ICT applications to real fields for regional revitalization, including medical care, nursing, fisheries, agriculture, mobility and education.</p>

78	Akita University of Art
Introduction	At Akita University of Art, students take on the creation of new artistic fields unbound by preexisting concepts, in response to the needs of the modern world. We pursue the potential and commonality of art by taking advantage of the cultural resources of Akita, a land blessed by nature and rich traditions, to foster talented individuals who use their artistic sensibilities and creativity to make a difference in Japanese and global society.
Statistics	No. of Students: 430 / No. of International Students: 0
Field of interest for Collaboration with Universities in Taiwan	Fine Arts, Contemporary Art, Crafts, Product Design, Communication Design, Architecture, Landscape Design, Art Management

79	Saitama Prefectural University
Introduction	As a public university, Saitama Prefectural University (SPU) aims to contribute to the local community as the hub for education and research on health and social services. It comprises of the School of Health and Social Services and the Graduate School of Health and Social Services. The undergraduate school consists of five departments: Nursing, Physical Therapy, Occupational Therapy, Social Work and Child Science, and Health Sciences. SPU has been positioning itself to contribute to the promotion of interprofessional work and the development of an inclusive society.
Statistics	No. of Students: 1,769 / No. of International Students: 1,779
Field of interest for Collaboration with Universities in Taiwan	International exchange business

80	Advanced Institute of Industrial Technology
Introduction	Advanced Institute of Industrial Technology was founded in 2006, and began a new era with the offering of the Master Program of Information Systems Architecture, which seeks to equip IT professionals to solve the many issues that industry confronts. In 2008, we started the Master Program of Innovation for Design and Engineering, to give designers and engineers the skills to provide technology as value and to deliver innovation to industries. Our programs are designed for all people who seek to obtain the latest knowledge and outstanding competence in IT and design and engineering.
Statistics	No. of Students: 229 / No. of International Students: 61
Field of interest for Collaboration with Universities in Taiwan	AIIT runs the professional master degree programs that focuses recurrent education in the fields of IT and design-engineering for peoples in industries. Our 60%students are under 40 years old and 40%students are over 40 years old up to 74 years old. Our students join us because of their goal to carrier up, carrier change and start up. AIIT would like to collaborate with Universities in Taiwan in the field of recurrent education for peoples in industries and also pursue the collaborative education by using the project base learning methods between Taiwanese and Japanese student.

81	University of Shizuoka
Introduction	The University of Shizuoka offers a range of courses in fields that address the various needs of modern society, including health, medicine, nursing, globalization, and information society. These five fields of research and education are taught according to particularly stringent academic standards, and students are also offered practical, specialized course curricula. Drawing upon its strengths as a university, the University of Shizuoka makes sure that students of different majors studying in different fields have ample opportunities to interact with each other.
Statistics	No. of Students: 3,099 / No. of International Students: 86
Field of interest for Collaboration with Universities in Taiwan	I am interested in the area of educational and research collaboration between Taiwan and Japanese universities. Especially active exchanges of researchers and students are needed between us. Main focus must be scientific and cultural exchanges. I hope joint degree in both countries.

82	Osaka Prefecture University
Introduction	Osaka Prefecture University (OPU), one of the largest public universities in Japan, is a leading advanced research university. Located in southern Osaka, OPU consists of 4 colleges (comprising 13 undergraduate schools) and 7 graduate schools, distributed across three modern and comfortable campuses: Nakamozu (the main campus), Habikino, and Rinku. It also has satellite campuses in the central Osaka. At each campus, students pursue their academic interests with advanced, cutting-edge facilities under the supervision of assigned faculty members.
Statistics	No. of Students: 7,647 / No. of International Students: 264
Field of interest for Collaboration with Universities in Taiwan	OPU has been expanding its overseas network, especially with Southeast Asia including Taiwan. Our goal is to conduct pioneering research in collaboration with the overseas partner institutions and promote global education through academic collaboration and student exchange such as: <ul style="list-style-type: none"> - Research Collaborations - Faculty Exchange Programs - Student Exchange Programs (Short-term and Long-term) - Double Degree Master/ Doctor Program

Private Universities

83	Aoyama Gakuin University
Introduction	Aoyama Gakuin University, founded in 1949, has established a reputation for the quality of its teaching and its international ambience since its inception and is widely recognized as one of the leading private universities in Japan. In addition to providing specialized knowledge, it cultivates individuals with strong ethics and social values, who actively carry out their responsibilities toward all peoples and communities with a broad perspective on the world and society. Aoyama Gakuin University fosters mutual understanding that transcends the boundaries of nationality, race, and religion, enabling closer connections between people.
Statistics	No. of Students: 19,143 / No. of International Students: 571
Field of interest for Collaboration with Universities in Taiwan	General student exchange and research cooperations in the fields of humanities, social and natural sciences.

84	Asia University
Introduction	<p>Website : http://www.asia-u.ac.jp/ Founded in 1941, Asia University strives to be a place where each student can shine and achieve the motto of "self-help and cooperation", as well as promote societal contributions and community research that ties together the local and the global. We have agreements with 7 universities in Taiwan and have an alumni base of 1000-plus Taiwanese graduates. During the 921 Earthquake, our staff and faculty members dispatched an independent relief team over the course of 3 separate occasions with 135 students, staff, and faculty members. The Asia University America Program (AUAP) has a 30 year history and has sent over 13,000 students to America for 5 month periods. The Asia University Yume College China Program (AUCP) features a one month internship in China, and all participants have had a 100% rate of employability after graduation. In Japan, our university is ranked 3rd in the number of students sent to study abroad. Two years ago, a New Faculty of Urban Innovation started. One of its main points is field work and business internship programs in local and international areas (mainly Asian cities).</p>
Statistics	No. of Students: 6,884 / No. of International Students: 318(4.6%)
Field of interest for Collaboration with Universities in Taiwan	<ol style="list-style-type: none"> 1. MoU 2. Faculty/student exchange 3. Joint research program 4. Sports collaboration (e.g. Baseball) 5. Staff research programs (e.g. Volunteer Activities)

85	Bunri University of Hospitality
Introduction	<p>Bunri University of Hospitality was established in 1999 and consists of the Faculty of Service Management and the Faculty of Nursing. Faculty of Service Management offers the Japan's first 4 years bachelor degree course which puts emphasis on studying management in service and hospitality industries as its field of research. Campus is located in Sayama City, Saitama Prefecture. As Sayama is only 50km northwest from the central Tokyo, and many students live in between, students enjoy opportunities of internships and working experiences in companies and hospitals in the Metropolitan area.</p>
Statistics	No. of Students: 1,406 / No. of International Students: 258
Field of interest for Collaboration with Universities in Taiwan	<p>The objective of my attendance at the said Forum will be as follows: There will be 4 subjects which I am extremely interested in. (1) It will be nice to collaborate with the Universities in Taiwan on the fields of innovative hospitality management and tourism as well as nursing services. Both of the themes might become major fields for the interests between Japan and Taiwan. My university handles these subjects as main course subjects. (2) As an international adviser to the Taiwan e-Governance Research Center in Taipei with National Development Council of the Executive Yuan for many years, I am working on promoting the digital government infrastructure and applications with the Center and my former affiliation with Waseda University. Therefore, this Forum will be vital importance on finding active partnership on the subject such as digital transformation of the societies in Taiwan as world class ICT nation. (3) Also, in my personal academic capability as well as the university is concerned. I am so pleased to establish the new relationship on course wares for conducting the service management with emerging IoT-Big data-AI with relevant Taiwanese universities. These fields might be promising areas to create active collaboration between two countries (4) I hope I will find out some fruitful outcome from this Forum in Hiroshima.</p>

86	Chiba Institute of Technology
Introduction	<p>Chiba Institute of Technology (CIT) was established in 1942 under an imperial ordinance for university establishment to offer engineering education equal in quality to that in Europe and America, and to raise the industrial capability of not just Japan but all of Asia. CIT's prospectus that was clarified by a prominent Japanese philosopher Kitaro Nishida states: "CIT will develop individuals that lead the Japan and the Asia and contribute to world culture." Under this philosophy, CIT opened with our first president Shigenao Konishi—former president of Kyoto Imperial University, Professor Kotaro Honda?former president of Tohoku Imperial University, Professor Hidetsugu Yagi—later president of Osaka Imperial University etc. The philosophy has been passed down to the present as the school philosophy "Contributing to world culture through technology."</p> <p>At the time of our founding, CIT was a university with only 160 students in our first-year classes spread over three departments, Aeronautical, Materials, and Mechanical Engineering. CIT has grown steadily in tandem with the times, and today approximately ten thousand students enrolled in seventeen departments over five faculties, in eight master's and three doctoral degree programs in three graduate schools and five research centres. CIT is a university that not only has traditions but also one that always takes on new challenges and continues to evolve. CIT has gained recognition through its achievements and more than seventy-five years of history as Japan's second oldest university of technology.</p> <p>CIT has provided society with numerous outstanding research achievements. CIT received wide coverage in news programs, newspapers and magazines for robots it developed that were used to investigate the Fukushima Dai-ichi nuclear power plant, since people were unable to enter due to high amounts of radiation and the need to collect large amounts of data. CIT has started monitoring meteor showers from space. The investigation will spend two years recording meteor showers from July 2016 using a special camera installed in the International Space Station (ISS) Window Observational Research Facility (WORF).</p> <p>Furthermore, CIT is a world leader in many research fields, including life sciences and acoustics etc. As a result, CIT is always high in the national rankings of government subsidies allocated for scientific research, an indication of our university's high research standards. CIT will continue to contribute to society through research.</p> <p>CIT is ranked 801-980 in the Times Higher Education World University Rankings 2016/17. The Times Higher Education World University Rankings list the 980 top universities in the world, making it biggest international league table to date. The rankings list CIT as 8th of all 604 Japanese private universities and 39th of all 779 Japanese universities.</p> <p>CIT has enthusiastically collaborated with famous overseas universities for more than thirty-five years. In just the last four years, in fact, we have entered into new international academic exchange agreements with more than twenty-five universities that are in the top ten percent in their countries or regions.</p> <p>CIT have concluded MOU with three Taiwanese universities as follows, National Taipei University of Technology (TAIPEI-TECH) on July 2013, National Taiwan University (NTU) on September 2015 and Tungshai University (THU) on September 2015.</p> <p>We have already invited eight NTU academic stuffs and two TAIPEI-TECH academic stuffs as the invited researcher of CIT international fellowship program, and we have accepted forty-seven TAIPEI-TECH students and eighteen THU students as the exchange student.</p>
Statistics	No. of Students: 9,685 / No. of International Students: 129
Field of interest for Collaboration with Universities in Taiwan	The current interests of Chiba Institute of Technology are wide, encompassing mechanical engineering, electrical/electronic engineering, materials science, communication engineering, applied chemistry, information/computer science, network science, management, project management, finance, robotics, life science, architecture, civil/environmental engineering, design, and space/planetary science etc. We are emphasizing building close relations with preminent Taiwan universities in the fields.

87	Chuo University
Introduction	<p>Established in 1885 as the English Law School, Chuo University was founded by young attorneys who shared the philosophy of "Fostering the Ability to Apply Knowledge to Practice." Over the years Chuo has grown steadily from a specialized School of Law, which continues to produce many of Japan's judges, prosecutors, and lawyers, to a comprehensive university with multiple faculties, graduate schools, professional graduate schools, research institutes, and affiliated high schools and junior high schools.</p>
Statistics	No. of Students: 25,950 / No. of International Students: 802
Field of interest for Collaboration with Universities in Taiwan	<p>We have agreements with 10 universities and research institutions in Taiwan and carries out various exchanges on research and education. In the summer of 2017, Department of Chemistry, College of Science, National Central University and Department of Applied Chemistry, Faculty of Science and Engineering, Chuo University implemented the following two programs:</p> <ol style="list-style-type: none"> 1) Joint workshop at National Central University, Taiwan 2) Japan-Asia Youth Exchange Program in Science, Sakura Science Plan: with 10 students and 1 teacher accepted. <p>As a further development of these exchanges, we decided to open a double degree program at the College of Engineering, the College of Science, the College of Electrical Engineering and Computer Science, and the Graduate School of Science and Engineering at Chuo University. We would like to continue to realize more active exchanges.</p>

88	Doshisha University
Introduction	Doshisha University was established in 1875 by Joseph Hardy Neesima in the heart of Kyoto, an ancient capital of Japan. The educational goal of Doshisha is to foster people as “the nation's conscience,” and pursue the three fundamental educational ideals of Christian principles, liberalism and internationalism. Doshisha University has 14 Faculties, 16 Graduate Schools, and it currently accommodates as many as nearly 29,000 students, including about 2,400 (including short-stay students and semester exchange students, as of the 2017 academic year) international students from around the globe.
Statistics	No. of Students: 29,157 / No. of International Students: 1,424
Field of interest for Collaboration with Universities in Taiwan	Courses offered in English for exchange students Double degree program Joint research

89	Hiroshima Shudo University
Introduction	Hiroshima Shudo University is a private university established in 1960. 6000 students study in 7 faculties & 4 graduate schools. Faculties include the Faculty of Commercial Sciences, the Faculty of Humanities and Human Sciences, the Faculty of Law, the Faculty of Economic Sciences, the Faculty of Human Environmental Studies, the Faculty of Health Sciences, and the Faculty of Global and Community Studies. Fulfilling the slogan ‘a university that makes the region cheerful’ with many regional leaders from 60,000 graduates to date all contributing to the local community from a global perspective.
Statistics	No. of Students: 6,096 / No. of International Students: 79
Field of interest for Collaboration with Universities in Taiwan	At Hiroshima Shudo University, education and research is conducted across a wide range of academic field such as Commerce, Business Administration, Sociology, Education, English Literature, Law, Economics, Psychology, Nutrition, Political Science, Regional Administration and so on. Expanding from our existing relationship with National Pingtung University, we are looking to develop student exchange programs as well as education and research in these areas.

90	J. F. Oberlin University
Introduction	Founded over 95 years ago, J. F. Oberlin University (JFOU) has five undergraduate colleges and six graduate programs with a total student body of 9400. We are located in the Tokyo suburbs. Committed to our mission of fostering global citizens based on Christian values, JFOU seeks to nurture individuals who will be able to understand others and deal with circumstances in a spirit of cooperation, no matter what the situation. JFOU welcomes over 700 international students from 17 countries, and also sends out over 700 students per year on both long-term and short-term programs.
Statistics	No. of Students: 9,424 / No. of International Students: 701
Field of interest for Collaboration with Universities in Taiwan	J. F. Oberlin University is interested in the undergraduate student exchange. Our Exchange & Study Abroad Program is an academic program for exchange students from overseas partner institutions, as well as selected individual applicants. The program offers Japanese language skills and training courses from the introductory to advanced levels. A wide variety of culture and civilization courses on Japan are offered both in Chinese and English each semester. Our outbound students are interested in taking language and academic courses as well as participating in internship programs.

91	Kanagawa University
Introduction	<p>Kanagawa University was founded in 1928 and marked the 90th anniversary in 2018. We have 20,000 students in our 7 undergraduate faculties, 9 graduate schools, and an affiliated junior and senior high school. In addition, we have produced over 220,000 alumni active in every field.</p> <p>Our founding principles are "Simple and Sturdy", "Forward-thinking" and "Balanced and Steady". Based on it, we aim to cultivate every person who can grow by him/herself with judgement, implementing and communication ability, global sensibility and specialized knowledge and skills as a wise self-subsistent citizen.</p>
Statistics	No. of Students: 18,367 / No. of International Students: 374
Field of interest for Collaboration with Universities in Taiwan	Student exchange in the field of science and engineering

92	Kansai University
Introduction	Kansai University places the three mainstays of "Education","Research" and "Social Contribution" as its core objectives. At Kansai University, we encourage our students and faculty members to discover and analyze issues encountered in the course of everyday living, and return the fruits of their findings to the wider community through the promotion of education and research. Our purpose is to nurture talented individuals who are able to play an important role in society, and who can participate at a local and global level with eyes open to the world, and the future.
Statistics	No. of Students: 30,766 / No. of International Students: 1,047
Field of interest for Collaboration with Universities in Taiwan	Law / Letters / Economics / Business and Commerce / Sociology / Policy Studies / Foreign Language Studies / Health and Well-being / Informatics / Societal Safety Sciences / Engineering Science / Environmental and Urban Engineering / Chemistry, Materials and Bioengineering

93	Kansai University of International Studies
Introduction	Kansai University of International Studies (KUIS) was established as a four-year college in 1998, which is going to celebrate the 20th anniversary this year. As befits the name of this institution, partnerships with 51 overseas universities primarily in the Asian-Pacific region have been established. The university has 3 schools (School of Education, School of Human Sciences, and School of Health Sciences) and it is well known as a university with a strong educational component and excellent reputation for designing and developing educational programs, and for the level of learning achievements attained.
Statistics	No. of Students: 2,065 / No. of International Students: 112
Field of interest for Collaboration with Universities in Taiwan	Many earthquakes and natural disasters in recent years, particularly in Japan and Asian countries have led to aspirations for "safety and security" in Asian Region. To meet such demands, KUIS and 14 universities launched the ACP (Asian Cooperative Program) in 2014. The ACP group hopes to collaborate with Taiwan universities in the field of "safety management" for education and research. KUIS is going to launch new department "Department of International communication." According to what the new department needs, we are planning to enhance our current exchange program furthermore. We also hope to expand our partnership in Taiwan.

94	Kansai University of Welfare Sciences
Introduction	<ul style="list-style-type: none"> * Our school philosophy is gratefulness:KAN-ON(感恩). * We aim to nurture people who recognize the value of gratefulness and live in accordance with this philosophy. * We are located in Kashiwara-shi in Osaka. * We comprises 5 faculties with 6 departments(Social Welfare, Psychological Sciences,Health Sciences for Well-being, Nutritional Sciences for Well-being,Rehabilitation Sciences, Education), 1 graduate school(Social Welfare,Clinical Psychology). * We continues to maintain a high graduate employment rate (98%) and the national exam. pass rate.
Statistics	No. of Students: 2,530 / No. of International Students:
Field of interest for Collaboration with Universities in Taiwan	<ul style="list-style-type: none"> * Social Welfare,Clinical Psychology,Psychological Sciences,Health Sciences,Nutritional Sciences,Rehabilitation Sciences(Physical Therapy,Occupational Therapy,Speech-Language-Hearing Therapy),Education * Collaborative research by staffs. * Participation in lectures and practical training. * Improve understanding of foreign cultures, language skills through students exchange program.

95	Kinjo University
Introduction	<p>Kinjo University was established in Hakusan City, Ishikawa, JAPAN in 2000, based on the philosophy 'the development of human resources to lead the welfare society in the future.' Though it started only with Faculty of Social Work, it has grown into a university with 3 faculties and a graduate school: adding Faculty of Health Sciences in 2007, Faculty of Nursing and Graduate School of Rehabilitation in 2015.</p> <p>As a private institution of higher education, Kinjo University develops human resources adaptable to needs for greater sophistication and diversity in the fields of health, medical care, welfare, and education.</p>
Statistics	
Field of interest for Collaboration with Universities in Taiwan	social work/social welfare, health sciences, especially nursing, physical therapy and occupational therapy, and early childhood education.

96	Kobe International University
Introduction	Kobe International University (KIU) provides a comprehensive academic program to prepare its students for professional mind in the fields of economics/business, international culture-oriented business, and physical therapy. Students study under the careful guidance of experienced educators. Moreover, KIU believes in a cross-cultural education as an essential part of contemporary globalized society. For this, it provides variety of cooperative programs and expects all of its students, foreign and domestic, to develop academic curiosities in pursuing knowledge required for their future.
Statistics	No. of Students: 1,559 / No. of International Students: 481
Field of interest for Collaboration with Universities in Taiwan	Kobe International University has currently developed a mutual partnership program with two universities in Taiwan in Japanese Language education and academic field of business/economics. KIU's interest has expanded into furthering an internship program through university partnership.

97	Meiji Gakuin University
Introduction	As one of Japan's oldest universities, Meiji Gakuin University (MGU) traces its origin to a school created by the American medical missionary James C. Hepburn in 1863. Over the course of our long history, MGU has received high praise for the quality of its English language education, and its ethos of "Do for Others." Furthermore, we have a tradition of welcoming students from outside Japan. At present the university has six separate Faculties for undergraduate studies, and a graduate school for advanced training.
Statistics	No. of Students: 12,598 / No. of International Students: 199
Field of interest for Collaboration with Universities in Taiwan	First, we are interested in establishing partnership and start to exchange students, undergraduate and graduate ones. We also welcome to organize research project between Taiwan and Japan; research topics might be Reconciliation Process after the colonial era; as our University has Peace Research Institute and has implemented couple of projects related to Peace building process in diverse aspects as International relations, cultural recognition of minorities and so on. As our University has rich resource of Exchange Program as well, we are willing to develop it more with Taiwanese future partners.

98	Nanzan University
Introduction	Founded in 1946 as a college of foreign languages, Nanzan University's education is expressed in the motto common to all students and faculties; "Hominis Dignitati- for the dignity of all human beings. University enrollment is presently over 10,000, with eight faculties to choose from; The Faculty of Humanities, Foreign Studies, Economics, Business Administration, Law, Policy Studies, Science and Engineering, and Global Liberal Studies.
Statistics	No. of Students: 10,147 / No. of International Students: 231
Field of interest for Collaboration with Universities in Taiwan	As a University with eight faculties, five Graduate Schools; Humanities, International Area Studies, Social Sciences, Science and Engineering, Law along with three Research Institutes; Anthropological Institute, Institute for Social Ethics, and Institute for Religion and Culture, our field of interest for collaboration have been determined variously. From the field of Science and Technology to Humanities, we are constantly open to any opportunities such as research partnership, inter-exchange of students as well as short-term overseas programs with Universities in Taiwan.

99	Osaka University of Commerce
Introduction	Osaka University of Commerce is a private institute for tertiary education, and is a part of the Tanioka Gakuen Educational Foundation. Its origin dates back to 1928, when the Osaka Joto School of Commerce was established. The university was founded in 1949 as the "Joto Vocational University," and the name was changed to the "Osaka University of Commerce" a few years later. Today, the university has three faculties, the Economics, Business Administration and Public Affairs as well as the Graduate School of Regional Policy Studies, with approximately 4,300 students enrolled altogether.
Statistics	No. of Students: 4,244 / No. of International Students: 42
Field of interest for Collaboration with Universities in Taiwan	None

100	Shibaura Institute of Technology
Introduction	"Learn from the world, contribute to the world" - Shibaura Institute of Technology (SIT) has firmly maintained "learning through practice" as the philosophy in education of engineers ever since its establishment in 1927. In response to the recent progress in the globalization of the economy, SIT is providing an up-to-date framework for "learning through practice" including intensive English Language programs, Project Based Learning programs under multicultural environment, along with many Hands-on subjects that has been preserved through SIT's history.
Statistics	No. of Students: 8,837 / No. of International Students: 1,297
Field of interest for Collaboration with Universities in Taiwan	Any field of Engineering and Technology related: Mechanical Engineering, Engineering Science and Mechanics, Materials Science and Engineering, Applied Chemistry, Electrical Engineering, Communications Engineering, Information and Communications Engineering, Electronic Engineering, Civil Engineering, Architecture, Architecture and Building Engineering, Information Science and Engineering, Electronic Information Systems, Machinery and Control Systems, Planning, Architecture and Environmental Systems, Mathematical Science, Engineering and Design

101	Sophia University
Introduction	Sophia University, located in the center of Tokyo, was founded by the Jesuits in 1913, with the mission to build bridges between Japan and the world. It is one of the foremost of Japan's private universities with 9 undergraduate faculties with 29 departments, and 10 graduate schools with 25 programs. It offers various English-medium programs including the Faculty of Liberal Arts, Green Science and Green Engineering, graduate program in Global Studies and Global Environmental Studies. Currently Sophia University has partnerships with more than 320 institutions in 69 countries, and exchanges more than 400 students each year with the partners.
Statistics	No. of Students: 14,021 / No. of International Students: 1,593
Field of interest for Collaboration with Universities in Taiwan	Currently Sophia University has 3 exchange partner institutions in Taiwan: 1) National Taiwan University 2) National Chengchi University 3) Fu Jen Catholic University. Sophia is also a member of the ACUCA (Association of Christian Universities and Colleges in Asia) and conducts student mobility program with seven Taiwanese Universities including Soochow University and Wenzao Ursuline University of Languages since 2012. We are interested in collaborations in short term programs, internship program as well as faculty research collaborations.

102	Tenri University
Introduction	Founded in 1925, Tenri University now boasts over 30,000 alumni who have benefited from its educational goals of enhancing each student's potential, of fostering his or her global awareness, and of instilling in each individual the desire to contribute to the overall improvement of the human condition. Based on the humanistic teachings of the Tenrikyo religion, promoting the world of the "Joyous Life" for all humankind, the University's long history of applying this educational philosophy, in a manner suited to the needs of each generation, is the foundation of its proud tradition.
Statistics	No. of Students: 3,025 / No. of International Students: 120
Field of interest for Collaboration with Universities in Taiwan	We established a partnership with Chinese Cultural University in Taiwan in 1965 as our first overseas partner university, and started exchanging professors between the two institutions. Since then, we have continued the professor's exchange up to the present. Moreover, we started the student's exchange with Chinese Cultural University in 1995. In addition, we increased the number of partner universities in Taiwan gradually, up to seven with most of which we exchange students on a regular basis. Now, we have just started to investigate the possibility of establishing the double-degree program with any university in Taiwan.

103	Tokai University
Introduction	Tokai University is a private university established by Dr. Shigeyoshi Matsumae in 1942. "Tokai" of "Tokai University" refers to the sea to the east of Asia, namely the Pacific Ocean, and symbolizes the desire to foster rich spirits and broad perspectives. Tokai University consists of 8 campuses in Sapporo, Takanawa, Yoyogi, Shonan, Isehara, Shimizu, Kumamoto, and Aso, which are composed of 18 schools and colleges made up of 77 departments, majors, and programs. Its graduate school and professional graduate school offer 48 programs. The total student population is about 30,000. Tokai University maintains academic exchange agreements with more than 131 universities/organizations in 40 countries. A wide range of international exchange activities are being aggressively pursued, from those on the academic front involving students, researchers, joint-research projects, and the exchange of academic resources, to cultural and athletic exchange. There are approx. 900 international students on campus. Tokai University has five offices abroad (Denmark, Vienna, Hawaii, Korea and Thailand.)
Statistics	No. of Students: 29,644 / No. of International Students: 29,714
Field of interest for Collaboration with Universities in Taiwan	Engineering

104	Toyo University
Introduction	In 1887, Enryo Inoue founded the Philosophy Academy, the predecessor to Toyo University, which took on its current name in 1920. In the 130 years since its foundation, the school has successfully grown into a comprehensive university, and has established a variety of academic faculties and graduate school as well as opened new campuses. Currently, Toyo University has grown into one of Japan's most distinguished schools, and possesses 13 faculties with 46 departments and 15 graduate schools with 37 graduate courses, all spread across five campuses.
Statistics	No. of Students: 31,560 / No. of International Students: 111
Field of interest for Collaboration with Universities in Taiwan	<p>Toyo University considers Taiwan as one of our most important academic exchange and research partners. Our formal relationship with Taiwan stretches back to 2000, when Toyo University and Fu Jen Catholic University became partner institutions. It has been a vibrant and fruitful partnership, with Fu Jen sending students to Toyo every year as exchange students and Toyo sending students to Fu Jen for their Summer Academy.</p> <p>Since 2000 our number of Taiwanese partner institutions has grown to eight: Fu Jen Catholic University, Chinese Culture University, Lunghwa University of Science and Technology, Tunghai University, I-Shou University, National Chung Hsing University, Shih Chien University and Wenzao Ursuline University of Languages. With this expansion, the level of student mobility between Toyo and Taiwan has also grown. Three new Taiwanese exchange students arrived at Toyo in April, joining 14 Taiwanese students who are pursuing their degrees at Toyo. Because of a number of initiatives and opportunities, these numbers are sure to increase.</p> <p>In 2014, Toyo University was selected for Top Global University Project by Japan's Ministry of Education, Culture, Sports, Science and Technology (MEXT) to help spearhead the internationalization of Japan's higher education sector. Through the generous grants we receive from this initiative, we have opened a new campus, created new academic departments, significantly increased the availability of English taught courses, and enacted numerous other changes that will make an education at Toyo more attainable for students from Taiwan and around the world.</p> <p>Toyo University was also selected for "Career Development Program for Foreign Students in Japan" administered by MEXT in 2017. Having Japanese business language skills is one of the most significant factors when Japanese companies hire international students. With this program, Toyo University provides a variety of Japanese language classes to international students for free. In addition, Toyo University offers "Business Japanese Language Courses" and an internship program in Shimane and Ishikawa prefecture.</p> <p>In January 2016 Toyo University succeeded Fu Jen Catholic University as International Secretariat of UMAP (University Mobility in Asia and the Pacific), a consortium of government and non-government institutions working to expand student mobility in the Asia-Pacific region. During our five-year term as UMAP IS, Toyo President Makio Takemura will serve as Secretary General, and Japan's Ministry of Education, Culture, Sports, Science and Technology (MEXT) and other organizations in Japan will provide comprehensive administrative support.</p> <p>UMAP IS, in collaboration with the Chairperson of UMAP and the National Secretariats of member countries, manages various study abroad programs (both short-term and long-term), facilitates joint research projects among faculty members from different member universities, and convenes biannual international board meetings. About 30 universities in Taiwan are members of UMAP, and through UMAP we are accepting more Taiwanese exchange students every semester. Without the generous support of the Taiwan government and member institutions in Taiwan, this growth wouldn't be possible. Moreover, the opportunities are poised to expand, as Canada recently joined UMAP, and New York and Hawaii will be joining in 2018.</p> <p>Toyo's ties with Taiwan continue to deepen. The Alumni Association of Toyo University in Taiwan was founded in 2017, and President Maiko Takemura and Prof. Kazuo Takahashi, Vice President for International Affairs attended the opening ceremony in Taiwan. As of April 2018, more than 120 Taiwanese have graduated from Toyo University and about 200 Toyo alumni (including Japanese nationals) live in Taiwan.</p> <p>Attending 2018 Japan-Taiwan University Presidents' Forum in Hiroshima provides Toyo with an opportunity to further strengthen our relationship with Taiwan. We celebrate our history together and look forward to future successes.</p>

105	Tsuda University
Introduction	Tsuda University was founded in 1900 by Umeko Tsuda, a pioneering woman educator, as one of the first institutions of higher education for women in Japan. We are proud that the college has produced scores of distinguished alumnae who, for over a century, have opened up numerous career paths for the generations that followed. Tsuda University continues to pursue the founder's goal of ensuring that students develop in an "all-round" way. Our teachers and staff aim for a maximal development of our students' talents so that they will be able to contribute to society throughout their lives.
Statistics	No. of Students: 3,002 / No. of International Students: 18
Field of interest for Collaboration with Universities in Taiwan	<p><College of Liberal Arts></p> <ul style="list-style-type: none"> • Department of English • Department of International and Cultural Studies • Department of Mathematics • Department of Computer Science • Multicultural Studies/ International Cooperation Course <p><College of Policy Studies></p> <ul style="list-style-type: none"> • Department of Policy Studies <p><International Exchange Programs></p> <p>Promoting Exchange Programs for International Students in Meeting Their Educational and Career Goals.</p>

106	Waseda University
Introduction	Waseda University, a top institution of higher education based in central Tokyo, has 50,000 students in 13 undergraduate and 24 postgraduate schools. It was founded on three principles: academic independence, practical innovation and enlightened citizenship. Waseda's mission is to build leaders, and it does, producing seven prime ministers and countless other leaders in government, business, journalism, science, literature and the arts. Waseda is Japan's most global campus, with about 7,200 international students from around 100 countries, and 806 partnerships with prominent institutions in 92 countries. Currently, Waseda has University-wide Agreements with 16 Universities and Institutions in Taiwan.
Statistics	No. of Students: 50,000 / No. of International Students: 7,200
Field of interest for Collaboration with Universities in Taiwan	All fields

Organizers

Japan Committee of Universities for International Exchange (JACUIE)

The Japan Committee of Universities for International Exchange (JACUIE) is composed of two representatives from each of the three organizations: the Japan Association of National Universities (JANU), the Japan Association of Public Colleges and Universities (JAPU), and the Federation of Japanese Private Colleges and Universities Associations (FJPCUA). Its purpose is to actively respond to the increasing demands from overseas organizations concerning international exchange with Japanese universities.

As a framework of all Japanese universities (national, public and private), its latest main activities are international exchange of ideas between presidents of Japanese universities and those of foreign universities, through organizing joint symposiums and conferences of higher education with university associations overseas.

The Foundation for International Cooperation in Higher Education of Taiwan (FICHET)

The Foundation for International Cooperation in Higher Education of Taiwan (FICHET) is a non-profit organization founded in 2005 and is integrating 4 associations in Taiwan : (1)Association of National Universities of Taiwan (ANUT), (2)Association of Private Universities and Colleges of Taiwan (APUC), (3)Association of National Universities of Science and Technology of Taiwan (U-Tech), and (4)Association of Private Universities and Colleges of Technology of Taiwan (APUCT). Currently, representing 115 member universities, FICHET has been given the responsibility by the government to function as a platform for international cooperation between Taiwanese and foreign universities. Current operations of the foundation include the planning of international educator assemblies (in Europe, America, and Asia) and fostering human resources in the field of international education administration to enhance communication efficiency between various agents working on these platforms.

