

# 2018 Japan-UK



## Dialogue on Exchange in Higher Education & Research

*Monday 29 - Wednesday 31, October*

Challenges in University Governance  
/ Academic Exchange

◆ **Organizer**

The Japan Association of National Universities (JANU)  
Universities UK (UUK)

◆ **Co-sponsored and Support**  
British Embassy Tokyo



国立大学協会  
The Japan Association of National Universities



Universities UK



British Embassy  
Tokyo

2F

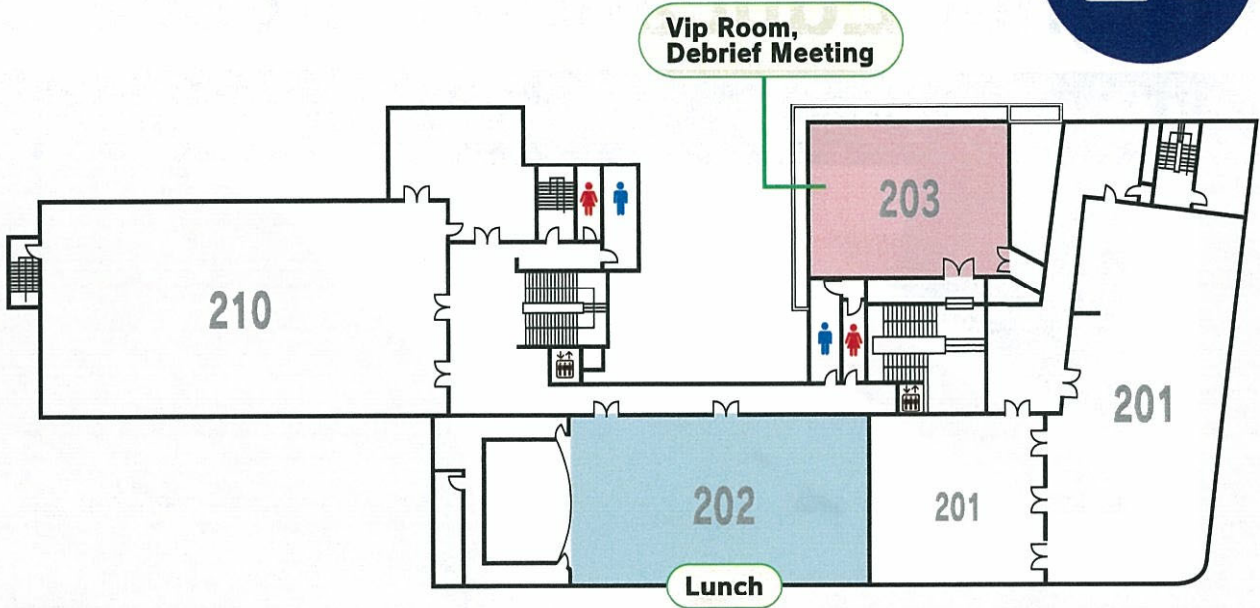

3F

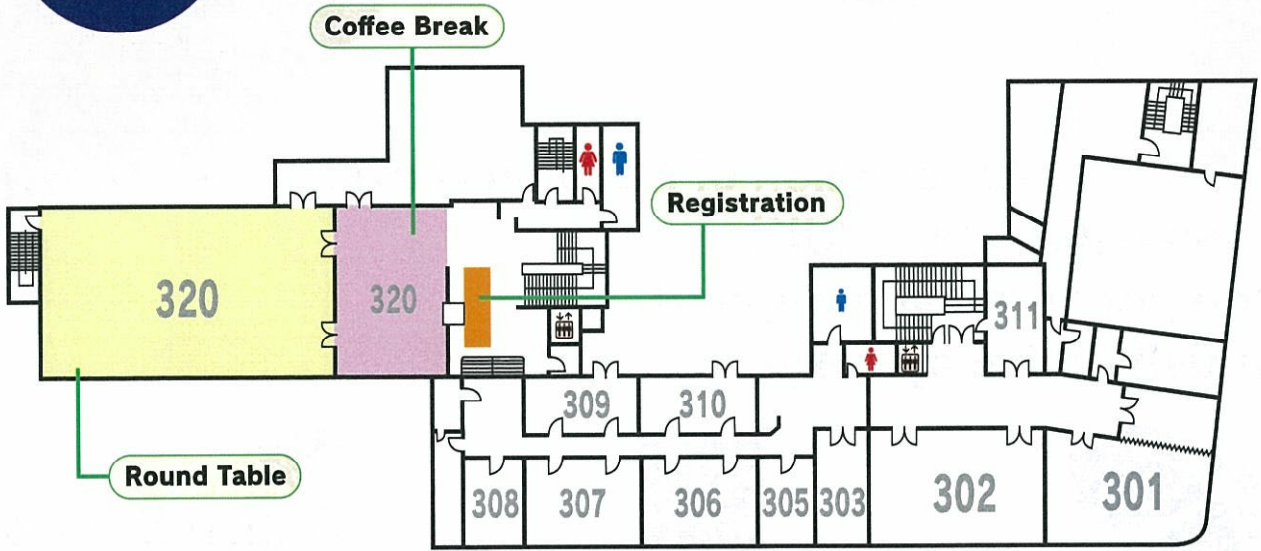

# Contents

---

## **Programme**

P.2-3

## **Biographies MC**

P.4 ... Dr. Masashi Haneda

## **Biographies Opening Remarks**

P.5 ... Dr. Kyosuke Nagata / Ms. Vivienne Stern

P.6 ... Ms. Sue Kinoshita / Mr. Kazuhiko Hayashi

## **Biographies Session one**

P.7 ... Prof. Kiyoshi Ishii / Dr. Koetsu Yamazaki / Prof. David Green

## **Biographies Session two**

P.8 ... Prof. Taraneh Dean / Dr. Kazuya Masu / Dr. Erik Lithander

## **Biographies Session three**

P.9 ... Dr. Noriyuki Inoue / Dr. Masaaki Oka / Prof. Helen O' Sullivan

## **Biographies Closing Summary**

P.10 ... Ms. Vivienne Stern / Dr. Kyosuke Nagata

## **University Introduction**

P.11 ... Hokkaido University / Iwate University

P.12 ... Tohoku University / The University of Tokyo

P.13 ... Tokyo Institute of Technology / University of Tsukuba

P.14 ... Yokohama National University / Chiba University

P.15 ... Niigata University / Kanazawa University

P.16 ... Shizuoka University / Toyohashi University of Technology

P.17 ... Kyoto University / Kyoto Institute of Technology

P.18 ... Osaka University / Kobe University

P.19 ... Hiroshima University / Yamaguchi University

P.20 ... Kyushu University

P.21 ... Keele University / University of Bristol

P.22 ... University of Glasgow / University of Worcester

P.23 ... University of Reading / University of Brighton

P.24 ... University of Leicester / London School of Hygiene and Tropical Medicine

P.25 ... University of Hull

## **Participants List**

P.26-28

## **Note / Organizers**

P.29

### Programme

#### Monday 29 October 2018 Schedule (DAY1)

18:00–19:30	<b>Welcome Reception</b>
-------------	--------------------------

#### Tuesday 30 October 2018 Schedule (DAY2)

9:30	<b>Registration</b>
10:00	<b>Opening Remarks</b> <b>Dr. Kyosuke Nagata</b> , Vice President of JANU, President of University of Tsukuba <b>Ms. Vivienne Stern</b> , Director of Universities UK International <b>Ms. Sue Kinoshita</b> , Minister Counsellor, Economic Affairs of British Embassy Tokyo <b>Mr. Kazuhiko Hayashi</b> , Director for International Analysis, Higher Education Bureau, Ministry of Education, Culture, Sports, Science and Technology (MEXT)
10:30	<b>Session one : Challenges in University Governance and Linkage with Society</b> <b>Moderator : Prof. Kiyoshi Ishii</b> , President of Shizuoka University <b>Speaker : Dr. Koetsu Yamazaki</b> , President of Kanazawa University <b>Speaker : Prof. David Green</b> , Vice Chancellor of University of Worcester Case Study and Discussion (Roundtable Participants) Summation
12:00	<b>Networking Lunch</b>
13:00	<b>Session two : Challenges in Faculty and Staff Mobility</b> <b>Moderator : Prof. Taraneh Dean</b> , Pro Vice Chancellor of University of Brighton <b>Speaker : Dr. Kazuya Masu</b> , President of Tokyo Institute of Technology <b>Speaker : Dr. Erik Lithander</b> , Pro Vice Chancellor of University of Bristol Case Study and Discussion (Roundtable Participants) Summation
14:30	<b>Break</b>

14:45	<p><b>Session three : <i>Challenges in Student Mobility</i></b></p> <p><b>Moderator : Dr. Noriyuki Inoue</b>, Executive Vice President of Kobe University</p> <p><b>Speaker : Dr. Masaaki Oka</b>, President of Yamaguchi University</p> <p><b>Speaker : Prof. Helen O' Sullivan</b>, Pro Vice Chancellor of Keele University</p> <p>Case Study and Discussion (Roundtable Participants)</p> <p>Summation</p>
16:15	<p><b>Closing Summary</b></p> <p><b>Ms. Vivienne Stern</b>, Director of Universities UK International</p> <p><b>Dr. Kyosuke Nagata</b>, Vice President of JANU, President of University of Tsukuba</p>
16:25	<p><b>Group Photo</b></p>
16:40	<p><b>Close</b></p>

### Wednesday 31 October 2018 (DAY3)

10:00	<p><b>University Visit</b></p>
-------	--------------------------------



## Executive Vice President, University of Tokyo

Dr. **Masashi Haneda**

Dr. Haneda is Professor of History at the Institute for Advanced Studies on Asia, the University of Tokyo. He received his B.A. in 1972 and M.A. in 1976 from Kyoto University and obtained his Ph.D. in Iranian studies from the University of Paris III (France) in 1983. He joined the Institute as Associate Professor in 1989 and became Professor in 1997. He was Director of the Institute from April 2009 to March 2012, Vice President of the University of Tokyo (April 2012-March 2015). He is currently Executive Vice President of the University of Tokyo (April 2016-). His current topic of research is on the methodology of global history, finding a new way of describing world history and on cross-cultural exchange at port cities of Asian waters in the eighteenth and nineteenth centuries. He has organized an international network of research and education on global history called the Global History Collaborative along with colleagues in Princeton, Berlin and Paris.



### **Vice President, JANU, President, University of Tsukuba**

**Dr. Kyosuke Nagata**

Dr. Nagata is current President of University of Tsukuba. His major subject areas are virology and molecular biology, studying molecular mechanisms on replication and transcription of viral and host cellular genomes/chromatin, molecular mechanisms on virus multiplication and pathogenicity, and cell cycle control and oncogenesis. He received his Bachelor and Master of Pharmaceutical Sciences and Ph.D. degrees from the University of Tokyo. After graduation, he became a research associate at Albert Einstein College of Medicine and a research fellow at Memorial Sloan-Kettering Cancer Institute. He then became an assistant professor at National Institute of Genetics, and an associate professor at Tokyo Institute of Technology before becoming a professor at University of Tsukuba and the Vice President of the Japan Association of National Universities.



### **Director, Universities UK International**

**Ms. Vivienne Stern**

Vivienne is the Director of Universities UK International (UUKi). Universities UK International helps UK universities and higher education institutions engage with international partners, and represents their distinctive strengths and interests overseas. Prior to her role in UUKi, Vivienne was Head of Political Affairs at Universities UK where she was responsible for developing and implementing the political strategy for the membership body representing 134 UK Universities. She previously worked at the UK Parliament for the Chair of the Education and Skills Select Committee. She is a graduate in English Literature from the University of Cambridge.



### **Minister Counsellor, Economic Affairs, British Embassy Tokyo**

Ms. **Sue Kinoshita**

Sue Kinoshita is Minister Counsellor for Economic Affairs at the British Embassy in Tokyo. Sue graduated from University of Manchester Institute of Science and Technology. Most recently Deputy Head of Mission and Director Trade & Investment at the British Embassy in Seoul, Sue joined the Foreign and Commonwealth Office in 1983, and completed 2 years' full time Japanese language training. Since then, she has completed 4 tours of duty in Japan; 1986-89 Working on trade policy at the British Embassy in Tokyo 1996-99 Export promotion as Consul Commercial at the British Consulate-General in Osaka 1999-2003 Press and Public Affairs Officer in Tokyo 2010-2015 Director of Trade and Investment for Japan Sue has also worked on EU accession issues, HR and Finance roles in the FCO. From 2007-2010, she was Consul-General and Corporate Services Director at the British Government Offices in Geneva.



### **Director for International Analysis, Higher Education Bureau, Ministry of Education, Culture, Sports, Science and Technology (MEXT)**

Mr. **Kazuhiko Hayashi**

Mr. Hayashi received his Bachelor of Law degree from Osaka University and Master of Arts in Higher Education Administration degree from J. F. Oberlin University. After graduation, he was employed as an official of the Ministry of Education, Science and Culture (in 2001 the ministry changed its name to MEXT). Recently he engaged in higher education and science, such as Director General of Tokyo University of Agriculture and Technology, Senior Director of Hokkaido University, Professor of Assessment Office of Kyushu Institute of Technology and Senior Director of Japan Science and Technology Agency (JST). Now he engages in research and analysis of international policy and activities of Universities of Japan.

### Moderator



### President, Shizuoka University

Prof. **Kiyoshi Ishii**

Professor Ishii, current President of Shizuoka University, is majoring in philosophy, especially focusing on Enlightenment thought in modern European intellectual history. He received his Bachelor and Master degrees of Literature from the University of Tokyo and also finished doctoral course there. After graduation, he became an assistant professor of the Faculty of Education of Shizuoka University and then got his professorship via some subordinate positions there. Before becoming President of Shizuoka University, he experienced some management positions such as Dean of the Faculty of Education and Trustee/Vice President in charge of Educational and Affiliated School Affairs at the same university.

### Speaker



### President, Kanazawa University

Dr. **Koetsu Yamazaki**

Dr. Koetsu Yamazaki became the President of Kanazawa University in April 2014. Prior to this post, he served as the Professor of Mechanical Engineering, Dean of the College of Science and Engineering and Faculty of Engineering, and the Vice President for Research and International Affairs. Dr. Yamazaki graduated in 1974 with a BS in Mechanical Engineering and received his Master of Engineering in 1976 from Kanazawa University. In 1983, he was awarded his Ph.D. in Engineering from Osaka University. His major research areas are in the strength of material, design engineering, and computational mechanics. His recent research interests are structural optimization (response surface approach, multi-objective design optimization), optimum design and bionic design.

### Speaker



### Vice Chancellor, University of Worcester

Prof. **David Green**

Highly effective, charismatic institutional leader. Insightful strategic thinker with proven capacity for successful innovation. Skilled partnership builder with strong influencing skills. Experienced and effective board member of national organisations. High level commercial acumen. Clear, compelling communicator through the media and in person. Influential national voice on higher education. Influential international voice on inclusion. Dynamic, resilient, successful campaigner.

**Education** BA in Economics (2:1) St, John's College, University of Cambridge 1973; MA awarded 1977.

**Principal Achievements at the University of Worcester Led the University of Worcester to:** Earn Full University Title (2005) ; Earn Research Degree Awarding Powers (2010) ; Become the most improved UK University for Research Power (2014 REF) .

### Moderator



### Pro Vice Chancellor, University of Brighton

Prof. **Taraneh Dean**

Professor Dean is a Professor of Health Sciences who is an internationally recognised authority in the area of epidemiology of allergic disorders. In 1996, she helped establish the internationally-recognised Asthma and Allergy Research Centre on the Isle of Wight. During her time at the Allergy Centre, she led on a number of seminal cohort studies focusing on epidemiological aspects of asthma and allergy. She held number of senior posts and prior to joining Brighton was Dean of Science, University of Portsmouth. She joined University of Brighton in 2016 as Pro-Vice-Chancellor (Research and Enterprise) and has the strategic lead for all research and enterprise activities. She has led on the development of University's Research and Enterprise Strategic Plan 2017-2021. She takes the lead role on preparing and the delivery of actions to enhance the University's position in REF2021. As a member of the University Executive Board and the Strategic Planning group, she contributes to the broader leadership and direction of the University. She is responsible for the Brighton Doctoral College and works closely with its Director to enhance the postgraduate research (PGR) student experience. In 2017, she was appointed as the Doctoral Training Alliance National Director for the University Alliance (a mission group of 18 universities in UK are sectors leading in technical and professional education). She is passionate about promoting women in STEM, and mentors a number of female STEM academics at universities in the UK. Professor Dean is the Gender Equality champion for the University and leads on Athena Swan at the University of Brighton.

### Speaker



### President, Tokyo Institute of Technology

Dr. **Kazuya Masu**

Kazuya Masu has served as the 22nd president of Tokyo Tech since April 1, 2018. A specialist in electronic devices, integrated circuits, and wireless sensor networks, Masu earned his bachelor's, master's, and doctoral degrees in engineering from Tokyo Tech. After graduation, he became an assistant professor at the Research Institute of Electrical Communication at Tohoku University, where he was later appointed associate professor. Masu returned to Tokyo Tech in June 2000 as a professor at the Precision and Intelligence Laboratory. In late 2002, he also served as a visiting professor at Georgia Institute of Technology in the U.S. Masu subsequently held professorial positions at Tokyo Tech's Integrated Research Institute, the Solutions Research Laboratory, and the Frontier Research Center. For the two years prior to his inauguration, Masu served as the first director-general of the Institute of Innovative Research, the integrated hub for Tokyo Tech's diverse research centers, laboratories, and units.

### Speaker



### Pro Vice Chancellor, University of Bristol

Dr. **Erik Lithander**

Dr Erik Lithander joined the University of Bristol in the role of Pro Vice-Chancellor (International and Student Recruitment) in February 2016. Prior to joining The University of Bristol, Erik spent three years as Pro Vice-Chancellor (International and Outreach) at the Australian National University in Canberra, and six years as Director of International Affairs at University College Dublin, Ireland's largest university. He has also held the role of Associate Director (International Relations) at the University of Auckland in New Zealand. Originally from Sweden, Erik holds a Candidature in Political Science from Université Libre de Bruxelles in Belgium, a BSc (Econ) from the London School of Economics, and an MPhil and PhD from the University of Cambridge, where his research focus was on contemporary Latin American literature. He is an alumnus of the executive education programme at the Wharton School of the University of Pennsylvania and of the LH Martin Institute's "Leading Universities" programme, based at the University of Melbourne. The Pro Vice-Chancellor (International) provides strategic leadership on matters relating to internationalisation, student mobility, marketing, public affairs, communications, student recruitment alumni relations and development at the University of Bristol.

### Moderator



### Executive Vice President, Kobe University

Dr. **Noriyuki Inoue**

Executive Vice President in Charge of International Exchange and Internal Control and Professor in the Graduate School of Law, Kobe University, Japan. Awarded MSc and PhD from Osaka University, Japan in 1985 and 1996, respectively. After working for Osaka Gakuin University as assistant and associate professor, joined Kobe University as an academic member in 1995. From October 2009 to September 2011, worked as the Dean of the Graduate School of Law, and from April 2013 as the Executive Vice President of Kobe University in Charge of International Exchange and Internal Control. His research focuses on Constitutional Law and European Law.

### Speaker



### President, Yamaguchi University

Dr. **Masaaki Oka**

Dr. Masaaki Oka, a specialist in surgery of digestive disease and surgical oncology/immunology, has served as the president of Yamaguchi University since April 2014. He received his undergraduate degree in 1976 from Yamaguchi University and Doctor of Medicine in 1981 from Yamaguchi University Graduate School of Medicine. At Yamaguchi University where he started his career in 1981, he was also a research fellow of Creighton University in Nebraska, U.S.A. from 1988 to 1989. He held faculty appointments as a professor of Faculty of Medicine and Health Science in 1996 and a professor of Graduate School of Medicine in 2006. He has extensive academic and clinical experience, having held research, lecturing and leadership positions throughout his career. His past posts include Director of Yamaguchi University Hospital (YUH) and Director of YUH Oncology Center.

### Speaker



### Pro Vice Chancellor, Keele University

Prof. **Helen O'Sullivan**

Professor Helen O'Sullivan became Pro Vice-Chancellor for Education at Keele on 1st January 2018. She was previously Associate Pro Vice-Chancellor for Online Learning at University of Liverpool, where she had responsibility for all aspects of online and technology enhanced learning. As PVC, she takes strategic leadership for education and is currently interested in expanding the Keele community through developing PGT, online and transnational education. Helen graduated in molecular biology at the University of Liverpool before taking a PhD in bacterial genetics. After a post-doctoral fellowship at Liverpool, she moved to a lectureship in Biological Sciences at what is now Liverpool Hope University. Helen moved to University of Liverpool in 2006 to lead the Hefce funded Centre for Excellence in Teaching and Learning. The work of the Centre helped to shape how medical professionalism is taught across medical schools in the UK and internationally and during this time, Helen set up the UK Council for Teachers of Professionalism. Her research focuses on the role of emotional intelligence in developing professionalism and leadership in doctors and she holds a personal chair in Medical Education. Her current external activities include membership of UUK International's HE Global Advisory Board and of the Jisc Horizon Group.



**Director, Universities UK International**

Ms. **Vivienne Stern**

---

Please see P.5.



**Vice President, JANU,  
President, University of Tsukuba**

Dr. **Kyosuke Nagata**

---

Please see P.5.

## Hokkaido University

---

Hokkaido University (HU) was founded in 1876 as Sapporo Agricultural College, the first modern academic institute in Japan. HU currently has 12 undergraduate schools and 21 graduate schools. We are also a research-intensive university and have 24 research centers or institutions. HU educates new generations of societal leaders with insight and a broad outlook through its liberal arts educational programs and with problem-solving abilities through its specialized educational programs. In addition, we established a new organization, "the Global Institution for Collaborative Research and Education (GI-CoRE)", as a faculty organization that brings together world-class teaching staff from around the world and within the University in fields such as quantum medical science and engineering; zoonosis control; food, land and water resources; soft matter; big data and cybersecurity; and arctic research.

HU also strongly promotes educational exchanges with Universities around the world mainly through two international programs, "Learning Satellites (LS)" and "Hokkaido Summer Institute (HSI)".

The HSI is a program that brings together world-leading researchers with proven educational and research records and provides educational courses in cooperation with HU faculty members. The HSI offers more than 100 courses mainly from June to August and allows more than 400 students from overseas universities and 1,100 HU students to expand their knowledge of subjects in research fields in which the university specializes.

The LS were established to offer courses to students from HU and overseas universities in line with its vision of becoming an institution that contributes to the resolution of global issues. By offering various programs around the globe that allow students from HU and from countries beyond Japan to learn together, this project aims to nurture talented individuals who are capable of contributing to the resolution of global issues and aims to promote collaboration between faculty members at HU and overseas universities in order to internationalize and enhance the quality of HU educational programs.

**Address** Kita 8 Nishi 5 Kita-ku, Sapporo, JAPAN, 0600808

**Phone** +81-11-706-4410

**e-mail** [global@oia.hokudai.ac.jp](mailto:global@oia.hokudai.ac.jp)

**website** <https://www.global.hokudai.ac.jp/>

## Iwate University

---

Located in the prefectural capital Morioka, Iwate University is known for being the alma mater of the famous author and poet, Kenji Miyazawa. The university's main missions are: Disaster Recovery-Vitalization of Local Areas, Development of Global Human Resources, and Fostering Innovation. To this effect, Iwate University has become known as a leader for recovery of areas affected by the Great East Japan Earthquake in 2011. Thus, it is a "locally-oriented university," contributing to a sustainable local community.

Iwate University was founded in 1949 with the Faculties of Liberal Arts, Engineering, and Agriculture, and continues to grow to this day. As of April 2016, our four undergraduate faculties have been reorganized into Humanities and Social Sciences, Education, Science and Engineering, and Agriculture, with a master's program in each Faculty. These programs were integrated into the Graduate School of Arts and Sciences in April 2017, offering divisions in Interdisciplinary Cultural Studies, Regional Development and Creativity, Science and Engineering, and Agriculture. The university also offers a doctoral program in the Faculty of Engineering, the United Graduate School of Agricultural Sciences and the Graduate School of Veterinary Sciences.

In addition, we have many interdisciplinary departments and affiliated institutions to support our academic activities, such as the Center for Teaching, Learning, and Career Development (Global Education Center); Super-Computing and Information Sciences Center; and Health Administration Center.

**Address** 3-18-8 Ueda, Morioka, Iwate 020-8550 JAPAN

**Phone** +81-19-621-6006

**e-mail** [ssomu@iwate-u.ac.jp](mailto:ssomu@iwate-u.ac.jp)

**website** <https://www.iwate-u.ac.jp/>

## Tohoku University

Tohoku University is a research-oriented university located in Sendai. Established in 1907, it was the first Japanese university to accept female students. Tohoku University is one of Japan's leading universities, with 10 faculties, 15 graduate schools, 3 professional graduate schools, 6 research institutes, a hospital and affiliated research and education centers. It has academic exchange agreements at university level with 227 institutions, and at department level with 497 institutions in 60 countries and regions. It maintains 18 offices in 11 countries and regions. The number of students is approximately 18,600 including 2,100 international students.

Tohoku University aims to become a university that is respected around the world for excellence in both education and research. In education, we founded the Institute for Excellence in Higher Education in April 2014, as we address the necessity of creating a GPA and course numbering system. Further, we are continuing to promote the "Tohoku University Global Leader Program (TGL)" and are improving the study environment for increasing student mobility. In research, we aim to enhance the quality of support for our young researchers. Further, through our international visitor research institute "Tohoku Forum for Creativity," we allow our young researchers to engage in exchanges with researchers from overseas. These efforts, which were highly evaluated by the Ministry of Education, Culture, Sports, Science and Technology (MEXT), led TU to be named a Designated National University, one of the first three universities to be selected under this new system by the Japanese Government in June 2017.

Tohoku University has 6 university-level agreements and 14 department-level agreements with institutions in the UK. In addition, as a founding member of "RENKEI", a consortium of universities which promotes collaborative research between the two countries in higher education and industry, Tohoku University actively promotes international academic collaboration.

**Address** International Exchange Division, Tohoku University 2-1-1 Katahira, Aoba-ku, Sendai, Miyagi, 980-8577 Japan  
**Phone** +81-(0)22-217-5019  
**e-mail** kokusai-r@grp.tohoku.ac.jp  
**website** <https://www.tohoku.ac.jp/en/>

## The University of Tokyo

The University of Tokyo (UTokyo) was established in 1877 as the first national university in Japan. As a leading research university, UTokyo offers courses in essentially all academic disciplines at both undergraduate and graduate levels and conducts research across the full spectrum of academic activity. The University aims to provide its students with a rich and varied academic environment that ensures opportunities for both intellectual development and the acquisition of professional knowledge and skills.

UTokyo is known for the excellence of its faculty and students, and since its foundation, many of its graduates have gone on to become leaders in government, business, and academia.

Currently, UTokyo is comprised of 10 Faculties, 15 Graduate Schools, 11 affiliated research institutes (including the Research Center for Advanced Science and Technology), 13 University-wide centers, three affiliated libraries and three institutes for advanced study. Furthermore, the Faculties, Graduate Schools and research institutes have facilities associated with them; for instance, the University of Tokyo Hospital is one such facility.

In addition to the three main campuses of Hongo, Komaba and Kashiwa, facilities affiliated with UTokyo are spread throughout Japan.

[The University of Tokyo's Mission]

The University of Tokyo strives to be a world-class platform for research and education, contributing to human knowledge in partnership with other leading global universities. UTokyo also aims to nurture global leaders with a strong sense of public responsibility and a pioneering spirit, and encourages the development of both highly specialized and broad knowledge. In addition, UTokyo endeavors to expand the boundaries of human knowledge in partnership with society.

**Address** 7-3-1 Hongo, Bunkyo-ku, Tokyo 113-8654 JAPAN  
**Phone** +81-3-3812-2111  
**e-mail** intl-project.adm@gs.mail.u-tokyo.ac.jp  
**website** <https://www.u-tokyo.ac.jp/en/index.html>

## Tokyo Institute of Technology

---

Founded 137 years ago, Tokyo Institute of Technology (Tokyo Tech) continues to develop global leaders in the fields of science and technology and contribute to the betterment of society through its research, focusing on solutions to global issues. In March 2018, Tokyo Tech was selected for Designated National University Corporation status by the Japanese government.

The Institute's three campuses are home to about 10,000 students and 1,200 faculty members. Student enrollment is almost equally divided between undergraduates and graduate students, and the university is host to a growing number of international students, who comprise approximately 12% of the total student body.

Tokyo Tech has been implementing ambitious reforms in its education and research systems with the aim of providing a world-class environment for learning and innovation. In 2016, Tokyo Tech became the first university in Japan whose schools offer undergraduate and graduate programs under the same roof, creating more opportunities for cross-disciplinary research and earlier involvement in graduate-level study.

Research laboratories at Tokyo Tech are organized under the Institute of Innovative Research (IIR). This open research environment is intended to foster active and organic cooperation within and beyond the university, thereby creating novel research fields, offering solutions to complex problems, and fostering future industrial infrastructures. Research at the IIR builds on Tokyo Tech's internationally recognized contributions in key areas, including materials science, supercomputing, and life sciences.

Tokyo Tech currently has formal cooperation agreements with 11 UK universities and research institutions.

**Address** 2-12-1 Ookayama, Meguro-ku, Tokyo 152-8550

**Phone** +81-3-5734-2982

**e-mail** Kokuren.kik.cho@jim.titech.ac.jp

**website** <https://www.titech.ac.jp/english/>

## University of Tsukuba

---

Located in the heart of Tsukuba Science City, Japan's premier science city, the University of Tsukuba is a leading national research-oriented university. Surrounded by nearly 300 research institutions, the university aims to nurture global leaders and promote research that can contribute to the resolution of the global challenges that we face today through transdisciplinary and trans-organizational efforts and initiatives. The university has the second most number of international university-industry collaborations in Japan.

With roots extending back to 1872, when it was established as modern Japan's first national institute of higher education, the university was reborn in 1973 as the University of Tsukuba with the founding philosophies of fostering transdisciplinary research and education and being open to society, which are now more important than ever in today's environment of accelerating complexity and interconnectivity. With this in mind, the university is promoting the sharing of research and educational resources through its campus-in-campus initiative, a platform for global cooperation.

With the university's history of involvement in the Japanese Olympic Movement stretching back over 100 years, the University of Tsukuba has been a driving force in Japanese sports and sport science. We established the Tsukuba International Academy for Sport Studies as part of the Japanese government's "Sport for Tomorrow" education program for the 2020 Tokyo Olympic and Paralympic Games.

The university was ranked second among Japanese universities in the "World's Most International Universities 2017" list published by Times Higher Education. Having the largest percentage of international students, we have also attracted a large number of U.S. students with our more than 50 degree-seeking programs taught in English.

We have been actively developing research and academic collaborations with U.K. universities in the fields of sports science (Loughborough University), life and environmental sciences (University of Plymouth, University of Manchester, and University of East Anglia), and medicine (University of Edinburgh). Student exchange agreements have also been signed with Oxford Brookes University, University of Northumbria, and the University of Sheffield. We are continuing to develop our global platform for research and education by breaking down all barriers and re-envisioning research-oriented higher education.

**Address** 1-1-1 Tennodai, Tsukuba Ibaraki 305-8577

**Phone** +81-29-853-2056

**e-mail** kokusaika@un.tsukuba.ac.jp

**website** <https://www.tsukuba.ac.jp>

## Yokohama National University

YNU was established in 1949 with a history of its original foundation in 1876 as a normal school. Today, it comprises 5 Undergraduate Colleges (Education, Economics, Business Administration, Engineering, and Urban Sciences) and 5 Graduate Schools (Education, International Social Sciences, Engineering, Environment and Information Sciences, and Urban Innovation). It has developed into a university with about 1,000 staff and faculty and 10,000 students.

Based on sixty years of history and tradition, YNU is highly internationalized, as it respects and strives to respond to the needs of society across the globe by integrating multi-disciplinary and cross-border knowledge. The university is determined to provide practical knowledge to its students and to administer research and education with the aim of becoming a university that is more accessible to society and eagerly welcomes new challenges. Located in the historically international city of Yokohama, YNU has been dedicated to a global perspective and has concluded International Exchange Agreements with 137 universities and institutions in 42 countries and regions. Among them, YNU has 6 academic agreements with universities and 1 academic agreement with faculties in UK. Currently, there are approximately 1,000 international students from 70 countries and regions enrolled at YNU.

YNU established 6 international branches to strengthen international exchange and form an international joint research base. YNU also established 7 international liaison offices for education, research and alumni association activities abroad. YNU will continuously strive to be a vibrant educational hub with a diverse student body, and will continue to disseminate world-class educational and research achievements to create a better future.

**Address** 79-1 Tokiwadai, Hodogaya, Yokohama, Kanagawa, 240-8501 JAPAN

**Phone** +81-45-339-3036

**e-mail** kokusai.kikaku@ynu.ac.jp

**website** <http://www.ynu.ac.jp/english/index.html>

## Chiba University

Chiba University was founded about 140 years ago, and has been taking great effort to provide the best curriculums and environment, as well as conducting world level research in upgrading the university status. Based on the University Charter, "Always Aim Higher", Chiba University will foster human resources with the knowledge of liberal arts, specialized subjects, professional skills, and the ability of solving problems.

Chiba University has 10 faculties with about 11,000 students and 13 graduate schools with about 3,500 students. Chiba University has about 500 partner institution agreements in 54 countries, conducting about 260 international joint research projects in 49 countries, and accepting about 1,700 international students annually.

Chiba University has campuses in 4 locations within Chiba Prefecture. Nishi Chiba Campus, Inohana Campus, Matsudo Campus, and Kashiwa-no-ha Campus. Nishi-Chiba Campus is our main campus, and it is surrounded by rich greenery. The 6 undergraduate schools of Liberal Arts and Sciences, Letters, Law, Politics, and Economics, Education, Science, Engineering, and corresponding graduate schools and facilities are located at Nishi-Chiba Campus. Also is our main library the Academic Link Center where students have the ideal environment for self-study.

Chiba University is constantly developing education and research programs, expanding various international activities all over the world, aiming to become a world class university.

**Address** 1-33, Yayoi-cho, Inage-ku, Chiba-shi, Chiba, 263-8522 Japan

**Phone** +81-43-290-2043

**e-mail** [bfk2043@office.chiba-u.jp](mailto:bfk2043@office.chiba-u.jp)

**website** <http://www.chiba-u.ac.jp/e>

## Niigata University

---

Niigata University (NU) is a large-scale, comprehensive university blessed with an abundance of nature offering the ideal environment for students and researchers with a student body of approximately 12,400 students and 3,000 academic and administrative staff members. Across our two campuses, we have 10 faculties, 5 graduate schools, one university hospital and two affiliated institutes that facilitate and engage in groundbreaking research; the Brain Research Institute, the Research Institute for National Hazard and Disaster Recovery. We offer courses in essentially all academic disciplines including humanities and social sciences, natural sciences, medical and dental sciences at both undergraduate and graduate levels.

As NU has been dedicating to strive to bring global perspective to all its programs and activities, we have promoted collaborative research and education with overseas institutions. In particular, NU places strong emphasis on cooperation especially with East Asia. As the university is located in Niigata City facing the Sea of Japan, one of our missions is to become the East Asia's center of excellence in education and research serving to find solutions to challenges East Asia is facing.

Based in East Asia while looking out towards the world, NU has also been exploring the possibilities of promoting cooperation in Europe including UK, with whom we have a quite long history of partnership, with a view to enhancing the quality of education and research as well as our presence in the world.

NU will continue to engage in more diverse international collaboration to become one of the leading institutions highly regarded all over Japan and the world.

**Address** 8050 Ikarashi 2-no-cho, Nishi-ku, Niigata 950-2181, JAPAN

**Phone** +81-25-262-7628

**e-mail** kokusai@adm.niigata-u.ac.jp

**website** <https://www.niigata-u.ac.jp/en/>

## Kanazawa University

---

Kanazawa University originated in 1862 as a smallpox vaccination center, and became a university in 1949. It aims to be "a research university dedicated to education, while opening up its doors to both local and global society," and strives to contribute to 1) opening up a new 21st century era, and 2) promoting world peace and the continuous development of mankind.

The university offers highly versatile undergraduate program through 17 Schools. Also, there are 7 graduate schools and 1 united graduate school. The university also takes pride in the most advanced research as one of the leaders in the globalization of Japanese universities. In 2014, MEXT selected Kanazawa University for the 'Top Global University Project.' In 2016, we opted to be among the "Excellent Global Universities" category financed by the Japanese government. In 2017, we were selected for the "World Premier International Research Center Initiative (WPI)" by MEXT. As of August 2018, Kanazawa University has over 180 institutional-level and 70 departmental-level partners. It actively exchanges students and researchers with partner universities, including double-degree and twinning programs and graduate programs especially modeled for government-sponsored students from Indonesia and Vietnam. The university strongly promotes student exchanges with partners in Russia, China, Thailand, etc. Research collaborations include the environmental measurement in the Angkor ruins, cultural resource studies of the Mayan civilization, research on chronic health conditions caused by dioxin exposure in Vietnam, and more.

**Address** Kakuma-machi, Kanazawa, Ishikawa 920-1192 JAPAN

**Phone** +81-76-264-5235

**e-mail** kokukou@adm.kanazawa-u.ac.jp

**website** <https://www.kanazawa-u.ac.jp/>

## Shizuoka University

Shizuoka University is one of the leading national universities, located at the foot of Mount Fuji, the symbol of Japan. Established in 1949, Shizuoka University has its philosophy "Freedom and Enlightenment" and "Creation of the Future", inheriting the spirits of freedom from the predecessor colleges and schools. We aim to be a university with an active presence promoting high-quality education and creative research that collaborates and grows together with society.

Our educational goal is to prepare good citizens who will take leadership roles, drawing on international perspectives, to solve problems in an increasingly global society. With the core educational requirements as a solid foundation, we expect our students to develop specialist expertise and broad cultural understanding. Shizuoka University accepts both domestic and international students who :

1. have a great appetite for knowledge and approach new tasks without hesitating.
2. possess communicative ability, and respect differences, both in culture and in individual mentality.
3. are open minded and have unique ideas.
4. have a curious mind with regard to nature, society and culture.

There are 9,000 students in 6 faculties, and 1,600 students in 5 graduate schools in Shizuoka University. Shizuoka University devotes a large effort toward international exchange. At present, some 430 international students from 34 countries (including UK), both graduate and undergraduate, are studying and are engaged in research. Shizuoka University promotes productive relationships with sister universities actively.

Under the philosophy of "Freedom and Enlightenment & Creation of the Future", our university recognizes diverse backgrounds and values, forms well-rounded characters full of a noble sense of mission and spirit of inquiry, promotes the discovery, passing down and utilization of knowledge, and develops along with society in the name of peace, the well-being of mankind, and the future of the Earth.

**Address** 836 Ohya, Suruga-ku, Shizuoka-Shi, Shizuoka 422-8529, JAPAN

**Phone** +81-54-237-1111

**e-mail** ryugaku@adb.shizuoka.ac.jp

**website** <http://www.shizuoka.ac.jp/english/>

## Toyohashi University of Technology

The mission of Toyohashi University of Technology (TUT) is to conduct research and education in technological science, developing new technologies through scientific inquiry.

Based on this mission, TUT targets new graduates from technical colleges and high schools for enrollment, and with its graduate school emphasis, TUT conducts research in technological science, fostering practical, creative, and leading engineers and researchers as it forges a path toward a new era.

A major feature of TUT's education is its "spiral-up curriculum". In this curriculum, students who received specific technical instruction (basic and specialized) in their first and second years of undergraduate education and technical college will repeat the subjects from their third year with more advanced approaches in order to accumulate further competence in their basic and specialized education, creating a spiral-like education.

In their fourth undergraduate year (before advancing to graduate school), students will undertake long-term internships in the business sector, and through their experiences in dealing with problems as a working engineer, they will come to understand the meaning of their education, and how the master's program is meant to create practical, creative, and innovative engineers. In this way, TUT is able to nurture students who understand science and have a deep interest in technology due to their repetition of basic and specialized education and their practical training in the work place.

As a globally focused university, TUT sends Japanese students abroad, accepts international students, and promotes joint international research and personnel exchanges through collaborations with its overseas education base established in Penang State, Malaysia and other affiliated exchange schools. These activities are mainly centered on the area of Southeast Asia.

**Address** 1-1 Hibarigaoka, Tempaku-cho, Toyohashi, Aichi, 441-8580 JAPAN

**Phone** +81-532-44-6573

**e-mail** kouryu@office.tut.ac.jp

**website** <https://www.tut.ac.jp/english/index.html>

## Kyoto University

---

Kyoto University is dedicated to promoting advanced and creative research in diverse disciplines, and pursuing its mission to contribute to harmonious coexistence among the world's human and ecological community. The quality of the university's research is reflected in the accolades conferred on its faculty and alumni, including nine Nobel laureates, two Field Medalists, a Gauss Prize-winner, and the recipients of many other prestigious international awards.

Under the Japan Gateway: Kyoto University Top Global Program, the university is currently offering a range of international joint education programs, called Super Global Courses, in which the core curricula are provided jointly with highly respected international partner institutions, as well as joint and double degree programs. These courses focus on fields in which Kyoto University is particularly internationally competitive, such as mathematics, chemistry and chemical engineering, human biosciences, social sciences and the humanities, environmental studies and public health.

In 2016, the university established the Kyoto University Institute for Advanced Study (KUIAS) to pursue cutting-edge research, foster the next generation of leading researchers, and concentrate the collective knowledge of distinguished researchers from Japan and around the world.

In 2017, the university was appointed as a Designated National University (DNU) by the Japanese government. DNU status will enable the university to advance new initiatives for knowledge creation, innovation, and social contribution, serving as a model for higher education institutions in Japan, while continuing its efforts to address the complex issues facing global society.

**Address** Yoshida-honmachi, Sakyo-ku, Kyoto 606-8501 JAPAN

**Phone** +81-75-753-7531

**e-mail** ku-info@mail2.adm.kyoto-u.ac.jp

**website** <https://www.kyoto-u.ac.jp/en/>

## Kyoto Institute of Technology

---

Location is vital to the design, science and engineering programs at Kyoto Institute of Technology. We were established over 100 years ago in the thousand-year capital of Kyoto. Historically, Kyoto led numerous developments in Japanese culture and the production and refinement of traditional craft. Today, it is home to novel technological innovation. At KIT, we benefit from this heritage as we innovate for positive social and environmental change by being acutely attuned to feedback. We consistently verify the influences and consequences of the technology and products we create and develop to improve people's lives.

This is particularly true of three of our leading innovative areas of expertise: Kyoto Design Lab, the Polymer and Fiber Science Lab, and the Green Innovation Center. These initiatives bring world-renowned researchers to KIT broadening our students' vision of what is possible, improving their communication skills, and developing their intercultural understanding. We are on the verge of improving energy supply efficiency, elucidating disease mechanisms, re-purposing traditional buildings, and much more.

In addition to focusing on what we can do for our students, we set an example for other universities of how labs can establish international workshops, conduct collaborative research and establish active networks. We are enabled in this through the decade of annual Top Global University Project funding we were awarded in 2014. We now accept more international students and researchers, send more domestic students abroad, and initiate more internships every year. KIT has established a unique academic environment that fosters aesthetic awareness, technological skill and experience-based wisdom.

**Address** Matsugasaki, Sakyo-ku, Kyoto 606-8585 JAPAN

**Phone** +81-75-724-7129

**e-mail** kokusai@jim.kit.ac.jp

**website** <https://www.kit.ac.jp/en/>

## Osaka University

---

Osaka University was founded in 1931 as one of the seven imperial universities of Japan and now has expanded to one of Japan's leading comprehensive universities with the population of 23,304 students, and 3,541 academic staff and 3,113 non-academic staff members. The University has now embarked on open research revolution set out in a vision of openness for 2021 from a position as Japan's most innovative university and among the most innovative institutions in the world according to Reuters 2015 Top 100 Innovative Universities and the Nature Index Innovation 2017. The university's ability to innovate from the stage of fundamental research through the creation of useful technology with economic impact stems from its broad disciplinary spectrum.

With the motto "Live Locally, Grow Globally", as is characteristic of the city and people of Osaka, we strive to make our education, research and community more open and inviting, and ensure that our three campuses are places where outstanding students and researchers from around the world can gather, learn, discover, and collaborate. Since the merger with the Osaka University of Foreign Studies in 2007, Osaka University has enhanced its capacity in the studies of language and culture, and we are intensifying efforts to enhance degree programs conducted in English and Japanese language support for international students and faculty. The university has also actively expanded its global outreach by setting up Overseas Centers in San Francisco, Groningen, Bangkok and Shanghai.

**Address** 1-1 Yamadaoka, Suita-shi, Osaka Japan 565-0871

**Phone** +81-6-6879-7037

**e-mail** kokusai-koryu-kikaku@office.osaka-u.ac.jp

**website** <https://www.osaka-u.ac.jp/en>

## Kobe University

---

Formally established in 1949, Kobe University is a national university based in western Japan. Its roots date back further, to 1902, when it was originally known as Kobe Higher Commercial School. Today, Kobe University is made up of 10 faculties, 15 graduate schools, one institute and many centers covering these disciplines. As one of the most comprehensive universities in Japan, with departments covering the humanities, social, natural, and biomedical sciences, Kobe University promotes innovative research and education in collaboration with other universities, research institutes, and industry in Japan and abroad.

We have University-wide and Faculty-specific links with 351 partner institutions in 63 countries/regions worldwide including 15 partners in the U.K. To increase international student mobility, we aim to have an intake of 2,000 international students and 1,200 outgoing students every year and established more English-taught courses. We also initiate establishment of international programmes such as double-degree and Cotutelle programmes.

Kobe University has been a pioneer in developing cooperation between Japan and Europe. Kobe was the first Jean Monnet Centre of Excellence in Japan in 2015. It has been actively participating in the Erasmus+ programme and in FP7. Since its opening in 2010 Kobe University Brussels European Office has been promoting high-level dialogue between EU and Japanese researchers and policy makers. In 2018 we established a new overseas office, in Cluj-Napoca, Romania. Using these bases alongside other initiatives, we continue to take dynamic approaches to serve as a hub connecting overseas institutions, corporations, and public organizations based in Kobe and abroad.

**Address** 1-1 Rokkodai-cho, Nada-ku, Kobe 657-8501, JAPAN

**Phone** +81-78-803-5282

**e-mail** intl-relations@office.kobe-u.ac.jp

**website** <http://www.kobe-u.ac.jp/en/index.html>

## Hiroshima University

A successor with the history and tradition of various pre-war educational institutions originating in Hiroshima, including Hakushima School founded in 1874, Hiroshima University was reorganized into its present form under the National School Establishment Law in 1949. Based on its founding principle, "a single unified university, free and pursuing peace," Hiroshima University aims "to cultivate peace-pursuing, cultured individuals with an international mindset and a challenging spirit." Now Hiroshima University has 12 faculties and 11 graduate schools, and around 15,000 students. Recently, Hiroshima University has been selected as one of the institutions designated under MEXT's "The Program for Promoting the Enhancement of Research Universities." In addition, it has also been selected as one of the 13 Type A (Top Type) universities (including the University of Tokyo and Keio University) under the FY2014 Top Global University Project, providing world-class research and education. In April 2018, the School of Informatics and Data Science, and Department of Integrated Global Studies at the School of Integrated Arts and Sciences have been launched. We are committed to actively promote reforms in education and research to go global.

- As of 1st April 2018, 664 exchange agreements with overseas institutions (18 UK institutions).

- As of 1st May 2018, 1,660 international students from 73 countries or regions are studying at the University.

**Address** 1-3-2 Kagamiyama, Higashi-Hiroshima, Hiroshima, Japan

**Phone** +81-82-424-6045

**e-mail** kokusai-group@office.hiroshima-u.ac.jp

**website** <http://www.hiroshima-u.ac.jp/index.html>

## Yamaguchi University

Yamaguchi University traces its origins back to Yamaguchi Kodo, a private school, founded by Ueda Hoyo, a feudal clansman of Choshu Province in the late Edo Period (1815). Throughout the years the university has expanded into a comprehensive university which boasts nine faculties and nine graduate schools. Most recently, the university launched the Faculty of Global and Science Studies in April 2015.

In order to keep up with increasing globalization in the world, evidenced by deepening economic interdependence internationally, rapidly developing information and communications technology, and increases in foreign travelers and residents, Yamaguchi University is now turning its efforts toward fostering globally competent human resources who understand global contexts and can adapt to different values and environments. Looking both to accept as many international students as possible and to provide our Japanese students an opportunity to study abroad and experience different cultures, the university boasts a variety of programs that cultivate global competence. These programs are supported by 153 overseas partner universities and institutions in 36 countries and region, 6 overseas offices, and 7 double degree programs as of April 1, 2018.

The year 2015 marked the 200th anniversary of the establishment of Yamaguchi Kodo. As we continue into the future, Yamaguchi University will strive to carry on the legacy of our predecessors for another 200 years and take the university to even greater heights.

**Address** 1677-1 Yoshida, Yamaguchi City, Yamaguchi, 753-8511, Japan

**Phone** +81-83-933-5027

**e-mail** sh031@yamaguchi-u.ac.jp

**website** <http://www.yamaguchi-u.ac.jp/english.html>

## Kyushu University

---

Founded in 1911, Kyushu University is a leading research-oriented institute of higher education in Fukuoka, Japan. With enrollment of 20,000 students, it is comprised of 12 undergraduate schools, 18 graduate schools, 17 faculties, five research institutes, and University hospital, as well as over 50 affiliated research centers. The international student population is about 2300, representing over 90 countries. The University has 11 overseas offices including London Office in the UK. Kyushu University hosted the 2nd Japan-UK Higher Education Symposium in November 2010, where the first concrete step in the establishment of a new UK-Japan partnership platform took place, leading to the successful launch of the new scheme “RENKEI ~Japan-UK Research and Education Network for Knowledge Economy Initiatives~” in March 2012. The University is held in high regard particularly for its innovative research on organic materials and devices as well as new energy technologies, including hydrogen energy, clean coal technologies, nuclear fusion, and wind turbine technology. In May 2018, RSE/JSPS Symposium: Organic Optoelectronics: Lighting Up the Future was co-chaired by Professor Chihaya Adachi, Centre for Organic Photonics and Electronics Research, Kyushu University and Professor Ifor Samuel FRSE, School of Physics and Astronomy, University of St Andrews. Kyushu's new campus with state-of-the-art facility is designed for the development of science-driven technological solutions to realize a sustainable and environmentally-friendly society. Our relocation to the new flagship campus has just been completed this fall. Kyushu University is one of the 13 venues for “Top Global University Project” funded by the Japanese government.

**Address** 744 Motooka, Nishi-ku, Fukuoka, 819-0395

**Phone** +81-92-802-2217

**e-mail** intlsts@jimukyushu-u.ac.jp

**website** <https://www.kyushu-u.ac.jp/en/>

## Keele University

---

Keele has the UK's largest campus and is situated in the heart of the country approximately equidistant between Manchester and Birmingham. Keele is a "dual intensive" university, being strong in research and education. Keele was placed 1<sup>st</sup> in England in the National Student Survey in 2018, holds a TEF Gold award and 97% of its research is world leading or of international importance. Keele was founded in 1949 with a commitment to meet the demands of a new kind of society, economy and world, Keele was the first new university of the 20th Century and remains true to its original mission of broad based and interdisciplinary study today. About a third of Keele's undergraduate students study dual honours and about a fifth start with the Keele Foundation Year. Although there is world leading research across the disciplines, research is focused through three interdisciplinary institutes; The Institute for Sustainable Futures. The Institute for Global Health and the Institute for Social Inclusion. One of the most exciting recent developments in the start of the Smart Energy Network Demonstrator (SEND) project, where the Keele campus has become the largest single, integrated electricity, gas and heat smart energy network demonstrator in Europe. It will also be the first facility in Europe for at-scale living laboratory research, development and demonstration of new smart energy technologies and services in partnership with business and industry.

The University is currently reviewing its strategic plan but a key priority of the Education Strategy is to expand the student community through PGT, online, degree apprenticeship, transnational education and international recruitment.

**Address** Vice-Chancellor's Office, Keele University, Staffordshire. ST5 5BG

**e-mail** h.m.osullivan@keele.ac.uk

**website** <https://www.keele.ac.uk/>

## University of Bristol

---

Bristol is one of the most popular and successful universities in the UK and was ranked within the top 5% of universities in the world in the QS World University Rankings 2019.

We attract students from all over the world, creating a rich and exciting international community. We are also lucky to be located in a vibrant, dynamic city with a reputation for creativity and sustainability. For many Bristol scholars, the city is an unending source of research opportunities and a laboratory within which to test solutions with potential global impact. For the city, our University is one of its largest employers and a major contributor to its economic, social, cultural and intellectual vibrancy.

With a choice of over 200 degree courses covering a broad range of subjects, our students engage with intellectually challenging courses that encourage independence of mind. We aim to equip our students with the knowledge and skills to succeed in their chosen career in a competitive global market.

Our ambition is to be globally renowned both for the quality of our teaching and learning environment and for the excellence and breadth of our research and scholarship – as well as for the strength of the partnerships that underpin them.

The culture within our University is highly collegial, which facilitates academic collaboration in both teaching and research. This spirit of partnership extends beyond the University: we enjoy strong links with other world-leading, research-intensive universities, industrial partners and organisations in the UK and across the world.

The priorities laid out in our current strategy are:

Educational innovation that will nurture resilient graduates who can thrive in a dynamic and rapidly changing world.

Developing the structure, content and modes of delivery of our portfolio of taught postgraduate programmes to ensure that they map to current and future market needs.

Taking our commitments to diversity and inclusivity to a new level through a number of complementary initiatives.

Building capacity in world-leading research through growth of PhD student numbers and the further development of the Bristol Doctoral College as a comprehensive resource for their support.

Establishing a limited number of Specialist Research Institutes in which Bristol has the potential to sustain world-leading research of scale.

**Address** Dr Erik Lithander PVC International & Student Recruitment University of Bristol Vice-Chancellor's Office  
Beacon House Queen's Road Bristol BS8 1QU UK

**e-mail** [pa-pvcinternational@bristol.ac.uk](mailto:pa-pvcinternational@bristol.ac.uk)

**website** <https://www.bristol.ac.uk>

## University of Glasgow

---

Founded in 1451, the University of Glasgow is the fourth oldest university in the English-speaking world. We are one of the top 100 of the world's universities and have been named Scottish University of the Year by The Times and The Sunday Times Good University Guide 2018. We are a member of the elite Russell Group of leading UK research universities and a founding member of Universitas 21.

The College of Medical, Veterinary and Life Sciences brings together internationally renowned experts and state-of-the-art facilities to improve health and quality of life for humans and animals across the globe. The College of Science and Engineering is made up of 7 academic schools: Chemistry, Computing Science, Engineering, Geographical and Earth Sciences, Mathematics and Statistics, Physics and Astronomy, Psychology and the research facility SUERC. The College of Social Sciences comprises of 5 schools: Adam Smith Business School, Education, Interdisciplinary Studies, Law and Social & Political Sciences. The College of Arts has been at the forefront of delivering world-leading teaching, learning and research in the arts and humanities since 1451.

We deliver internationally recognised research-led undergraduate and postgraduate degree programmes, (taught and research), whose development is informed by the need to develop graduates with the necessary skills and knowledge to become leaders of the future in their chosen career paths. Our diverse University community attracts students and staff from over 140 different countries.

We have established creative and vibrant partnerships with communities, colleagues and students across the world. We welcome conversations with potential partners in education, industry, commerce and government.

The following website contains further information regarding our internationalisation initiatives and opportunities:

<https://www.gla.ac.uk/explore/internationalisation/>

**Address** School of Engineering, JWS-715, University of Glasgow, University Avenue, Glasgow G12 8QQ, Scotland, United Kingdom

**e-mail** [kostas.kontis@glasgow.ac.uk](mailto:kostas.kontis@glasgow.ac.uk)

**website** <https://www.gla.ac.uk>

## University of Worcester

---

The University of Worcester is a public University in the centre of England which has earned the authority from HM Privy Council to award taught and research degrees at all levels.

Founded in 1946 as a teacher training college, the institution quickly became recognised as one of Britain's best Colleges of Education. Full University title was awarded in 2005.

Worcester is noted for its ability to combine high academic quality with an imaginative, inclusive approach. It is in the top 10 of Universities in the UK to best represent society. It is the fairest University in the UK for equal gender pay with no statistically significant gender pay gap. Notable examples of inclusion include the creation of:

The UK's first University and Public Library, which was named the best large library in the UK in 2016.

The UK's first indoor sports hall purpose designed to include the wheelchair athlete.

Both developments are much visited internationally including by representatives of the Japanese Paralympic Committee and Tokyo 2020 in the run-up to Tokyo 2020.

Research strengths include work on bi-polar disorder, dementia care and aero-biology.

Educational strengths include outstanding nursing and midwifery, first class early years and teacher education and excellent sport science and coaching.

Education and practice is highly inclusive, with work in partnership with the University leading various aspects of work in mental health nationally. Worcester is currently working with the International Paralympic Committee Academy on inclusive physical education.

The University is also known for its preparedness to stand up for academic freedom and become internationally renowned for this in October 2017.

**Address** University of Worcester Henwick Grove Worcester WR2 6AJ

**e-mail** [d.green@worc.ac.uk](mailto:d.green@worc.ac.uk)

**website** <https://www.worcester.ac.uk/>

## University of Reading

The University of Reading takes pride in being a highly diverse, international institution. The student body of over 19,000 members (11,135 undergraduate and 7,925 postgraduate respectively) includes people from over 150 countries. In addition to the Whiteknights, London Road and Henley locations in the UK, its reach extends to campuses in Malaysia, South Africa, China and elsewhere in the world. By 2020, over 20% of the student body will be based outside of the UK, making the University of Reading a truly global institution.

In terms of academic diversity, the University is a broad-ranging institution with teaching and research across a wide array of subjects including the humanities, social sciences and sciences. Particular excellence has been achieved in Agriculture (QS 6<sup>th</sup> in the world 2018), Food Sciences, Archaeology and Climate Sciences. Additionally, the University is home to the internationally acclaimed Henley Business School.

Global Engagement is the University's core underpinning strategy. It envisages further growth in the University's geographical footprint through off-shore education, international partnerships and joint research and programme delivery. By 2020, the University aims for 20% of its UK-based undergraduate students to have undertaken a period of study abroad by the time they graduate.

**Address** Vice-Chancellor's Office Whiteknights' House PO Box 217 Reading RG6 6AH UK

**e-mail** v.raimo@reading.ac.uk

**website** <https://www.reading.ac.uk/>

## University of Brighton

The University of Brighton's mission is to realise potential and shape futures through high-quality, practice-based learning, teaching, research and enterprise.

With over 21,000 students and 2,800 staff living, working and learning across five campuses, the University is a vibrant and dynamic multi-disciplinary institution.

Its twelve academic Schools cover disciplines ranging from Art, Media and Humanities, to Social Sciences, Education and Physical and Biomedical Sciences. The University also jointly runs the Brighton and Sussex Medical School in partnership with the University of Sussex.

The University's values of inclusivity, sustainability, creativity and partnership inform all of its activities – including its focus on creating knowledge through practice. Building on its strong community heritage, the University looks beyond its walls to actively engage in partnerships that enrich and embolden its teaching and research.

The University's research seeks to break boundaries, bringing together diverse disciplines, international partners and individuals from academia, industry and beyond. As a locally-embedded, globally-influential university, it seeks to make a tangible difference through collective curiosity and extensive collaborations. In the last Research Excellence Framework (REF2014) university of Brighton was ranked 27 in terms of the impact of its research.

Through its centres of excellence in research and enterprise <https://www.brighton.ac.uk/research-and-enterprise/cores/index.aspx>, the University seeks to tackle today's most pressing challenges through collaborative research and enterprise, generating new insights and practical solutions to improve lives and transform the way we live.

**Address** Vice Chancellor's Office, Room 802, Cockcroft Building, Lewes Road, Brighton, BN2 4GJ, United Kingdom.

**e-mail** Tara.Dean@brighton.ac.uk and F.Marquet@brighton.ac.uk

**website** <https://www.brighton.ac.uk/index.aspx>

## University of Leicester

The University of Leicester is one of the world's leading research-intensive universities. We aim above all for excellence. Already one of the very best British and global universities, we enjoy an enviable record of research discoveries, a flair for teaching innovation and proven success in broadening access to higher education. We are long-established yet focused on a future that will see us pioneering a distinctive elite of research-intensive institutions, open to all who have talent.

Our plan consists of eight separate themes; 1) excellence and interdisciplinarity in research and learning are not simply espoused but delivered, 2) the synergy between research and learning is truly at the core of our activity, 3) a commitment to innovation, enterprise and partnership underpins everything that we do, 4) a student-centred approach and wider participation are fundamental commitments, not afterthoughts, 5) we do everything we can to recognise diversities, achieve equalities and enable all of our staff and our students to be people who flourish, 6) we are proud of our local impact and making a difference for our city and region, 7) a growing global presence is matched by a focus on internationalisation that expands the horizons of all of our staff and students, and 8) a welcoming and cohesive campus experience facilitates collaboration and fosters a distinctive sense of partnership between staff and students.

We have a number of different priorities for the years to come, from a new Space Park which will provide a new anchor for vital British technological industries to providing one of the most flexible higher education curriculums through our Pathways Initiative. The Leicester Life Sciences Accelerator will provide for academic-industrial collaborations in the fields of life sciences and healthcare/medicine within the first Life Science Opportunity Zone in the UK at Charnwood Campus. Our priorities are grouped under the four main themes of 1) discovery-led research, 2) discovery-led learning, 3) discovery-enabling culture, and 4) discovery-enabling environment.

**Address** Cardiovascular Research Centre, Glenfield Hospital, Groby Road, Leicester LE3 9QP

**e-mail** [tsuzuki@leicester.ac.uk](mailto:tsuzuki@leicester.ac.uk)

**website** <https://www.le.ac.uk>

## London School of Hygiene and Tropical Medicine

The London School of Hygiene & Tropical Medicine is renowned for its research, postgraduate studies and continuing education in public and global health. The School has an international presence and collaborative ethos, and is uniquely placed to help shape health policy, and translate research findings into tangible impact through its research that addresses global and public health challenges. LSHTM has three academic Faculties: Epidemiology and Population Health, Infectious and Tropical Diseases and Public Health and Policy.

**Address** London School of Hygiene & Tropical Medicine Keppel Street London WC1E 7HT

**e-mail** [Sasha.shepperd@lshtm.ac.uk](mailto:Sasha.shepperd@lshtm.ac.uk)

**website** <https://www.lshtm.ac.uk/>

## University of Hull

---

The University of Hull is ambitious about its future. As one of England's longest established universities, we continue to empower people to shape society and the world around us.

### Nurturing talent

We welcome students from more than 100 different countries. One in five of our students is from outside the UK. We nurture talent to help people grow as confident individuals and achieve the careers and futures they want. Our graduates have gone on to achieve success at the top of their game – from commerce and politics to science and the arts. Our notable alumni include CEO of Sky PLC, CEO of Tesco UK, Chief Operating Officer of Walmart US, Head of Education for EMEA at Google, Chair of the Board of Directors of The Coca-Cola Company and prominent BBC TV and Radio presenter, Mark Chapman.

Our research impacts the lives of people around the world

The University of Hull hosted the 2018 British Science Festival where it showcased the University's and the Humber region's most significant science contributions. Some examples include:

- Working closely with the NHS and global businesses such as Smith & Nephew to advance patient care.
- Understanding fundamental environmental processes and risks to help tackle issues surrounding climate change, marine pollution and ocean plastics.
- Leading an unprecedented coalition of partners that includes, Siemens Gamesa, Ørsted and the National Oceanography Centre, collaborating to sustain the UK as a global leader in offshore wind.
- Life-changing research into historic and contemporary slavery that has received royal recognition. We played a major role in shaping the UK Government's 2015 Modern Slavery Act.

We continue to invest in our teaching and research facilities

The University's campus is undergoing a £300-million programme of investment, designed to enhance student experience, teaching and research facilities.

This includes our £28-million health campus opened last year by HM The Queen, a world-class concert and performance venue that opened ahead of Hull's reign as the UK City of Culture 2017 and a £16-million investment to enhance our sports facilities.

**Address** University of Hull Hull HU6 7RX, UK

**e-mail** [g.a.davidson@hull.ac.uk](mailto:g.a.davidson@hull.ac.uk)

**website** <https://www.hull.ac.uk>

UK Side				
No.	Title	Name	Position	Institution
1	Prof.	Helen O'Sullivan	Pro Vice Chancellor (Education)	Keele University
2	Dr.	Erik Lithander	Pro Vice Chancellor (International)	University of Bristol
3	Prof.	Konstantinos Kontis	Dean, Global Engagement – East Asia & China	University of Glasgow
4	Prof.	David Green	Vice Chancellor	University of Worcester
5	Prof.	Vincenzo Raimo	Pro Vice Chancellor (Global Engagement)	University of Reading
6	Prof.	Taraneh Dean	Pro Vice Chancellor (Research and Enterprise)	University of Brighton
7	Prof.	Toru Suzuki	Professor of Cardiovascular Medicine	University of Leicester
8	Prof.	Sasha Shepperd	Pro Director, Learning, Teaching and Enhancement	London School of Hygiene and Tropical Medicine
9	Dr.	Giles Davidson	Strategic Partnerships Manager	University of Hull
10	Ms.	Vivienne Stern	Director	UUK International
11	Dr.	Nick Mithen	Policy Officer, Asia	UUK International
12	Ms.	Sue Kinoshita	Minister Counsellor, Economic Affairs	British Embassy
13	Mr.	Griff Jones	Head of Section and First Secretary, Science, Innovation and Global Challenges	British Embassy
14	Ms.	Diane Lloyd	First Secretary, Science, Innovation and Global Challenges	British Embassy
15	Ms.	Seiko Oya	Project Officer, Science, Innovation and Global Challenges	British Embassy
16	Ms.	Chika Takahashi	Head of Education	British Council
17	Ms.	Ayako Towatari	Programme Manager, Education	British Council

Japanese Side					
No.	Title	Name	Affiliation	Position	Institution
1	Prof.	So Kawanobe	Institute for International Collaboration	Deputy Executive Director	Hokkaido University
2	Mr.	Yukiyoshi Saito	Division of International Relations	Director	Hokkaido University
3	Dr.	Akira Iwabuchi	—	President	Iwate University
4	Prof.	Toshiya Ueki	—	Executive Vice President	Tohoku University
5	Dr.	Masahiro Yamaguchi	—	Vice President	Tohoku University
6	Mr.	Yasushi Wagatsuma	International Exchange Division	Director	Tohoku University
7	Dr.	Masashi Haneda	—	Executive Vice President	The University of Tokyo
8	Dr.	Kazuya Masu	—	President	Tokyo Institute of Technology
9	Ms.	Noriko Suzuki	International Affairs Department	Director	Tokyo Institute of Technology
10	Dr.	Kyosuke Nagata	—	President	University of Tsukuba
11	Dr.	Benton Caroline F.	—	Vice President and Executive Director for Global Affairs	University of Tsukuba
12	Dr.	Kazuyuki Hiratsuka	Faculty of Environment and Information Sciences	Advisor to the President	Yokohama National University
13	Dr.	Makoto Watanabe	—	Vice President	Chiba University
14	Dr.	Sugata Takahashi	—	President	Niigata University
15	Ms.	Eiko Goto	International Office	International Affairs Coordinator	Niigata University
16	Dr.	Koetsu Yamazaki	—	President	Kanazawa University
17	Dr.	Mariko Saiki	Organization of Global Affairs	Advisor to the President	Kanazawa University
18	Prof.	Kiyoshi Ishii	—	President	Shizuoka University
19	Prof.	Yuko Ryan	Organization for International Collaboration	Associate Professor	Shizuoka University
20	Dr.	Atsunori Matsuda	Institute for Global Network Innovation in Technology Education	Vice President for International Affairs	Toyohashi University of Technology

Japanese Side					
No.	Title	Name	Affiliation	Position	Institution
21	Dr.	Shinsuke Kawazoe	—	Executive Vice President for Student Affairs and Library Services	Kyoto University
22	Prof.	Yukari Mitsuhashi	International Strategy Office	Vice Director	Kyoto University
23	Ms.	Rika Ogata	International Education & Student Mobility Division	Director	Kyoto University
24	Dr.	Naoto Tsutsumi	—	Trustee/ Vice President	Kyoto Institute of Technology
25	Ms.	Saori Obayashi	Center for Global Initiatives	Associate Professor	Osaka University
26	Dr.	Noriyuki Inoue	—	Executive Vice President for International Exchange	Kobe University
27	Dr.	Yasushi Maruyama	Graduate School of Education	Vice President for International Exchange	Hiroshima University
28	Dr.	Masaaki Oka	—	President	Yamaguchi University
29	Dr.	Yuichi Harada	Global Innovation Centre	Professor	Kyushu University
30	Ms.	Saori Suenaga	International Strategy Division	Liaison Officer	Kyushu University
31	Mr.	Kazuhiko Hayashi	Higher Education Policy Planning Division, Higher Education Bureau	Director for International Analysis	Ministry of Education, Culture, Sports, Science and Technology
32	Mr.	Kenji Yamamoto	—	Senior Managing Director	The Japan Association of National Universities
33	Mr.	Masato Kitani	—	Managing Director	The Japan Association of National Universities
34	Mr.	Hayashi Towatari	—	Director-General	The Japan Association of National Universities
35	Mr.	Masanori Saruwatari	—	Director-General	The Japan Association of National Universities
36	Mr.	Masao Hatori	Planning Department	Director	The Japan Association of National Universities
37	Mr.	Kenji Kakuta	—	Deputy Secretary	The Japan Association of National Universities
38	Mr.	Mitsuru Mizuno	Planning Department	Chief International Coordinator	The Japan Association of National Universities
39	Mr.	Takaaki Kobayakawa	Planning Department	International Coordinator	The Japan Association of National Universities
40	Ms.	Miku Takahashi	Planning Department	International Coordinator	The Japan Association of National Universities

## Note

---

By attending the 2018 Japan-UK Dialogue on Exchange in Higher Education & Research, participants acknowledge and authorize any photos, video or voice recordings that may be taken of them during the events, if there is no objection from the participants.

JANU and UUKi shall have full, unlimited and transferable copyright in using these images and recordings, unrestricted by territory, time or further application.

JANU and UUKi shall have the right to use, apply, duplicate, modify, publish, release or broadcast these images and recordings without any manner of compensation whatsoever due to the participants. Presentation slides must need to get approval of the creator in advance in the case of using, applying, duplicating, modifying, publishing, releasing or broadcasting.

## Organizers

### 1, The Japan Association of National Universities (JANU)

---

Founded in 1950, the Japan Association of National Universities (JANU) is the organization consisting of all the 86 national universities as regular members and the 4 inter-university research institutes as special members. The objectives of JANU are to contribute to the promotion of national university corporations and the improvement of standards of higher education and academic research in our nation with well-balanced development, creating the circumstances to ensure outstanding achievements by national university corporations on various activities related to education, research and contribution to the society.

### 2, Universities UK International (UUKi)

---

UUKi is the international arm of Universities UK, representing UK universities and acting in their collective interests globally. We actively promote universities abroad, provide trusted information for and about them; and create new opportunities for the sector.

